



**18 HEMSBY ROAD
CHESSINGTON
KT9 2DZ
£389,950**

TERRACE HOUSE

TWO BEDROOMS

14'1 X 10'2 MODERN KITCHEN DINING ROOM

MODERN BATHROOM SUITE

DOUBLE GLAZED WINDOWS

GAS CENTRAL HEATING

80' WESTERLY FACING REAR GARDEN

OFF STREET PARKING

WELL PRESENTED

NO FORWARD CHAIN

Ground Floor
27.1 sq.m. (291 sq.ft.) approx.

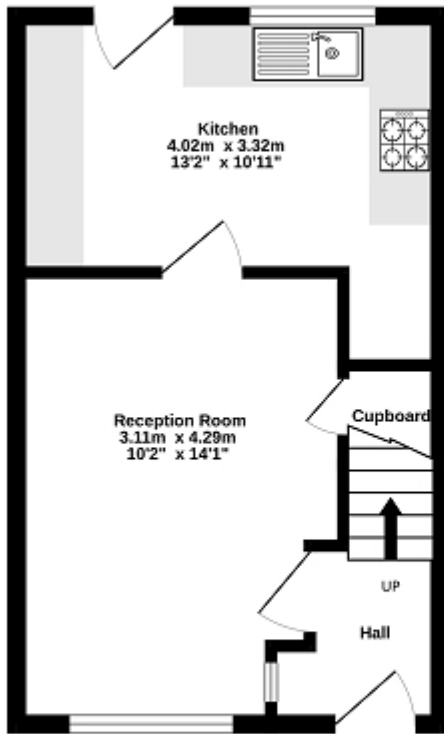

1st Floor
26.0 sq.m. (280 sq.ft.) approx.

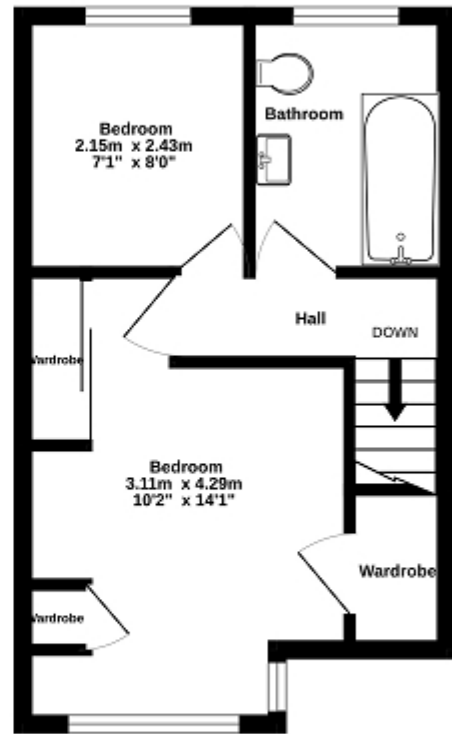

TOTAL FLOOR AREA : 53.1 sq.m. (571 sq.ft.) approx.

Whilst every attempt has been made to ensure the accuracy of the floorplan contained here, measurements of doors, windows, rooms and any other items are approximate and no responsibility is taken for any error, omission or mis-statement. This plan is for illustrative purposes only and should be used as such by any prospective purchaser. The services, systems and appliances shown have not been tested and no guarantee as to their operability or efficiency can be given.
Made with Metapix ©2025

