



Silk Cottage Townhead

Eyam, Hope Valley, S32 5RE

Price Guide £230,000



Silk Cottage Townhead



Description

GUIDE PRICE £230,000 to £240,000

A delightful, one double bedroom, detached corner cottage located in the picturesque village of Eyam. Built in 1735, this delightful property boasts a kitchen diner and family bathroom on the ground floor, with stairs leading up to a combined living area and bedroom that benefits from triple aspect and original character features. Externally, the cottage has an allocated parking space, as well as access opposite to the woodland trails. Eyam village is walkable and the property benefits from great views and transport links to local towns and villages. Offered chain free, this is not one to miss out on!

- Guide Price £230,000 to £240,000
- Original beams, triple aspect views from upstairs
- Walkable to Eyam village and trails
- Chain-free, ideal first home or weekend getaway
- Near local pubs and transport links to major towns
- Charming, one bedroom, stone built detached cottage
- Original features with contemporary furnishing
- Allocated driveway parking space
- Can be offered furnished, subject to negotiation
- Viewing highly recommended





Floor Plan

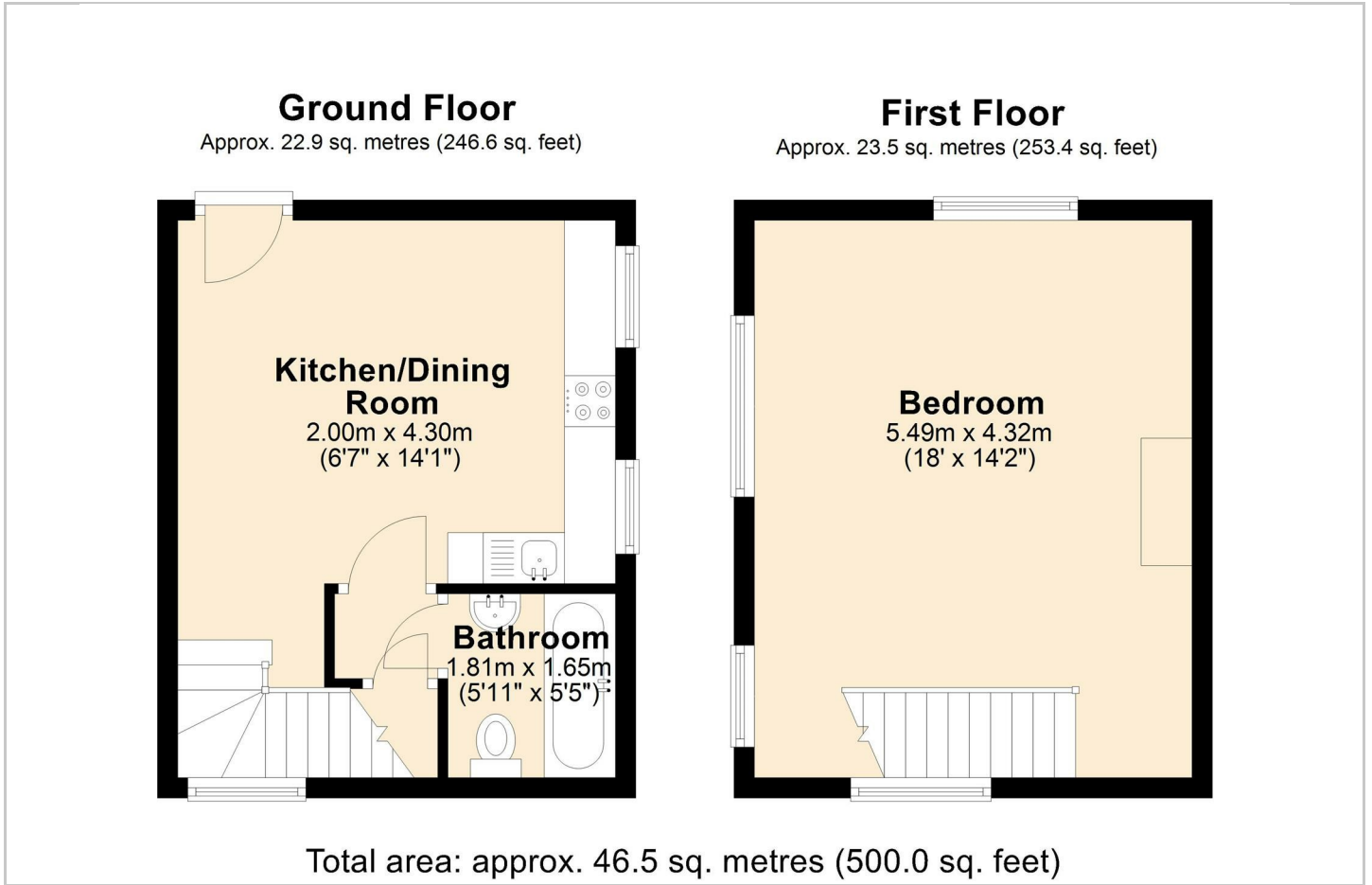

Area Map

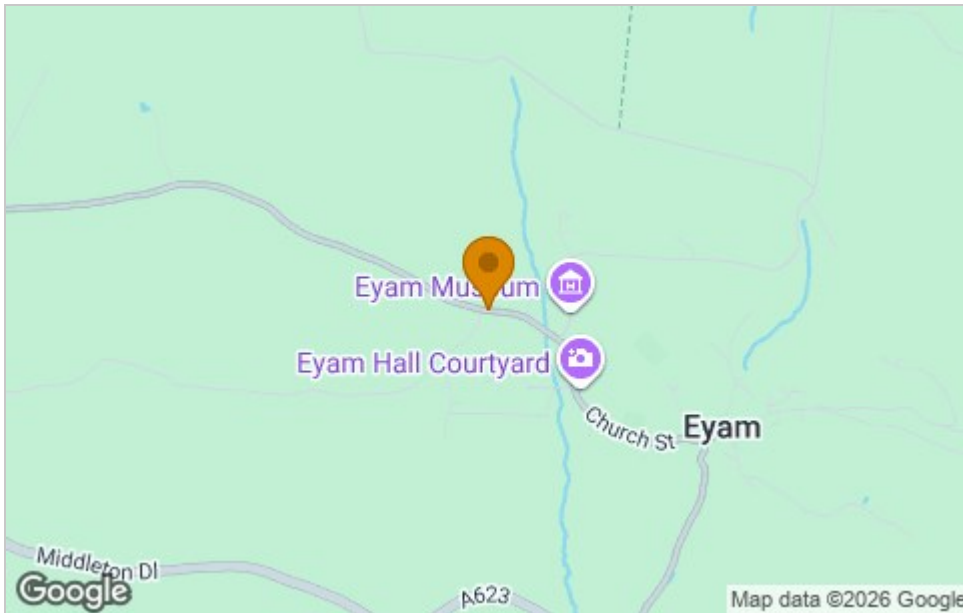

Viewing

Please contact our ELR Hathersage Office on 01433 651888 if you wish to arrange a viewing appointment for this property or require further information.

These particulars, whilst believed to be accurate are set out as a general outline only for guidance and do not constitute any part of an offer or contract. Intending purchasers should not rely on them as statements of representation of fact, but must satisfy themselves by inspection or otherwise as to their accuracy. No person in this firm's employment has the authority to make or give any representation or warranty in respect of the property.

Eadon Lockwood and Riddle Main Road, Hathersage, Hope Valley, S32 1BB
Tel: 01433 651888 Email: peakdistrict@elr.co.uk <https://www.elr.co.uk>

Energy Efficiency Graph

