



Guide Price
£175,000

2x  2x  1x 

**Kings Close, Pilgrims
Retreat, Harrietsham,
Kent, ME17**

Wards
Helping you move forwards



Main features

- Over 50's only
- Private driveway and wraparound garden
- Newly decorated throughout and air-conditioning
- On-site facilities including pool and gym
- Large kitchen attached to dining area and utility area

Accommodation

GROUND FLOOR

- Entrance Hall
- Lounge: 18'1 x 11'0 (5.52m x 3.36m)
- Dining Room: 9'5 x 8'5 (2.87m x 2.57m)
- Kitchen: 8'0 x 7'10 (2.44m x 2.39m)
- Utility Area: 8'2 x 5'2 (2.49m x 1.58m)
- Bedroom 1: 10'1 x 9'5 (3.08m x 2.87m)
- En-suite Shower Room: 9'11 x 7'6 (3.02m x 2.29m)
- Bedroom 2: 9'5 x 8'8 (2.87m x 2.64m)
- Bathroom: 9'5 x 6'6 (2.87m x 1.98m)

OUTSIDE

- Double Driveway
- Front, Rear & Side Gardens

Ground Floor
Approx. 70.8 sq. metres (761.9 sq. feet)

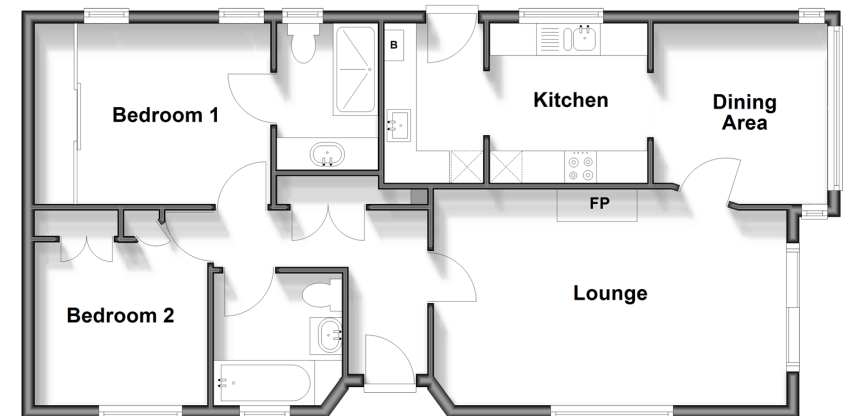

Call Bearsted - 01622 730955 ■ wardsofkent.co.uk

- If buying to let, the energy rating will need to be improved to at least 'E' rating before you can let the property
- Appliances & services are untested, dimensions are approximate and floor plans are not to scale
- Legal advice should be taken to verify fixtures/fittings, planning, alterations and/or lease details



12329167/20250924/DF/LNR