



HEARNES

WHERE SERVICE COUNTS

Laurel Close, St. Leonards, BH24 2NA

Set within an incredibly private and highly regarded cul-de-sac in St Leonards, this attractive detached bungalow offers generous, flexible accommodation and beautifully maintained gardens that wrap around the home.

The property provides four to five bedrooms, allowing you to tailor the layout to your lifestyle. The master bedroom enjoys its own en-suite shower room and dressing room, while a further family bathroom serves the remaining bedrooms. One of these rooms is currently arranged as a study/family room, giving excellent versatility for home working or additional living space.

At the heart of the home is a well-appointed kitchen, a separate dining room, and a superb triple-aspect sitting room that floods with natural light and enjoys lovely views over the gardens.

Outside, the property continues to impress with its exceptional privacy, generous lawned areas, and mature planting. A large double garage and ample driveway parking complete the picture.

Beyond the property itself, the location is peaceful, yet the vibrant market town of Ringwood and the popular centre of Ferndown are both within easy reach. For lovers of the outdoors, the breathtaking landscapes of Moors Valley Country Park are just minutes away, offering miles of walking and cycling trails, lakes, woodland, and family activities.

This is a great opportunity to secure a spacious, adaptable bungalow in a sought-after location that blends tranquillity, convenience, and outstanding natural surroundings.

Local Authority: Dorset

Council Tax Band: F

Energy Performance Certificate: Rating



**Laurel Close,
St. Leonards, BH24 2NA**
Approx. Gross Internal Area *
1718 Ft² - 159.60 M²

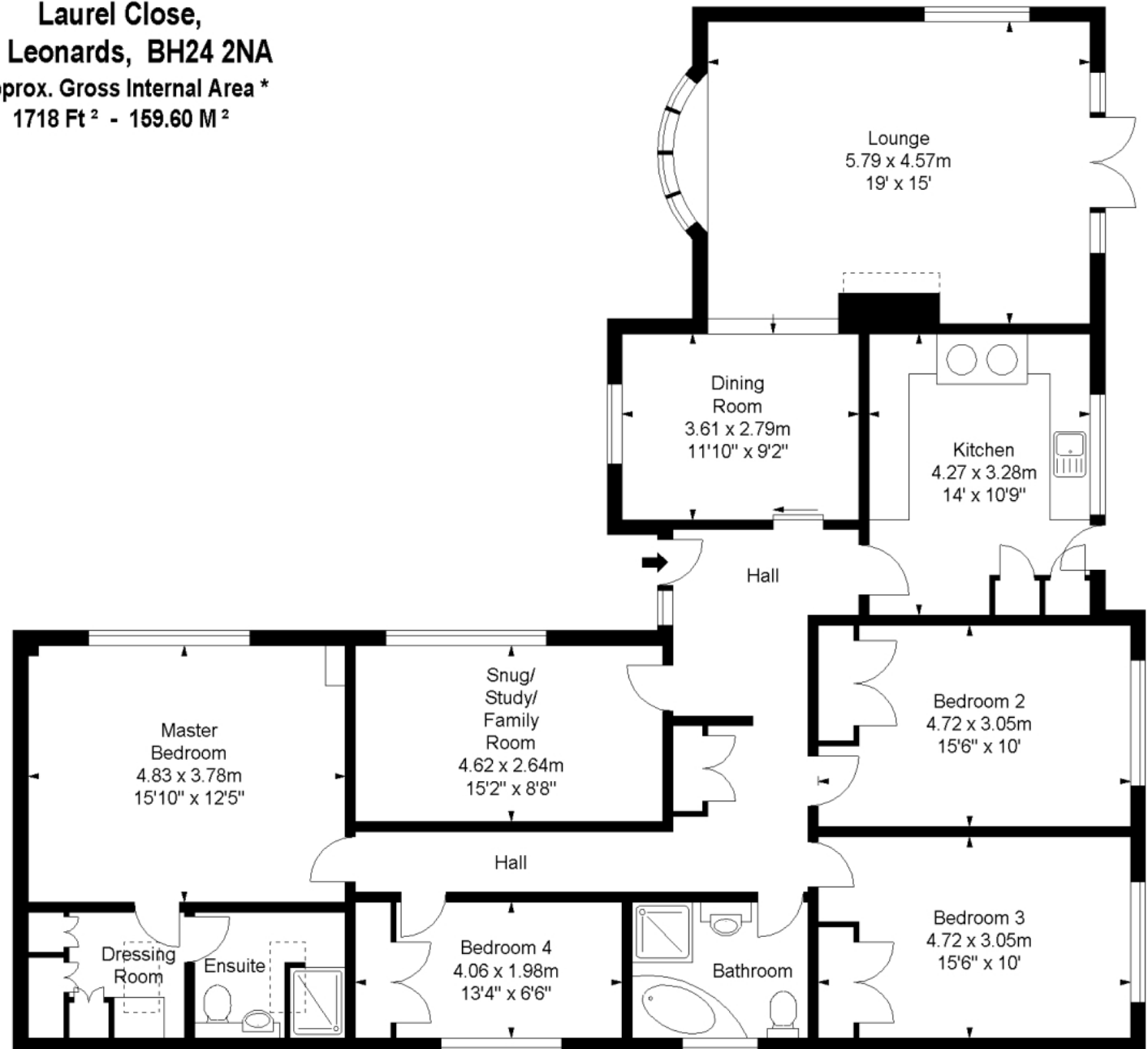
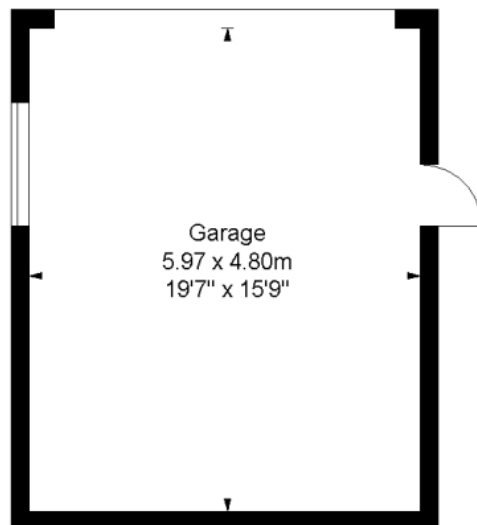
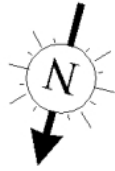

For illustrative purposes only. Not to scale

Copyright 2009 Total Property Marketing
Telephone: 0845 838 7238

