



## AIRLIE GARDENS, W8

£550,000

One Bedroom  
Wooden Floors  
High Ceilings  
Communal Garden  
Moments to Notting Hill Gate  
Share of Freehold

@marshandparsons  
marshandparsons.co.uk

MARSH &  
PARSONS



# ABOUT THE PROPERTY

A bright well presented one bedroom lower ground floor apartment in a period building, featuring high ceilings, skylit kitchen, and access to stunning private communal gardens.

Airlie Gardens is located moments from the amenities and transport links of High Street Kensington and Notting Hill Gate as well as benefitting from easy access to the A4 for the M4 and Heathrow.



# STEP INSIDE AIRLIE GARDENS

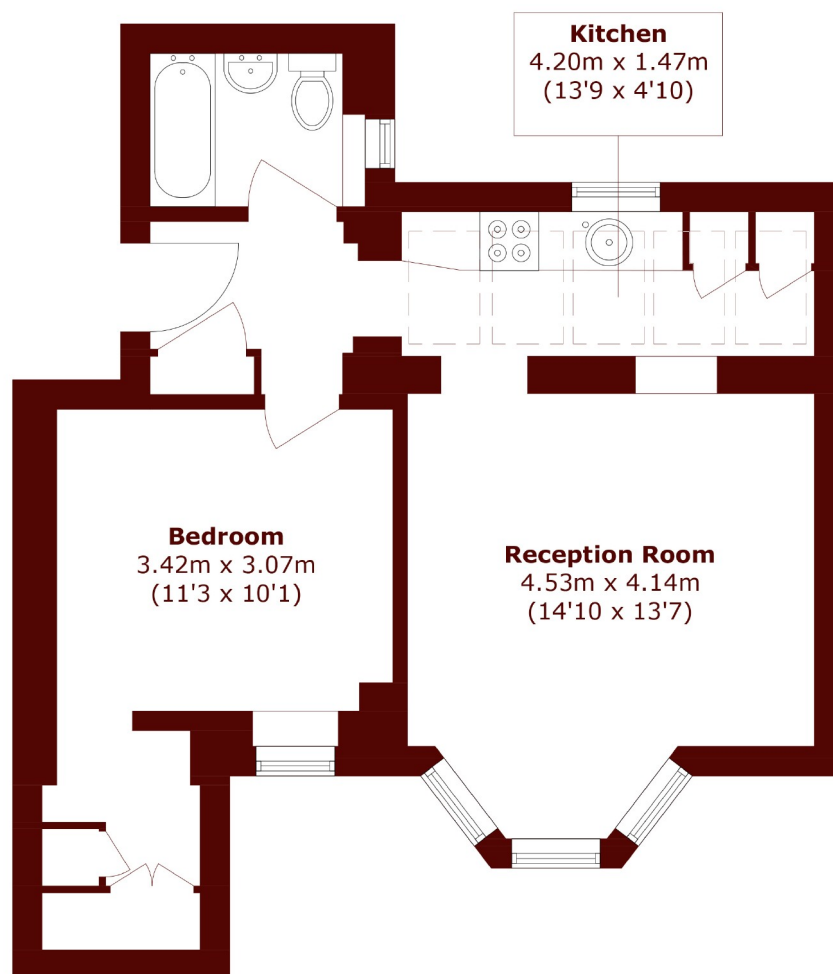

Total area (approx.): 49.0 sq. m (527.4 sq. ft)

**Kensington**  
020 7368 4450

Energy Rating: D We aim to make our particulars both accurate and reliable. However, they are not guaranteed; nor do they form part of an offer or contract. If you require clarification on any points then please contact us, especially if you're traveling some distance to view. Please note that appliances and heating systems have not been tested and therefore no warranties can be given as to their good working order

**MARSH &  
PARSONS**