

LEASEHOLD



Apartment

# HAWKS ROAD, KINGSTON UPON THAMES KT1 3DX

Asking Price

## £375,000

FEATURES



# 2 Bedroom Apartment located in Kingston Upon Thames

Situated within the sought-after residential development of Pyramid Court on Hawks Road, this well-presented two-bedroom, two-bathroom apartment offers a superb opportunity for both homeowners and investors alike.

The property comprises a bright and spacious open-plan living and dining area, ideal for both relaxing and entertaining, complemented by a well-appointed modern kitchen. The accommodation further benefits from two generously sized double bedrooms, including a principal bedroom with en-suite shower room, alongside a contemporary family bathroom.

Additional features include a well-maintained communal setting, secure entry system and resident parking, enhancing both comfort and convenience.

Perfectly positioned the property is within easy reach of excellent transport links, with Norbiton and Kingston stations nearby, providing direct access into Central London. A wide range of local amenities, including shops, restaurants, and leisure facilities, are also close at hand, as well as highly regarded schools.

Call us on

020 8546 7771

info@saxonkings.co.uk

www.saxonkings.co.uk

Council Tax Band

D

## Mid Floor

Approx. 59.1 sq. metres (636.4 sq. feet)

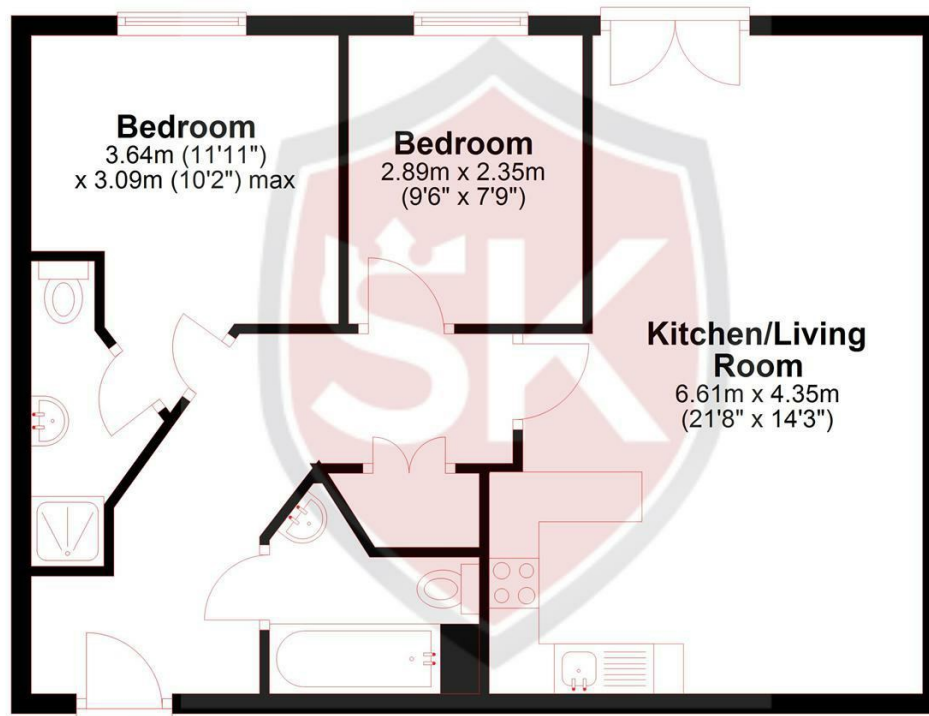

Total area: approx. 59.1 sq. metres (636.4 sq. feet)

Energy Efficiency Rating		Current	Potential
<i>Very energy efficient - lower running costs</i>			
(92 plus) A			
(81-91) B			
(69-80) C		78	78
(55-68) D			
(39-54) E			
(21-38) F			
(1-20) G			
<i>Not energy efficient - higher running costs</i>			
<b>England &amp; Wales</b>		EU Directive 2002/91/EC	

Agents Note: Whilst every care has been taken to prepare these particulars, they are for guidance purposes only. All measurements are approximate and are for general guidance purposes only and whilst every care has been taken to ensure their accuracy, they should not be relied upon and potential buyers are advised to recheck the measurements.

