



 MovingInn

| Pampisford Road | South Croydon | CR2 6DB

**Offers In Excess Of £290,000**

 **MovingInn**  
sales, lettings & management

| Pampisford Road  
 South Croydon | CR2 6DB  
 Offers In Excess Of £290,000

Luxurious 2-bedroom, 2-bathroom apartment in South Croydon. Boasting an abundance of natural light and ample storage, this property offers a convenient lifestyle within a gated development.

Introducing a luxurious and modern 2-bedroom, 2-bathroom apartment nestled in the sought-after Pampisford Road, just a stone's throw away from the vibrant heart of South Croydon. This stunning property is now available for sale - upon entering, you will be greeted by an abundance of natural light that illuminates the spacious living areas, creating a warm and inviting ambience. The apartment boasts a modern open plan kitchen with a bright and airy lounge, two good-sized double bedrooms, 2 contemporary bathrooms - one of them is an en-suite, and ample storage space, making it an ideal living space for families or professionals seeking comfort and convenience,

The convenience of private gated resident parking, as well as an impressive EPC rating of B, which



Pampisford Road, South Croydon, CR2 6DB

First Floor

Approx. Total Internal Area: 653 SQ FT / 60.7 SQ M

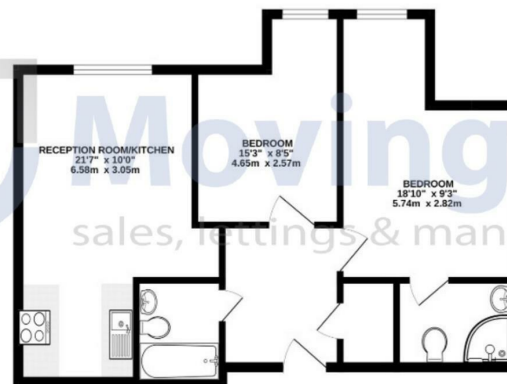

For Illustration Purposes Only - NOT TO SCALE

Energy Efficiency Rating		Current	Potential
<i>Very energy efficient - lower running costs</i>			
(92 plus) A			
(81-91) B		81	83
(69-80) C			
(55-68) D			
(39-54) E			
(21-38) F			
(1-20) G			
<i>Not energy efficient - higher running costs</i>			
<b>England &amp; Wales</b>		EU Directive 2002/91/EC	

Council Tax Band C  
 EPC Rating B

467 Norwood Road  
 West Norwood  
 London  
 SE27 9DJ  
 02087610830  
 dean@movinginn.co.uk  
 www.movinginn.co.uk

Full description