



9 Bridgefoot Quay Warwick Road, Stratford-Upon-Avon

Offers Over **£125,000**

**SHELDON
BOSLEY
KNIGHT**

LAND AND
PROPERTY
PROFESSIONALS

9 Bridgefoot Quay Warwick Road

Stratford-Upon-Avon, Stratford-Upon-Avon

Spacious two-bedroom retirement apartment in Stratford Town Centre, close to amenities. Needs updating, especially kitchen. Secure access, lift, fitted wardrobes. Offers from £125,000. Council Tax band: D

Tenure: Leasehold

EPC Energy Efficiency Rating:

EPC Environmental Impact Rating:

- Popular Town Centre Location
- Two Bedroom Apartment
- Canal Views
- Guest Suite Available
- Secure Intercom System
- Strictly Over 60's
- Share Of Freehold
- No Onward Chain





First Floor

Approx. 48.6 sq. metres (522.7 sq. feet)

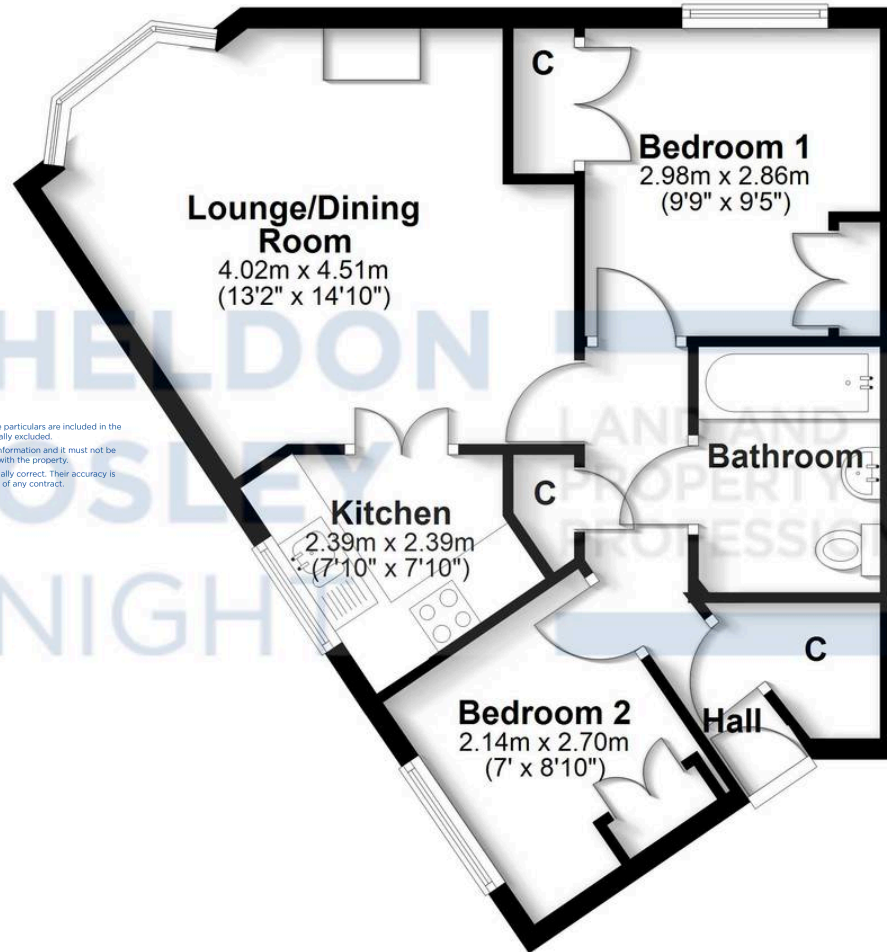

DISCLAIMER

All fixtures and fittings mentioned in these particulars are included in the sale, all others in the property are specifically excluded.
Photographs are reproduced for general information and it must not be inferred that any item is included for sale with the property.
These particulars are thought to be materially correct. Their accuracy is not guaranteed and they do not form part of any contract.

Total area: approx. 48.6 sq. metres (522.7 sq. feet)

All efforts have been made to ensure the measurements are accurate on this floor plan, however these are for guidance purposes only.

Plan produced using PlanUp.

Sheldon Bosley Knight Stratford-Upon-Avon

Sheldon Bosley Knight, 35-36 Rother Street - CV37 6LP

01789387887 · stratfordsales@sheldonbosleyknight.co.uk · www.sheldonbosleyknight.co.uk/

DISCLAIMER

All fixtures and fittings mentioned in these particulars are included in the sale, all others in the property are specifically excluded.

Photographs are reproduced for general information and it must not be inferred that any item is included for sale with the property.

These particulars are thought to be materially correct. Their accuracy is not guaranteed and they do not form part of any contract.