

These particulars are set out as a general outline for the guidance of intending purchasers or lessees and do not constitute any part of an offer or contract. No person in the employment of the above named agents has any authority to make or give any representation or warranty whatsoever in relation to this property. If there is any point which is of particular interest, please contact our office and we will be pleased to check the information. The mention of any appliances and/or services does not imply they are in full and efficient working order.

www.woodlands-estates.co.uk

To view this property please call 01737 771777



England & Wales	
EU Directive 2002/91/EC	
Very energy efficient - lower running costs	(92 plus) A
	(81-91) B
	(69-80) C
	(55-68) D
	(39-54) E
	(21-38) F
Not energy efficient - higher running costs	(1-20) G
Current	69
Potential	77

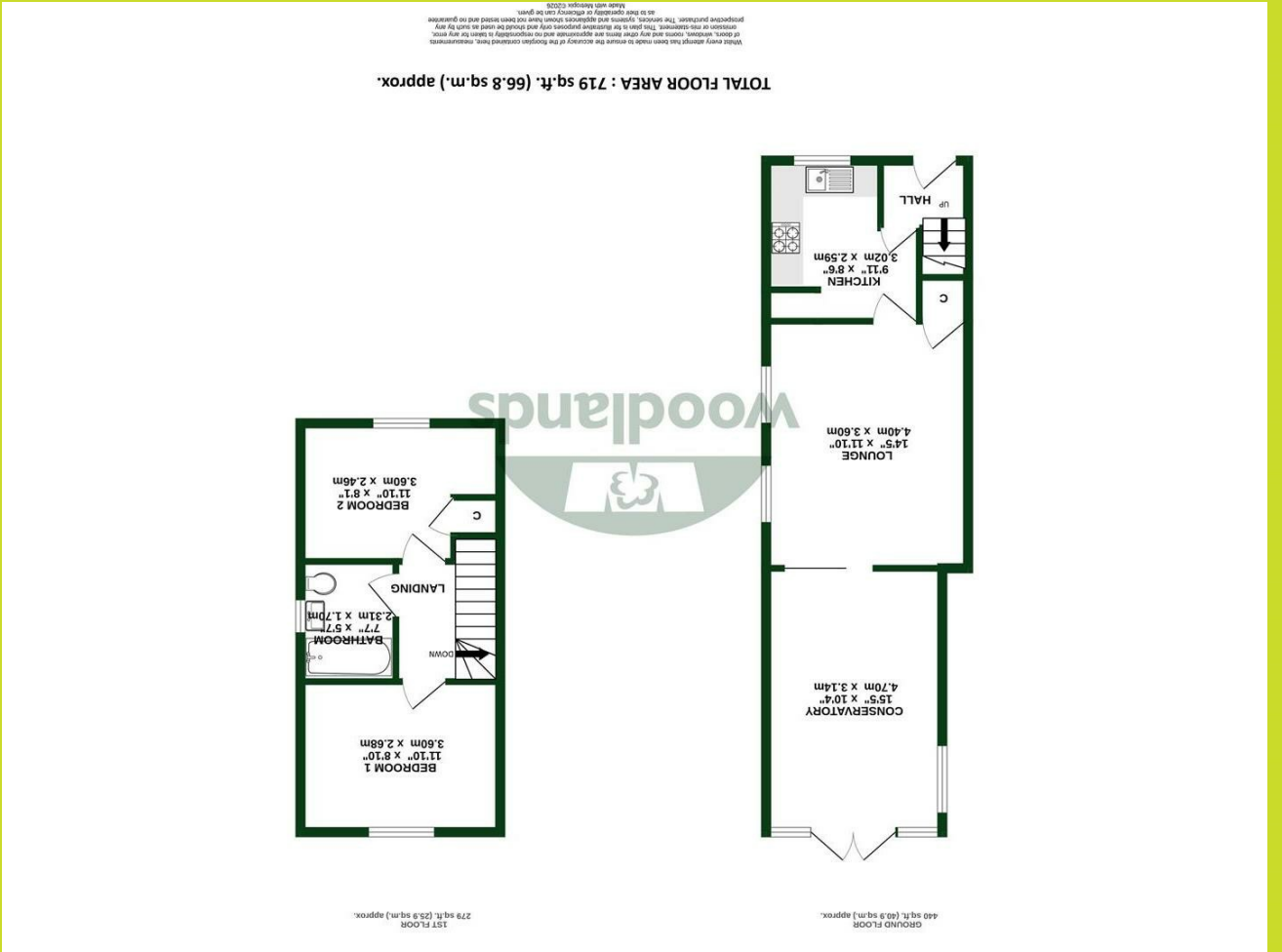

propertymark



zoopla

rightmove

onTheMarket.com

woodlands



49 Greenwood Drive, Redhill, Surrey, RH1 5PH
£359,950
Freehold

Lovely two bedroom house in a quiet location, with excellent living space, a secluded garden and garage with parking.

Located in a cul de sac just around the corner from a local shop, East Surrey Hospital and bus routes to Redhill, Reigate and Horley, this well presented terraced house would make a superb first home, and would be ideal for someone working at the hospital.

Through the front door there is a hallway which opens to a modern, fitted kitchen that has a double glazed window overlooking the front garden. Off the kitchen there is a living room with a built in cupboard under the stairs, and then you have a large conservatory, that could have a multitude of uses and offers direct access to the rear garden. Upstairs there is a landing with loft access, a well appointed bathroom, and two double bedrooms.

The rear garden is nicely secluded, with a wooded backdrop. It is mainly laid to lawn, with a decked area and mature borders. At the end of the terrace there is a single garage en-block, that has space to park in front, as well as there being communal parking nearby.

As well as the handy local shop just around the corner there is a superb array of shops within Redhill town centre, which is only a 2 miles away, and can be reached easily by bus. The town centre also has a modern, multi screen cinema complex, a weekly local market in the main square and excellent rail links to central London and Gatwick.

- EXCELLENT STARTER HOME
- LOUNGE
- LARGE CONSERVATORY
- GARAGE AND PARKING
- COUNCIL TAX BAND: C
- QUIET LOCATION
- MODERN KITCHEN
- TWO BEDROOMS
- SECLUDED GARDEN
- EPC RATING: C



ROOM DIMENSIONS:

ENTRANCE HALL
LOUNGE
14'5 x 11'10 (4.39m x 3.61m)

KITCHEN
9'11 x 8'6 (3.02m x 2.59m)

CONSERVATORY
15'5 x 10'4 (4.70m x 3.15m)

FIRST FLOOR

LANDING
BEDROOM ONE
11'10 x 8'10 (3.61m x 2.69m)

BEDROOM TWO
11'10 x 8'1 (3.61m x 2.46m)

BATHROOM
7'7 x 5'7 (2.31m x 1.70m)

- GAS CENTRAL HEATING**
- DOUBLE GLAZED WINDOWS**
- 30FT REAR GARDEN**
- GARAGE EN BLOCK**

