



73 Primrose Drive

Melksham, SN12 6GD

Guide Price £230,000

Blueleaf Property are delighted to offer this two bedroom home situated in Primrose Drive., Melksham.

The ground floor accommodation comprise entrance hall, lounge and kitchen breakfast room with patio doors onto the rear garden. The first floor accommodation comprise landing, two bedrooms both with fitted wardrobes and a bathroom with airing cupboard.

The property further benefits from driveway parking for two cars, and enclosed rear garden with patio, lawn & shed, gas central heating and upvc double glazing.

Please note photos were taken prior to current tenancy.

All room measurements are approx.;

Entrance Hall: 1.16m x 0.85m

Lounge: 3.6m x 4.73m

Kitchen Breakfast Room: 3.6m x 2.74m

Bedroom One: 3.6m x 2.74m

Bedroom Two: 3.6m x 2.21m ext 2.74m

- Two bedroom home
- Driveway parking for 2 cars
- Enclosed rear garden
- Gas central heating
- Council Tax - B (Wiltshire Council)
- EPC - D
- No chain

Viewing

Please contact our Blueleaf Property Office on 01225 839050 if you wish to arrange a viewing appointment for this property or require further information.

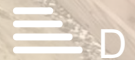

Floor Plan

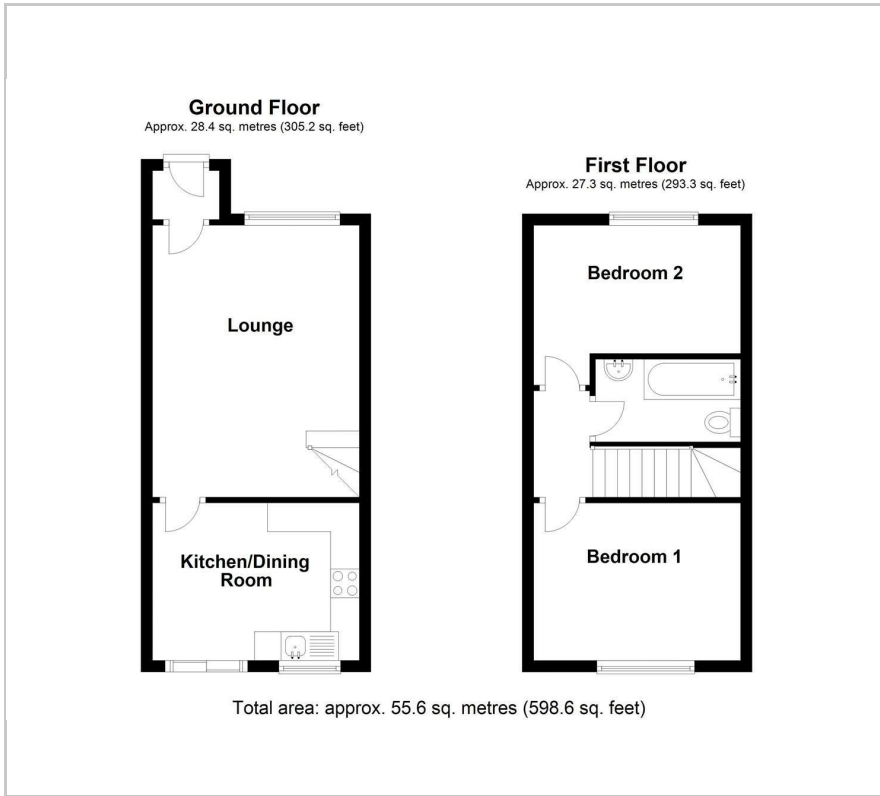

Area Map



Energy Efficiency Graph

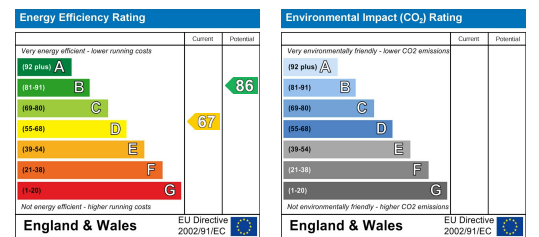

These particulars, whilst believed to be accurate are set out as a general outline only for guidance and do not constitute any part of an offer or contract. Intending purchasers should not rely on them as statements of representation of fact, but must satisfy themselves by inspection or otherwise as to their accuracy. No person in this firm's employment has the authority to make or give any representation or warranty in respect of the property.

Office 4 Stockley Farm, Stockley, Wiltshire, SN11 0NT

Tel: 01225 839050 Email: hello@blueleafproperty.co.uk <https://www.blueleafproperty.co.uk>