

# Aston & Co

ESTATE & LETTING AGENTS



97 Lutterworth Road

, Aylestone, LE2 8PL

£3,750 Per Month

Aston & Co  
*Exclusive Homes*

THE  
GUILD  
PROPERTY  
PROFESSIONALS



5



3



4



B

Available August 2026! Standing well back & screened from the road, this massively extended, five bedroom superbly renovated family residence on the highly regarded stretch of road is conveniently located for local amenities.

The property has 4 reception/living spaces, full width open plan kitchen/diner with bifold doors, a very large enclosed back garden, 5 double bedrooms, 2 en-suites and a family bathroom.

There is Off Road Parking for several vehicles, a garage space and a car port.

- Five Bedroom Detached Family Home
- Spacious open-plan kitchen with bifold doors
- Two En-suite Bedrooms, Main Bathroom Suite & Ground Floor W/C
- Separate Utility Space
- Driveway Allowing Off Road Parking For Several Cars
- Large Enclosed Landscaped Rear Garden With Patio Space
- Single garage with electric shutter and separate carport
- Close To Local Amenities and Transport Links
- EPC Rating B / Council Tax band G



## INTRODUCTION

Looking every inch like a newly built property but in reality, a massively extended, exquisitely renovated family home presented to the market with no upward chain.

With internal floor space in excess of 380 square metres and an impressive EPC rating of B, No 97 Lutterworth Road is set well back from the road with extensive parking subject to the installation of a drop kerb. (Pending)

Benefiting from Gas Central Heating and fully double glazed windows, this stunning split level residence was created very much in keeping with the newly built property next door and briefly comprises: A grand entrance hall with guest wc off, 4 reception rooms, a utility room, an office and a magnificent dining kitchen with bi-fold doors into the garden on the lower ground floor.

On the first floor there are 5 well-proportioned bedrooms, a family bathroom and 2 en-suites

## THE ACCOMMODATION

The house is entered through a modern grey composite front door into the Grand Entrance Hall with a guest wc off comprising toilet and sink with scope to add a shower cubicle if required. Doors lead off to the ground floor rooms and to the carport/storage area. One staircase leads down to the dining kitchen on the lower ground floor, and a second staircase rises to the first floor. Flexibly designed so that the reception rooms are all suitable for various uses, the first room on the right is a spacious sitting room with a large floor to ceiling window overlooking the front. To the left of the hall, the snug also has 2 floor to ceiling windows overlooking the front. The lounge is a large sitting area with a window to the side and a window looking over the lower ground floor roof and over the garden beyond.

The family room is a large, comfortable room with a window looking over the lower ground floor roof and down the rear garden beyond and with the use of black-out blinds, would make an ideal cinema room. Off the carport to the right of the house there is a garden room/office which is an ideal work from home space.

The utility room has a range of base and wall units, a stainless steel sink and drainer and space and plumbing for white goods

On the lower ground floor there is a magnificent Living/dining kitchen.. The kitchen area has been fitted with a range of modern base and wall units with quality fitted appliances including twin double ovens, a fridge and freezer, and a dishwasher. A large roof lantern providing natural light and bi-fold doors providing fantastic views of the garden and seamless access onto the patio. The kitchen is separated from the rest of the room by large central island with cupboards under and an induction hob with extractor. The remainder of the room has ample space for a large family dining suite and a comfortable seating area with 3 floor to ceiling windows overlooking the garden.

Upstairs, off the grand galleried landing there are 5 well-proportioned bedrooms, all large enough to be considered at least as double rooms with bedrooms 1 and 2 having beautifully appointed en-suite shower rooms comprising toilet, sink and walk-in shower enclosures. The accommodation is completed by a spacious family bathroom with a toilet, vanity unit with sink and a bath with glass screen and shower over.

## OUTSIDE

The gardens are a very strong feature of the property. Set well back from the road and screened from the street by a mature hedge, the frontage has been hard landscaped to provide extensive parking and has the potential to add security gates if required subject to the installation of a drop kerb which the vendors have confirmed has been applied for. Pedestrian access leads down the side of the property to the rear garden which has been designed with low maintenance in mind. A large patio area directly behind the house merges with the kitchen tiles when the bi-fold doors are open to create a perfect entertaining area. With a mature hedge down the right hand side and a newly erected fence to the left, the large lawn is well screened from the neighbouring properties with specimen trees adding to its character.

## Tenancy Information

Price : £3750.00

-Holding Deposit: £865.00

- Deposit : £4326.00 (including the holding deposit)

- Council Tax Band: G



## Floor Plan

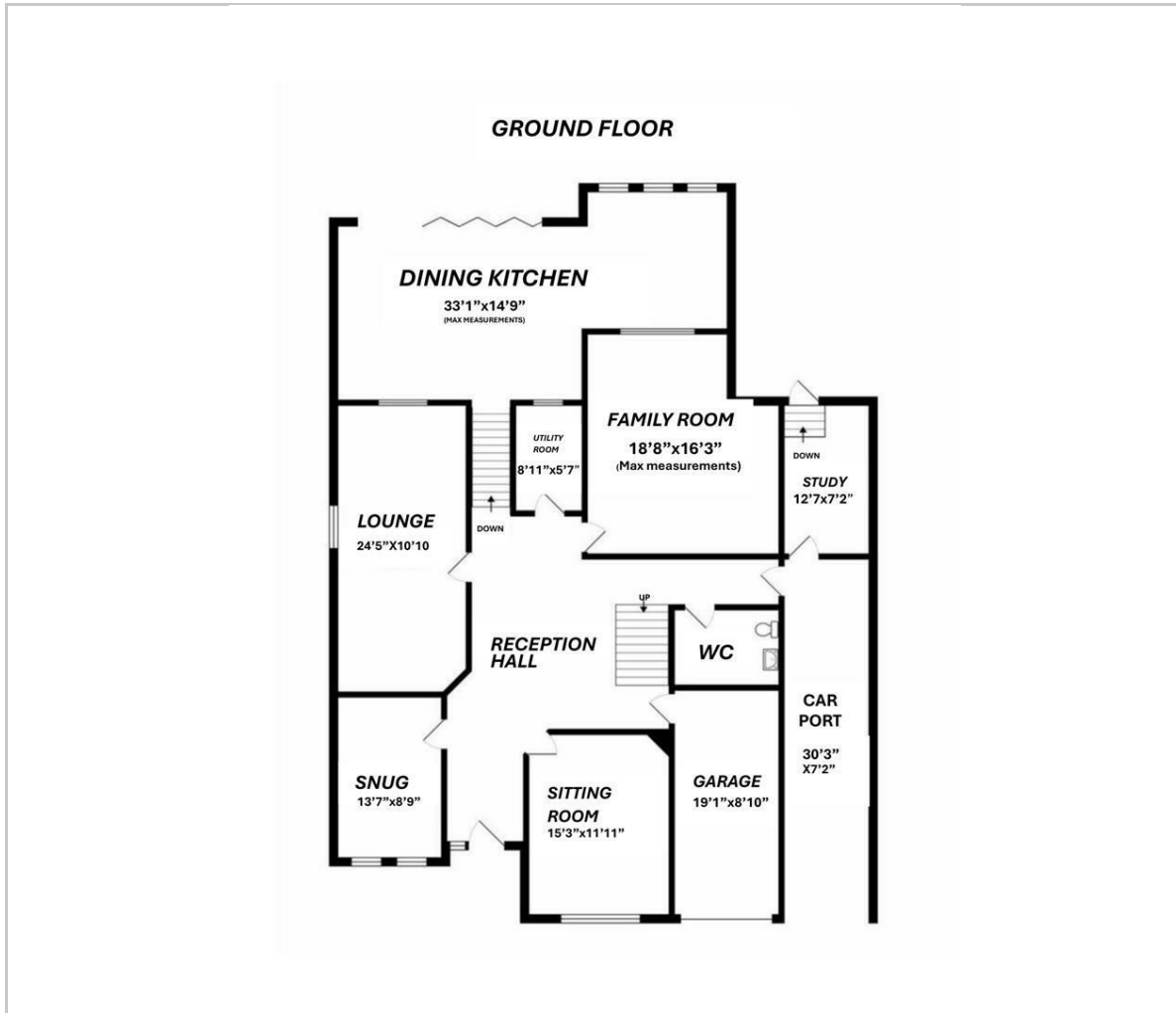

## Viewing

Please contact our Wigston Lettings Office on 0116 2883872 if you wish to arrange a viewing appointment for this property or require further information.

These particulars, whilst believed to be accurate are set out as a general outline only for guidance and do not constitute any part of an offer or contract. Intending purchasers should not rely on them as statements of representation of fact, but must satisfy themselves by inspection or otherwise as to their accuracy. No person in this firm's employment has the authority to make or give any representation or warranty in respect of the property.

**67 67 Long Street, Wigston, Leicestershire, LE18 2AJ**  
**Tel: 0116 2883872 Email: [lettings@astonandco.co.uk](mailto:lettings@astonandco.co.uk)**  
<https://astonandco.co.uk/>

## Area Map

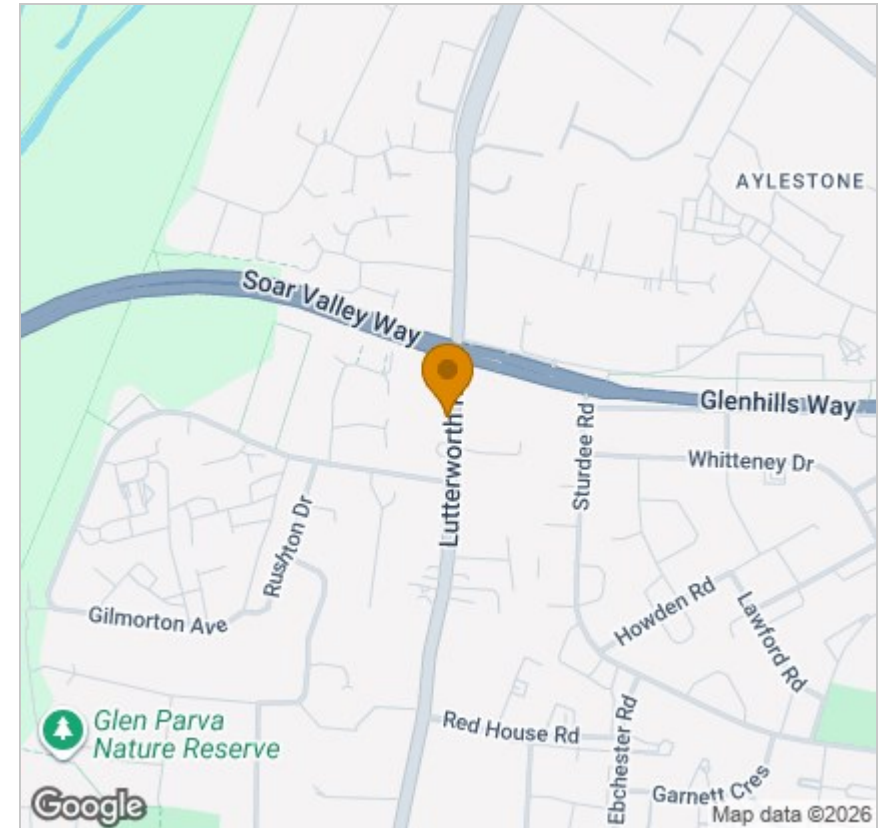

## Energy Efficiency Graph

