



**Hitchings, Cricklade – SN6 6NJ**  
Swindon

Fixed Price (40% Share) **£126,000**

**mcfarlane**  
property.com



# Hitchings

Cricklade, Swindon

- SHARED OWNERSHIP PROPERTY (40%)
- TWO Double Bedrooms
- Enclosed Rear Garden + Driveway  
Parking for TWO Cars
- Master Bedroom with En-Suite
- Sought After Modern Development

A sought after modern development on the edge of Cricklade offering a shared ownership scheme. This well positioned and proportioned site offers a TWO DOUBLE Bedrooms with a 40% purchase.

Full market value - £315,000

Share % - 40%

Share value - £126,000

Rent - £403.30pcm

Service charge - £16.50pcm

Staircasing restrictions - Can staircase to 100%

Lease term - 118 years remaining





# Hitchings

Cricklade, Swindon

Council Tax band: C

Tenure: Leasehold

EPC Energy Efficiency Rating: B

EPC Environmental Impact Rating: B



mcfarlane  
property.com



Agents Note: Whilst every care has been taken to prepare these sales particulars, they are for guidance purposes only. All measurements are approximate and for general guidance purposes only and whilst every care has been taken to ensure their accuracy, they should not be relied upon and potential buyers are advised to recheck the measurements.

## Ground Floor

Approx. 29.9 sq. metres (322.0 sq. feet)

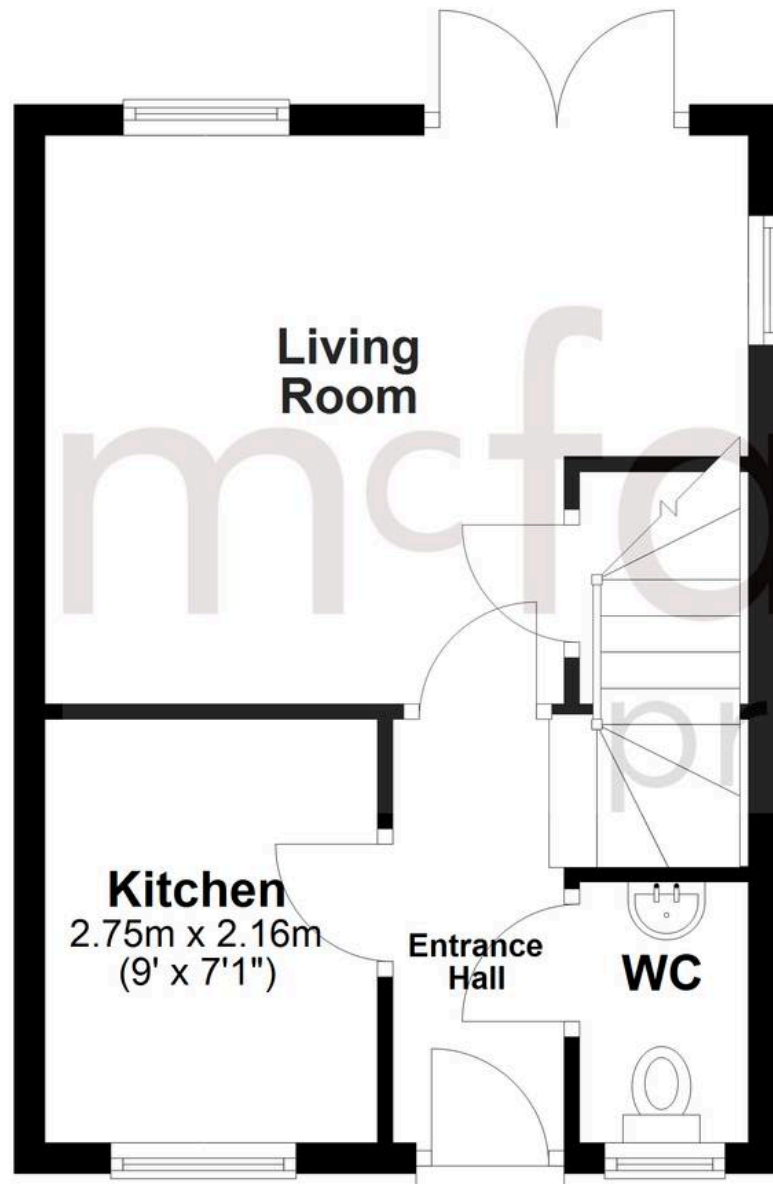

## First Floor

Approx. 29.9 sq. metres (322.0 sq. feet)

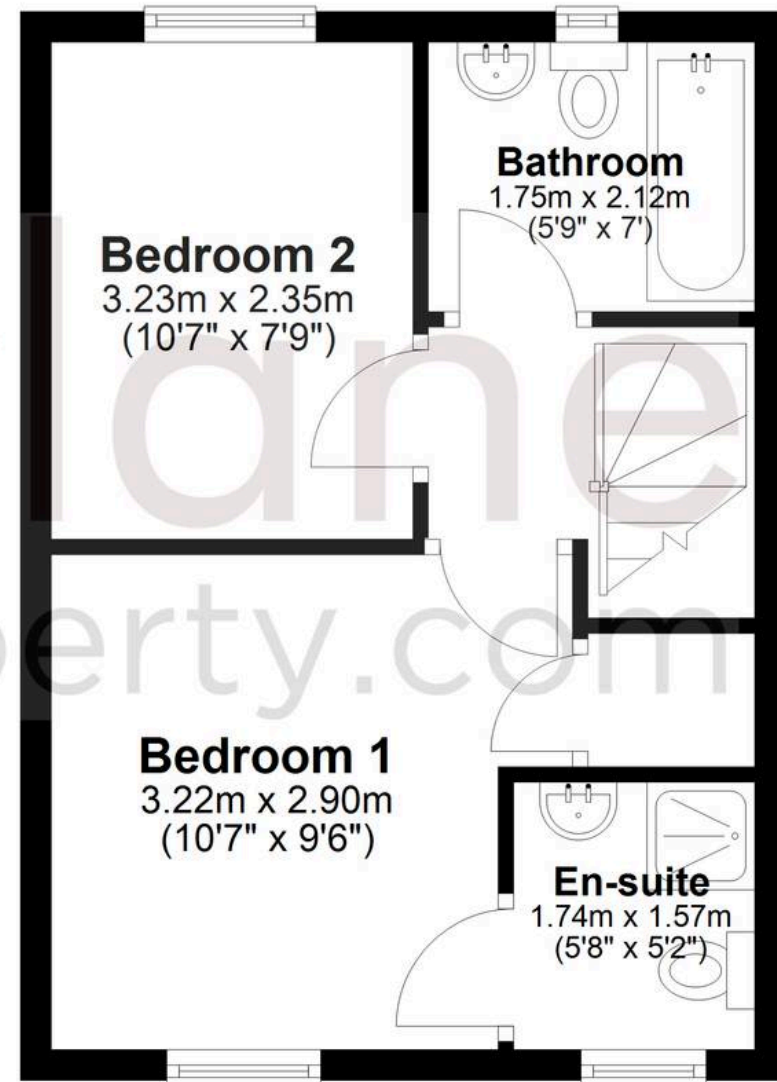

Total area: approx. 59.8 sq. metres (644.0 sq. feet)