

Location

Location Map

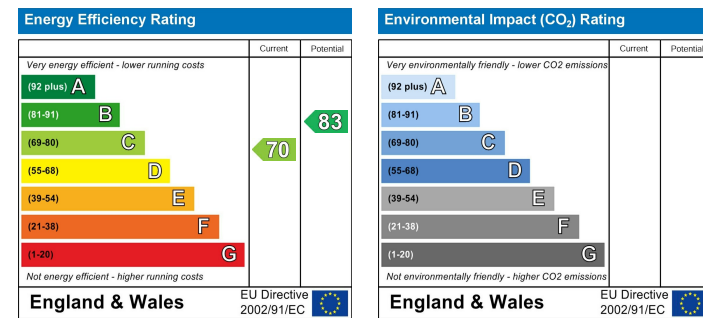

EPC Graph



Important Note

Centro Residential Sales and Lettings limited have not tested any services, heating system, electrical system, appliances, fixtures and fittings, that may be included in this property and would advise interested parties to satisfy themselves as to their condition or investigating the presence of any deleterious materials.

Viewing: Strictly by appointment through:

**CENTRO RESIDENTIAL SALES AND LETTINGS LIMITED**

Tel: 020 8401 5000

E-mail: [residential@centro.plc.uk](mailto:residential@centro.plc.uk)

See a selection of our properties at [www.centro.plc.uk](http://www.centro.plc.uk)

£2,500 Per Month - 30th May 2026

Henley Avenue, Sutton, SM3 9SA



Description

- Mid Terraced House
- Three Bedrooms
- Stunning Rear Garden
- Driveway Parking
- Modern Living
- Fitted Kitchen
- EPC Rating : C
- Council Tax Band : D

Features

- Gas heating
- Driveway Parking
- Outhouse

What you need to know

- Term: 12 months
- Rent: £2500pcm exclusive of bills
- Security deposit: £2884.00
- Council Tax band: C
- EPC Rating: D



## Floor Plan

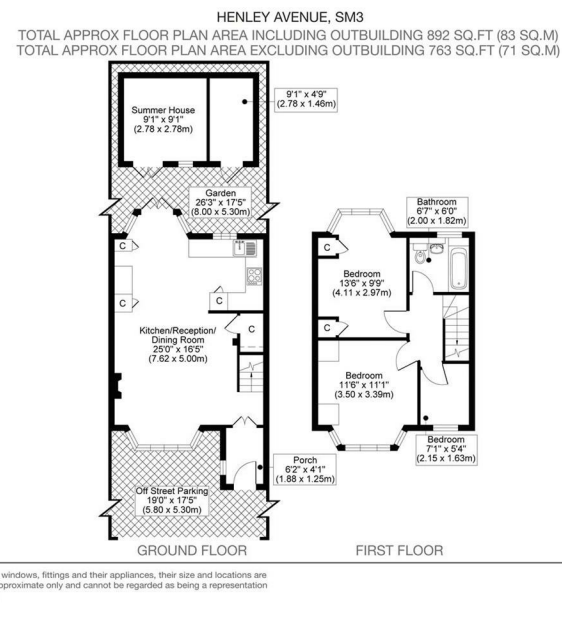

For illustration purposes only



All dimensions and measurements are approximate and for guidance only.

### *Just Centro's Opinion...*

Nestled on charming Henley Avenue in Cheam, this recently modernised three-bedroom house offers a perfect blend of contemporary living and outdoor charm.

The spacious living areas are designed to provide comfort and warmth, ensuring that every corner of the home feels inviting. Each of the three bedrooms is well-proportioned, offering ample space for relaxation and personalisation, making it suitable for families or those seeking extra room for guests or a home office.

One of the standout features of this property is the beautiful rear garden, which provides a serene escape from the hustle and bustle of daily life. The garden is complemented by a convenient outhouse. Additionally, the property benefits from driveway parking, ensuring that you have a secure and accessible space for your vehicle.

Offered part furnished and available from the end of May.

## Additional Photos

