



Solicitors & Estate Agents









Offers Over  
**£180,000**

## 16 (2F3) Dalgety Avenue

Meadowbank | Edinburgh | EH7 5UG

An exceptional opportunity has arisen to acquire this impressive and beautifully presented second-floor flat, forming part of an attractive traditional tenement in the highly sought-after Meadowbank area, conveniently located within easy reach of Edinburgh city centre.

-  1 Bedroom
-  1 Public Room
-  1 Bathroom
-  Zoned Parking
-  Communal Garden
-  EPC Rating – C
-  Council Tax Band - B



## Description

Presented to the market in true move-in condition, this superb property is sure to appeal to first-time buyers and professionals alike. The accommodation briefly comprises a secure entry system, welcoming hallway, bright and spacious reception room, and a newly fitted modern open-plan kitchen complete with integrated appliances. There is also a generously sized double bedroom featuring a substantial walk-in closet/study with a window, together with a contemporary shower room. Further benefits include gas central heating.



## Extras

All fitted floor coverings will be included in the sale together with the hob, oven, integrated fridge/freezer, integrated washer/dryer and integrated dishwasher.

## Gardens & Parking

There is a well maintained communal garden located to the rear of the building with permit/meter parking available to the front and surrounding streets.

## Viewing

By appointment through Neilsons (0131 625 2222).





## Location

The property is situated in the popular Meadowbank district of the city which lies approximately two miles to the east of Edinburgh City Centre and is well served by a frequent public transport service. The area has a good choice of leisure and retail facilities including the all-new exercise facilities at Meadowbank Stadium and Meadowbank Retail Park, which houses a large Sainsburys supermarket and a good variety of shops. The beautiful outdoor spaces of Holyrood Park and Arthur's Seat are nearby as are Leith Links. More extensive amenities can be found in Edinburgh City Centre as well as nearby Easter Road, which boasts a great range of shops and restaurants. Ocean Terminal and ASDA/Fort Kinnaird are short bus-rides away. Edinburgh City-Bypass and Edinburgh Waverley train station are both within easy travelling distance.





Approx. Gross Internal Floor Area 47 Sq M / 504 Sq Ft.

2nd Floor

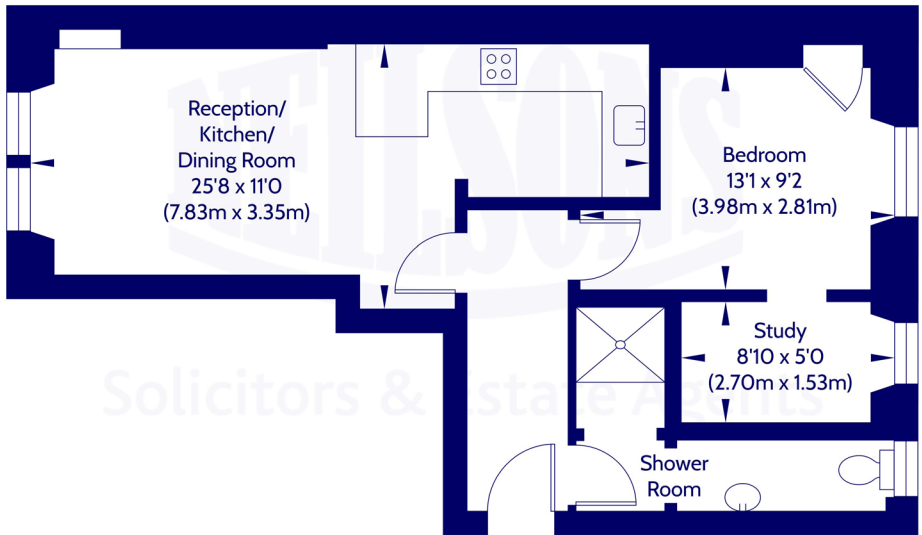

Area excludes garages, outbuildings, attics and eaves if applicable.  
All measurements are approximate. Not to scale. For identification only.  
© 2026 Neilsons Solicitors & Estate Agents. Plans by Planography.co.uk

Whilst we endeavour to ensure that our sales particulars are accurate and reliable, the following general points should be noted with regard to the extent of our investigations prior to marketing the property and therefore if any particular aspect is of crucial relevance to you, please contact this office for verification particularly if you are contemplating travelling some distance to view.

- [1] All measurements have been taken using a sonic measuring device and there may be some minor fluctuations in measurements due to the limitations of the device.
- [2] None of the items included in the sale of a working or running nature have been tested by us and this Firm gives no warranty as to their condition.
- [3] Where alterations or improvements have been undertaken by the sellers or their predecessors, we have not specifically established that the renewal or replacement of any of the services or facilities have been whole or partial.
- [4] Verification of Council Tax banding can be obtained from City of Edinburgh Council or Public Libraries.



Scan the QR code or [click here](#) for the virtual 360 tour, floor plan and further information.



Solicitors & Estate Agents

## Our Services:

- Full estate agency service
- Buying & Selling
- Buy to let advice
- Wills
- Powers of Attorney
- Executries

For helpful, friendly, personal advice, get in touch.

✉ [mail@neilsons.co.uk](mailto:mail@neilsons.co.uk)

☎ 0131 625 2222

💻 [www.neilsons.co.uk](http://www.neilsons.co.uk)

### Head Office

138-142 St John's Road  
Edinburgh  
EH12 8AY

### Property Department

162 St John's Road  
Edinburgh  
EH12 8AZ

### City Centre

2a Picardy Place  
Edinburgh  
EH1 3JT

### South Queensferry

37 High Street  
South Queensferry  
EH30 9HN

### Bonnyrigg

72 High Street  
Bonnyrigg  
EH19 2AE

