

Borrowfield Road

Spondon, Derby, DE21 7HG

John 
German





Borrowfield Road

Spondon, Derby, DE21 7HG

£310,000

Beautifully maintained contemporary home with a modern, versatile layout offering space, comfort, and practicality. Ideally located in a sought-after residential area close to amenities, schools, and excellent transport links—perfect for families and commuters.



Entrance to the property is via a spacious and inviting entrance hall with beautiful oak flooring which runs through into the kitchen and the guest WC. Stairs rise to the first floor with a useful under stairs storage cupboard, there is a window to the side and oak veneer doors lead off to the ground floor living spaces.

The guest WC is fitted with a low flush WC, pedestal washbasin, chrome heated towel rail and window to the front. This well laid out room also features a very useful built-in cloaks cupboard.

The living room overlooks the front garden with a newly fitted carpet. The space is open plan to the dining area but can be closed off if required with the addition of a pair of doors.

The spacious dining space features French doors opening directly onto the rear garden and lovely oak flooring which runs through to the kitchen area which is fitted with a contemporary range of sleek handleless base and eye level units with quartz worksurfaces and a one and a half bowl stainless steel sink unit with a window above overlooking the rear garden. Integrated appliances include a fridge, freezer, dishwasher, eye level oven and an induction hob with extractor hood over.

On the first floor a central landing has a window to the side, neutral fitted carpet and oak veneer doors leading off to three lovely bedrooms and a family bathroom.

The bathroom is fitted with a contemporary suite comprising low flush WC, pedestal washbasin, and a "P" shaped panelled bath with a shower over and fitted shower screen, extensive tiling and a window to the front.

Outside the property is set well back from the road behind a low maintenance front garden with a low boundary fence and gated access to the rear garden which is also designed for low maintenance. Beyond the garden is secure gated parking for two cars.

Tenure: Freehold (purchasers are advised to satisfy themselves as to the tenure via their legal representative).

Please note: It is quite common for some properties to have a Ring doorbell and internal recording devices.

Property construction: Standard

Parking: Off road parking

Electricity supply: Mains

Water supply: Mains

Sewerage: Mains

Heating: Mains

(Purchasers are advised to satisfy themselves as to their suitability).

Broadband type: Fibre - See Ofcom link for speed: <https://checker.ofcom.org.uk/>

Mobile signal/coverage: See Ofcom link <https://checker.ofcom.org.uk/>

Local Authority/Tax Band: Derby City Council / Tax Band C

Useful Websites: www.gov.uk/government/organisations/environment-agency

Our Ref: JGA/26082026

We are required by law to comply fully with The Money Laundering Regulations 2017 and as such need to complete AML ID verification and proof / source of funds checks on all buyers and, where relevant, cash donors once an offer is accepted on a property. We use the Checkboard app to complete the necessary checks, this is not a credit check and therefore will have no effect on your credit history. With effect from 1st March 2025 a non-refundable compliance fee of £30.00 inc. VAT per buyer / donor will be required to be paid in advance when an offer is agreed and prior to a sales memorandum being issued.







Ground Floor

Approximate total area⁽¹⁾

79.3 m²

853 ft²

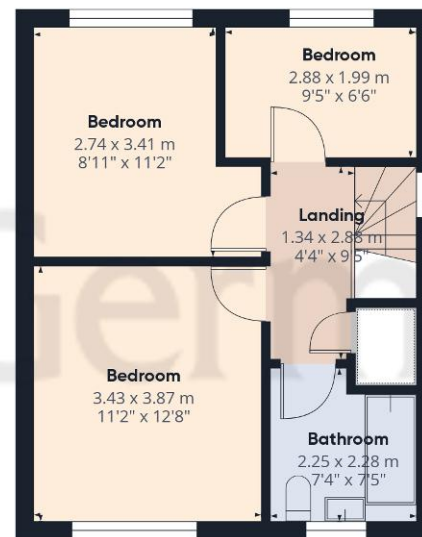

Floor 1



(1) Excluding balconies and terraces

Calculations reference the RICS IPMS 3C standard. Measurements are approximate and not to scale. This floor plan is intended for illustration only.

GIRAFFE 360



The property information provided by John German Estate Agents Ltd is based on enquiries made of the vendor and from information available in the public domain. If there is any point on which you require further clarification, please contact the office and we will be pleased to check the information for you, particularly if contemplating travelling some distance to view the property. Please note if your enquiry is of a legal or structural nature, we advise you to seek advice from a qualified professional in their relevant field.

Agents' Notes

These particulars do not constitute an offer or a contract neither do they form part of an offer or contract. The vendor does not make or give and Messrs. John German nor any person employed has any authority to make or give any representation or warranty, written or oral, in relation to this property. Whilst we endeavour to make our sales details accurate and reliable, if there is any point which is of particular importance to you, please contact the office and we will be pleased to check the information for you, particularly if contemplating travelling some distance to view the property. None of the services or appliances to the property have been tested and any prospective purchasers should satisfy themselves as to their adequacy prior to committing themselves to purchase.

Referral Fees

Mortgage Services - We routinely refer all clients to APR Money Limited. It is your decision whether you choose to deal with APR Money Limited. In making that decision, you should know that we receive on average £60 per referral from APR Money Limited.

Conveyancing Services - If we refer clients to recommended conveyancers, it is your decision whether you choose to deal with this conveyancer. In making that decision, you should know that we receive on average £150 per referral.

Survey Services - If we refer clients to recommended surveyors, it is your decision whether you choose to deal with this surveyor. In making that decision, you should know that we receive up to £90 per referral.

Score	Energy rating	Current	Potential
92+	A		95 A
81-91	B	83 B	
69-80	C		
55-68	D		
39-54	E		
21-38	F		
1-20	G		



John German

Suite 3, The Mill, Lodge Lane, Derby, Derbyshire, DE1 3HB

01332 943818

derby@johngerman.co.uk

Ashbourne | Ashby de la Zouch | Barton under Needwood
Burton upon Trent | Derby | East Leake | Lichfield
Loughborough | Stafford | Uttoxeter

JohnGerman.co.uk Sales and Lettings Agent



