



Poseidon Court

Homer Drive, E14

Asking Price £600,000

Set on the fourth floor, this stunning two-bedroom apartment enjoys desirable views over the River Thames. Early viewing is advised to truly appreciate the space, light, and impressive finish.

CHESTERTONS



Poseidon Court

Homer Drive, E14

- 2 Bedrooms | 2 Bathrooms
- Excellent condition throughout
- River views
- Private balcony
- 24-hour concierge including postal services
- Access to residents' gym, swimming pool and Jacuzzi
- Electric car charging bays in development
- Service charge includes cleaning, refuse management, communal maintenance, and a sinking fund for major works.



A beautifully presented two-bedroom apartment located in the popular Poseidon Court, enjoying desirable views across the River Thames. The apartment is offered in excellent condition throughout and features a larger-than-average private balcony, ideal for relaxing or entertaining.

Residents benefit from secure off-street parking and access to an impressive range of on-site amenities, including a gymnasium, swimming pool, Jacuzzi, and a 24-hour concierge service, all set within the peaceful and well-maintained Cyclops Wharf gated development.

Situated on Homer Drive, a highly sought-after residential location, the property is within easy reach of Canary Wharf's extensive selection of shops, bars, and restaurants. Mudchute DLR station is close by, providing convenient links to Canary Wharf and the City, with further transport options available via the Jubilee Line, Elizabeth Line, and Thames Clipper services offering direct routes to Greenwich and Embankment.

Tenure: Share of Freehold 991 years approx. remaining

Service Charge: £7,442 pa.

Ground Rent: Peppercorn

Local Authority: Tower Hamlets

Council Tax Band: F

Score	Energy rating	Current	Potential
92+	A		
81-91	B		
69-80	C	72 C	73 C
55-68	D		
39-54	E		
21-38	F		
1-20	G		

Chestertons Canary Wharf & Greenwich Sales

Harbour Island
 28 Harbour Exchange Square
 London
 E14 9GE
canarywharf@chestertons.co.uk
 020 7510 8300
chestertons.co.uk

Poseidon Court,
Homer Drive, E14

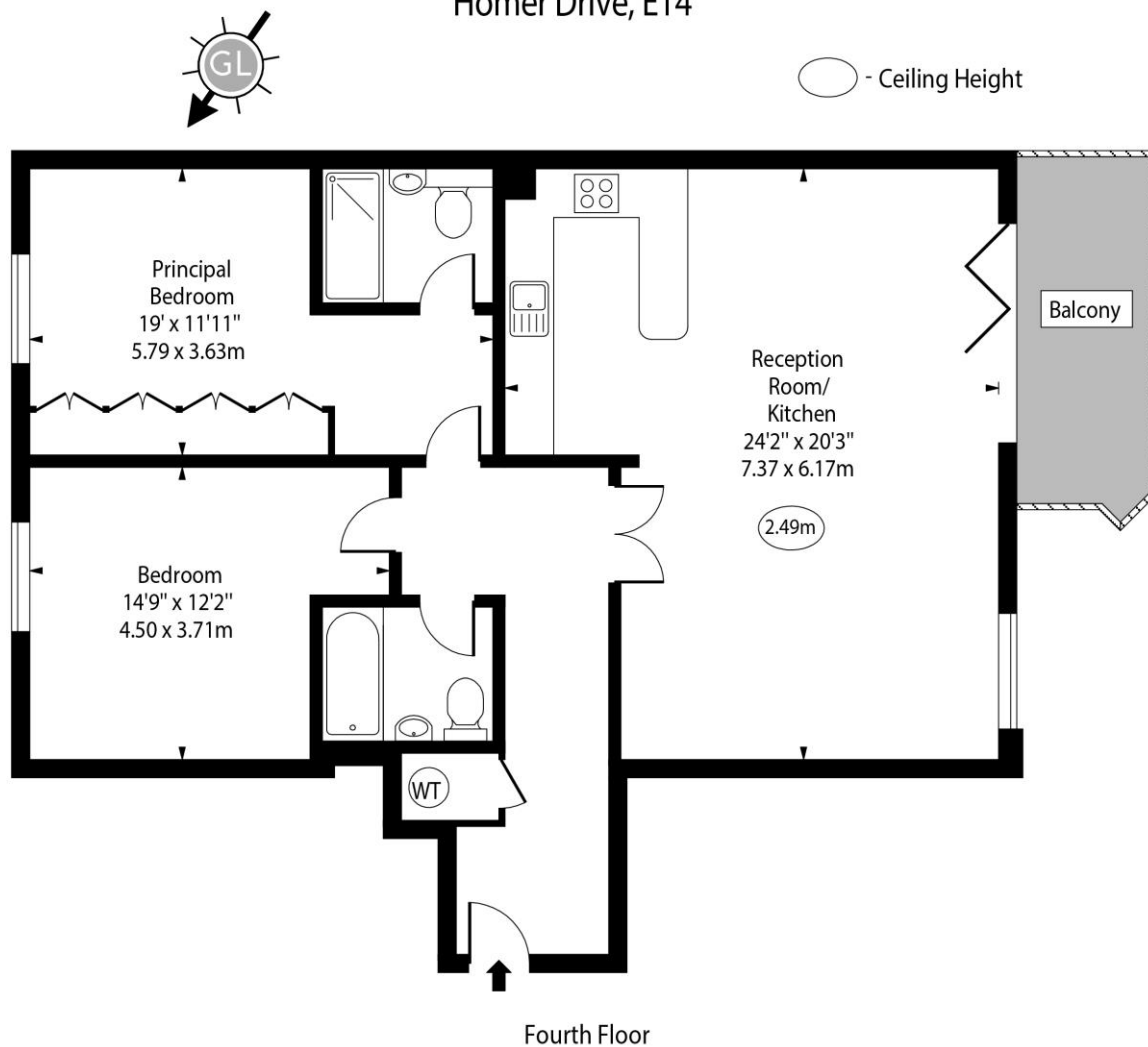

Approx Gross Internal Area 1017 Sq Ft - 94.48 Sq M

Every attempt has been made to ensure the accuracy of the floor plan shown. However, all measurements, fixtures, fittings, and data shown are approximate interpretations and for illustrative purposes only. Measured according to the RICS. Not To Scale.

www.goldlens.co.uk

Ref. No. 030266K

