



*jordanfishwick*

Chequers Road  
Manchester



# Chequers Road Manchester M21 9DX

£2,750 Per Calendar Month



## The Property

\*\*\*\* AVAILABLE NOW \*\*\*\* We are super excited to offer to this stunning four bedroom period terrace recently renovated over four floors. The property is in the heart of Chorlton on one of Chorlton's highly regarded roads and just off Beech Road. The property has been stylishly decorated and finished throughout and in brief offers; Entrance hall with ornate wall panelling, large lounge leading through to the stylish fully fitted kitchen. The cellar offers a large additional double bedroom/family room or office with ample storage, WC with walk in shower & utility. The first floor offers two double bedrooms both with en-suites the large front bedroom has a stunning bathing/dressing area which leads through to the en-suite with walk in shower. To the second floor there is one double bedroom with en-suite/walk in shower and store cupboard on the landing. The rear garden is fully fenced for privacy with Astro turf lawn and paved patio area. To the front of the property the space has been laid with stone allowing off road parking for one car and a slabbed path. Gas central heating and double glazed throughout. One not to be missed!

\*\*\*\*\* To arrange a viewing please call Tel 0161 860 4444 \*\*\*\*\*

## Directions

- Council Tax Band D - EPC D
- Stunning Renovation
- 4 Bedrooms
- Off road parking
- Beech Road location
- Unfurnished
- Available Now

Postcode - M21 9DX  
EPC Rating - D  
Floor Area - sq ft  
Local Authority - Manchester  
Council Tax - D



**BASEMENT**  
344 sq.ft. (32.0 sq.m.) approx.

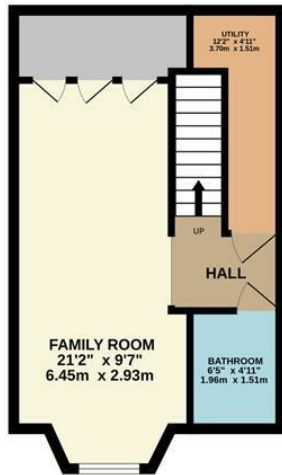

**GROUND FLOOR**  
523 sq.ft. (48.6 sq.m.) approx.

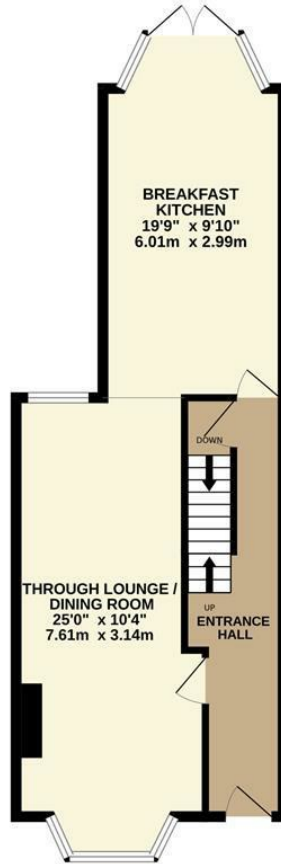

**1ST FLOOR**  
497 sq.ft. (46.2 sq.m.) approx.

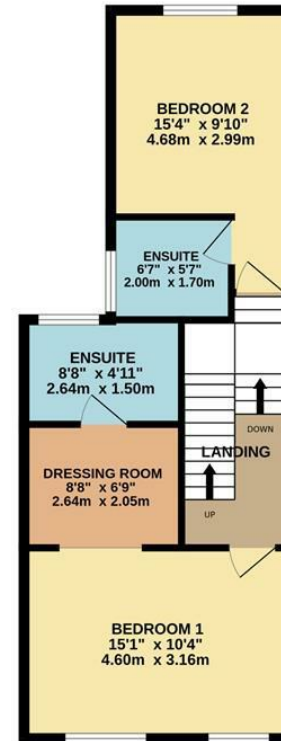

**2ND FLOOR**  
266 sq.ft. (24.7 sq.m.) approx.



**TOTAL FLOOR AREA : 1630 sq.ft. (151.4 sq.m.) approx.**

Whilst every attempt has been made to ensure the accuracy of the floorplan contained here, measurements of doors, windows, rooms and any other items are approximate and no responsibility is taken for any error, omission or mis-statement. This plan is for illustrative purposes only and should be used as such by any prospective purchaser. The services, systems and appliances shown have not been tested and no guarantee as to their operability or efficiency can be given.  
Made with Metropix ©2025



These particulars are believed to be accurate but they are not guaranteed and do not form a contract. Neither Jordan Fishwick nor the vendor or lessor accept any responsibility in respect of these particulars, which are not intended to be statements or representations of fact and any intending purchaser or lessee must satisfy himself by inspection or otherwise as to the correctness of each of the statements contained in these particulars. Any floorplans on this brochure are for illustrative purposes only and are not necessarily to scale.

Offices at: Offices at Chorlton, Didsbury, Disley, Hale, Glossop, Macclesfield, Manchester Deansgate, Manchester Whitworth Street, New Mills, Sale, Wilmslow and Withington

410-412 Barlow Moor Road, Chorlton, Manchester, M21

01618604444 <sup>8AD</sup>

chorlton@jordanfishwick.co.uk  
www.jordanfishwick.co.uk