

Floorplan

GROUND FLOOR  
261 sq.ft. (24.3 sq.m.) approx.

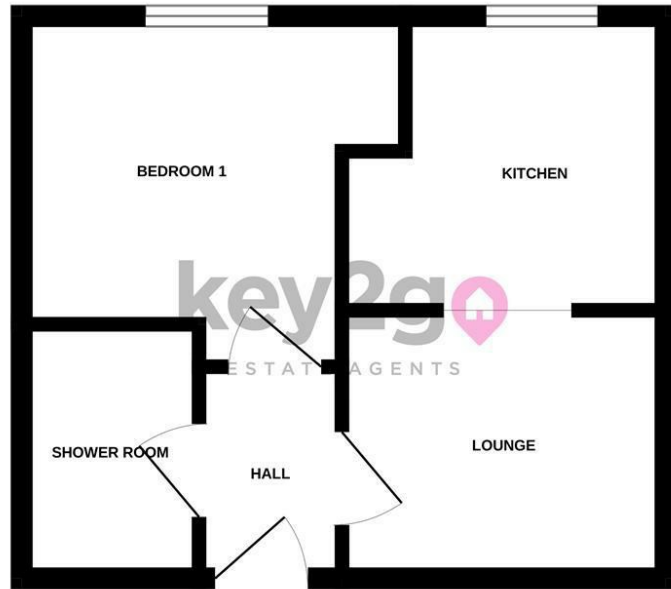

TOTAL FLOOR AREA: 261 sq.ft. (24.3 sq.m.) approx.  
Whilst every attempt has been made to ensure the accuracy of the description contained here, measurements of doors, windows, rooms and any other items are approximate and no responsibility is taken for any error, omission or mis-statement. This plan is for illustrative purposes only and should be used in conjunction with any prospective purchase. The services, systems and appliances shown have not been tested and no guarantee is given as to their operability or efficiency can be given.  
Made with Metropix ©2023

Area Map



Energy Efficiency Graph

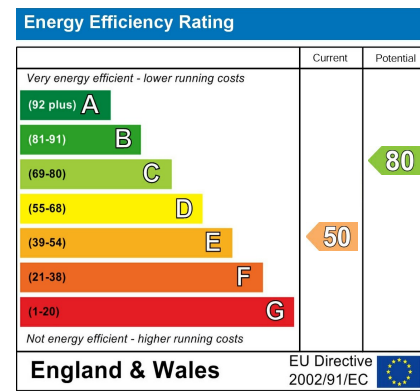

Viewing

Please contact our Lettings Team Office on 0114 2478819 if you wish to arrange a viewing appointment for this property or require further information.

These particulars, whilst believed to be accurate are set out as a general outline only for guidance and do not constitute any part of an offer or contract. Intending purchasers should not rely on them as statements of representation of fact, but must satisfy themselves by inspection or otherwise as to their accuracy. No person in this firm's employment has the authority to make or give any representation or warranty in respect of the property.



Flat 2 22 Hayes Drive  
Halfway, Sheffield, S20 4TR

£575 PCM



# Flat 2 22 Hayes Drive

Halfway, Sheffield, S20 4TR

£575 PCM



A fantastic opportunity to rent this ground floor flat having parking and a garden to the rear. Recently having been decorated throughout, with new fitted kitchen and new cooker installed. The property is well positioned for local amenities and main transport links, also a short walk away from Countryside walks!

