



Portland Grove, SW8

£496 Per week

A bright one bedroom apartment with a large private roof terrace, on a quiet cul-de-sac close to Stockwell Underground Station.

The property offers a spacious bedroom, tiled bathroom, and an open plan lounge and kitchen leading directly onto a large private roof terrace with outside storage and spectacular views.

Portland Grove is a short walk from Stockwell Underground Station (Northern/Victoria Line), ideal for commuting into The City and The West End, with the popular Canton Arms pub and Little Portugal nearby for great food and drinks.

Features

- One Bedroom
- Third Floor Flat
- Private Roof Terrace
- Open Plan
- Great Location
- Close To Tube

Portland Grove, London, SW8

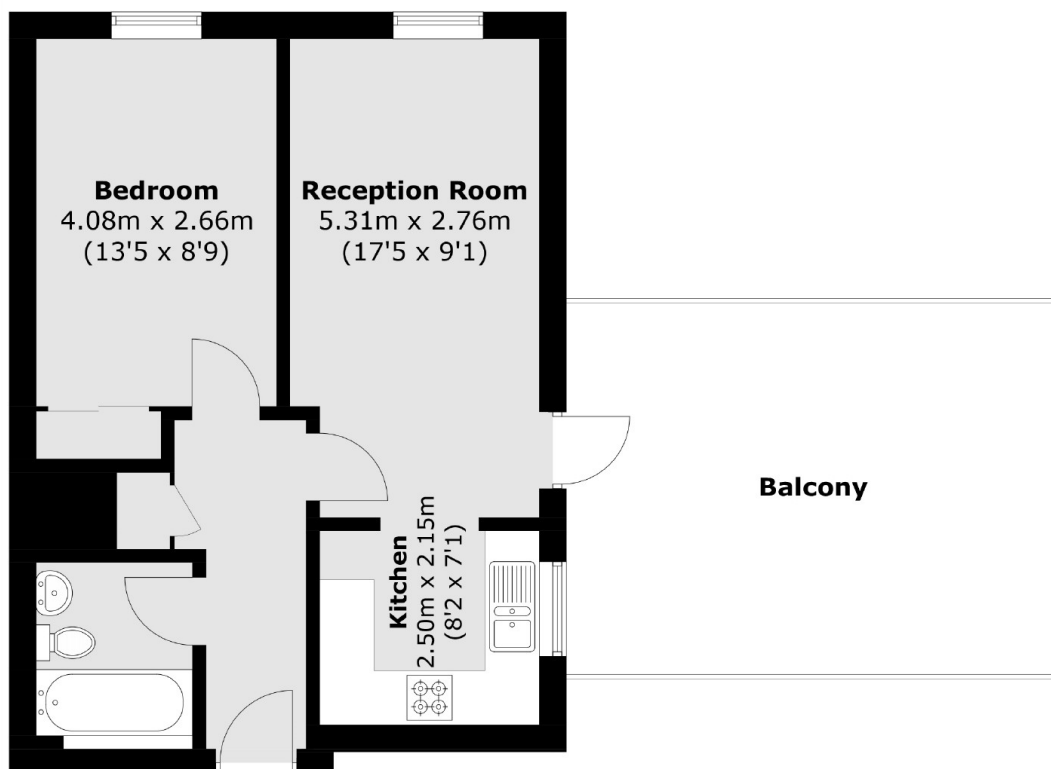

Third Floor

Total area (approx.): 43.4 sq. m (467.1 sq. ft)
Balcony: 22.6 sq. m (243.3 sq. ft)