



2 Bedroom Ground Floor Maisonette Villiers Close, Surbiton, KT5 8DL £399,999 Leasehold

Two Bedroom Ground Floor Garden Maisonette with a private Garden and Garage situated in a quiet Cul-de-sac within equal walking distance of Surbiton & Kingston town centre

An exciting opportunity to secure a 2-bedroom maisonette to update and make it your own.

Measuring 559 sq ft of internal living space.

The front door opens to an entrance hall which leads to the reception room and a separate kitchen. The two bedrooms are located to the rear of the property. The principal bedroom offers access to the private garden, further double bedroom and a family bathroom.

Outside the property, a private garden, storage cupboard and a private garage next to the property. Offered to the market with no onward chain.

WWW.STACKANDBONNER.COM

020 8974 8844

sales@stackandbonner.com



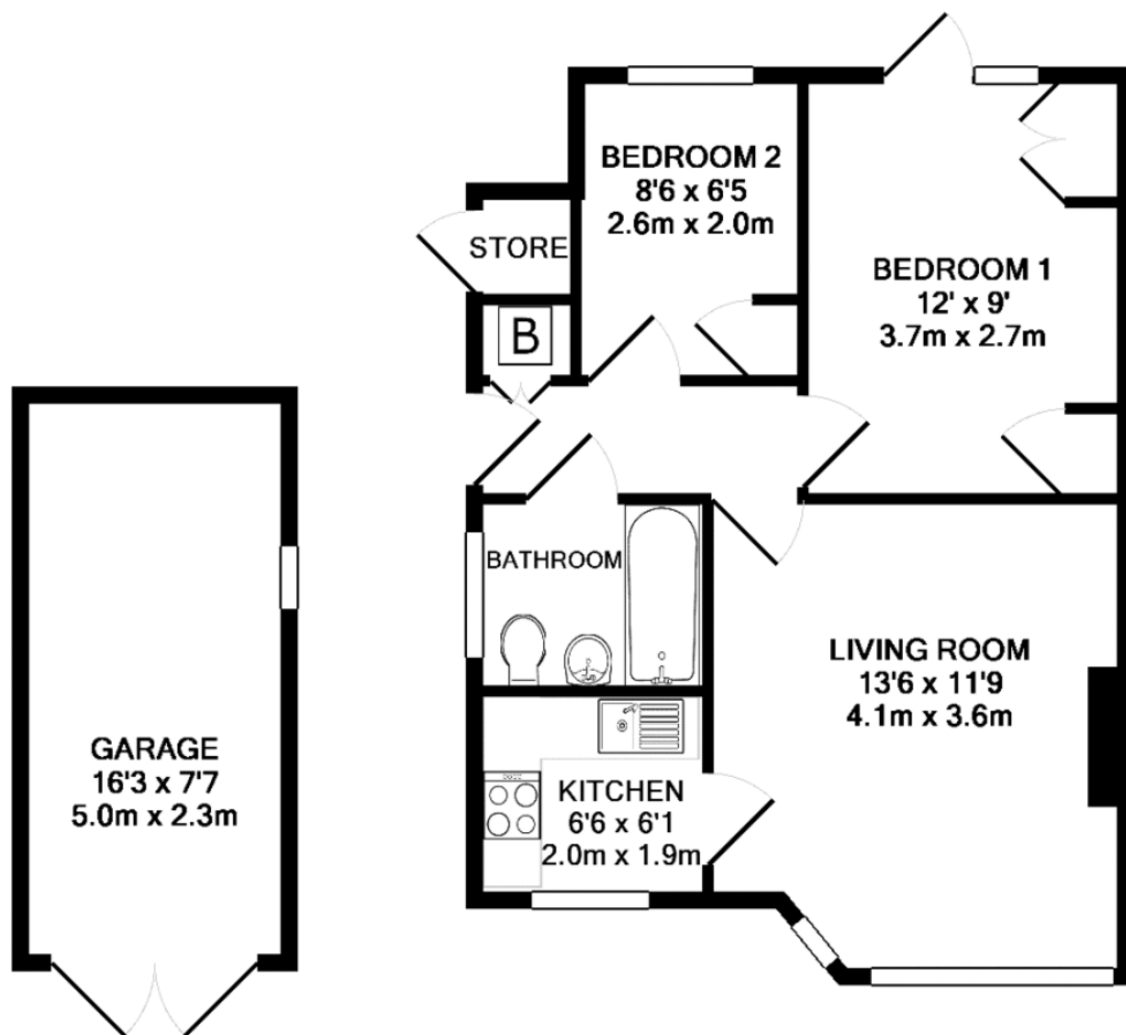

VILLIERS CLOSE, SURBITON, KT5 8DL
 TOTAL APPROX. FLOOR AREA 559 SQ.FT. (51.9 SQ.M.)

Whilst every attempt has been made to ensure the accuracy of the floor plan contained here, measurements of doors, windows, rooms and any other items are approximate and no responsibility is taken for any error, omission, or mis-statement. This plan is for illustrative purposes only and should be used as such by any prospective purchaser. The services, systems and appliances shown have not been tested and no guarantee as to their operability or efficiency can be given

Made with Metropix ©2010

- Two-Bedroom Ground Floor Maisonette
- 558 sq ft of Internal Living Space
- Private Front & Rear Gardens
- Garage & Off-Street Parking
- Reception Room with Large Bay Window, Feature Chimney Breast
- Modern Fitted Kitchen with Supplied & Fitted Appliances
- Principal Bedroom with access to the private garden
- Second Bedroom
- Modern Fitted White Bathroom Suite
- Lease : TBC
- Ground Rent £7.35 PA
- Sold With No Onward Chain