



Salisburys

Devon Tors, Yelverton, PL20

Offers In Region Of £125,000

🛏 1 🚿 1 🚗 1



- Well Proportioned One Bedroom Ground Floor Apartment
- Spacious Bay-Fronted Lounge with Kitchen Area
- Bathroom
- Close to Local Amenities and Bus Routes
- Council Tax A
- Spacious Hallway with Storage
- Double Bedroom Overlooking Communal Gardens
- Gas Central Heating & Double Glazing
- Convenient Parking
- CHAIN FREE!



This well presented one bedroom apartment is set on the ground floor of the iconic Devon Tors building in the heart of Yelverton Village. The apartment offers very well proportioned accommodation with a spacious bay-fronted Living Room with Kitchen, Bathroom with bath, double bedroom and spacious Entrance vestibule with good storage options. The apartment is very conveniently positioned within a short walk to Yelverton Parade which offers a range of local amenities including a Doctors Surgery, chemist, cafes, Co-op, butchers and bus services to Plymouth, Tavistock and surrounding areas as well as the N27 Cycle Route. Externally, the apartment has parking to the front of the building and is offered to the market CHAIN FREE!

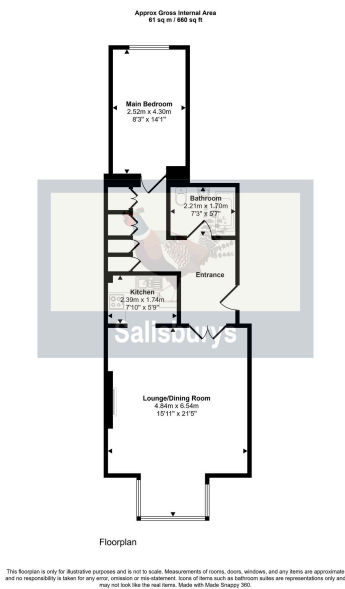

Score	Energy rating	Current	Potential
92+	A		
81-91	B		
69-80	C	79 C	79 C
55-68	D		
39-54	E		
21-38	F		
1-20	G		

