



A one bedroom ground floor apartment with a private garden  
Holwell Place, Pinner, HA5 1DY



**Asking Price: £1,650 pcm**

## **A one bedroom ground floor apartment with a private garden**

Holwell Place, Pinner, HA5 1DY

---

• CONVENIENTLY LOCATED • ENTRANCE HALL AND STAIRS TO FIRST FLOOR • HALLWAY • LIVING ROOM • FITTED KITCHEN WITH APPLIANCE • TWO BEDROOMS • MODERN BATHROOM WITH SHOWER & BATH • PRIVATE REAR GARDEN • UNFURNISHED

---

### **Description**

Generous living with bright and breezy interiors throughout, this one bedroom ground floor maisonette offers a relaxed and uncompromisingly private lifestyle. This residence comprises of entrance hallway, spacious reception room, modern fitted kitchen, one bedroom, family bathroom suite plus a separate cloak room. Rear garden and street permit parking.

**\*\* An advance reservation payment of one weeks rent is required to secure the property \*\***

### **Location**

Holwell Place is ideally situated moments away from Pinner Village shops, restaurants, bars, coveted schooling and Metropolitan Line tube station.





**Additional Information**

- Local Authority: Harrow
- Council Tax Band: C
- Deposit Amount: £1,903.00
- Reservation Payment: One weeks rent
- Energy Efficiency Rating: Band D
- Available Date: 05/08/2026

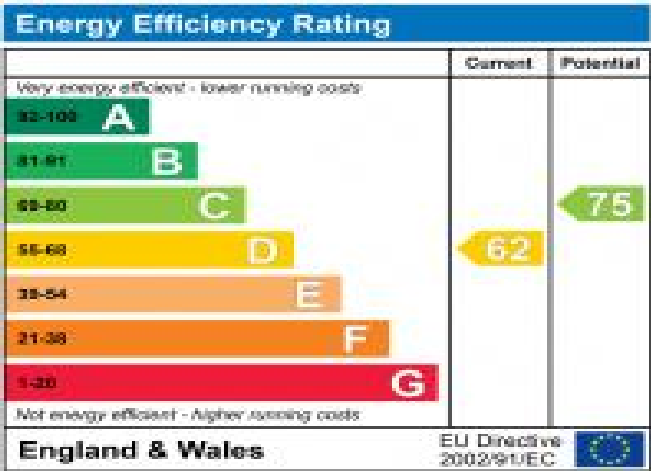

# Holwell Place

Approximate Gross Internal Area = 56.2 sq m / 605 sq ft



 = Reduced headroom below 1.5m / 5'0

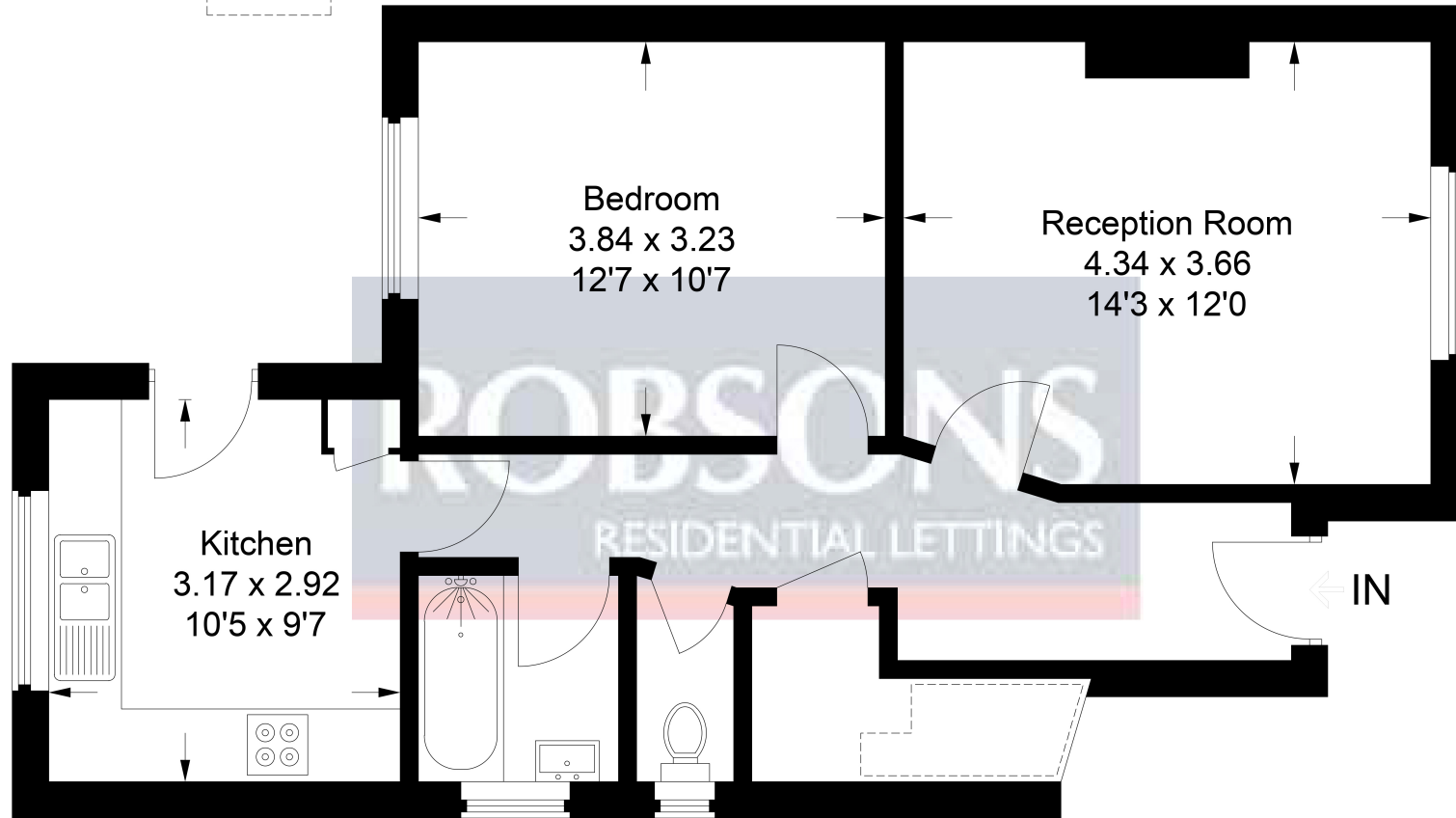

## Ground Floor

This plan is for layout guidance only. Not drawn to scale unless stated. Windows and door openings are approximate. Whilst every care is taken in the preparation of this plan, please check all dimensions, shapes and compass bearings before making any decisions reliant upon them.

© CJ Property Marketing Ltd Produced for Robsons



REGISTERED OFFICE 2-4 PACKHORSE ROAD, GERRARDS CROSS, BUCKINGHAMSHIRE, ENGLAND, SL9 7QE. COMPANY NO. 07557114. VAT NO. GB211239453