

Grove End Road, NW8

£311 Per week

A bright one bedroom apartment on the fourth floor of a mansion block in St John's Wood. Open plan kitchen / reception, double bedroom, bathroom with shower over bath and built in storage in hallway. Communal hot water included. Ideal for single professional.

Addison House is a short distance to St Johns Wood High Street and underground station.

Features

One Bedroom Apartment
Fourth Floor Via Lift
Portered Building
Open Plan Kitchen
Hot Water Included
Communal Garden

Grove End Road, London, NW8

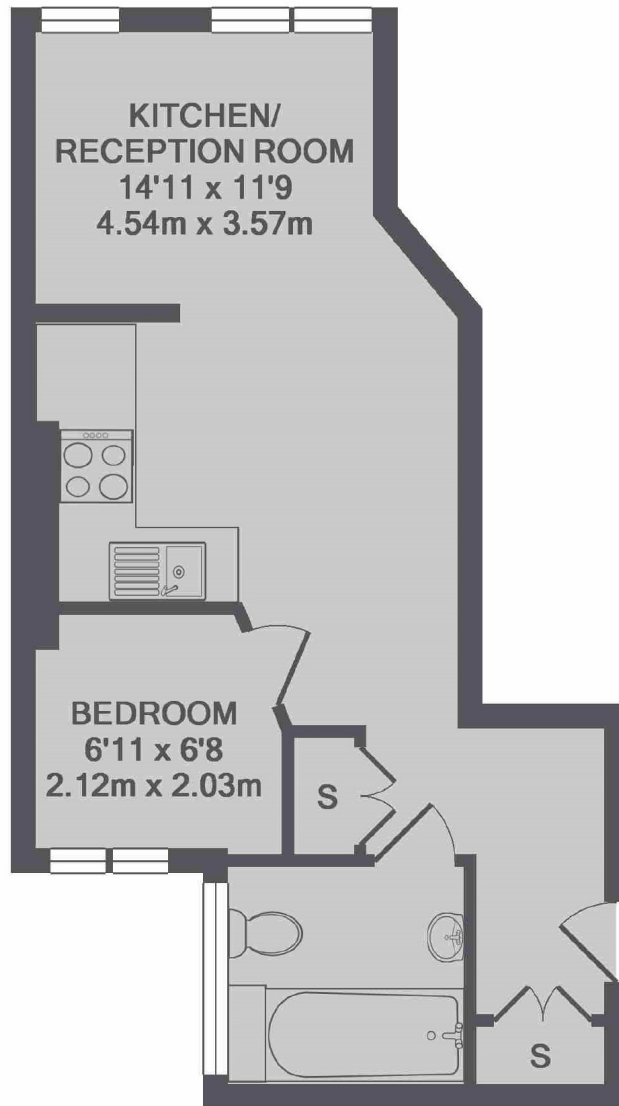

TOTAL APPROX. FLOOR AREA 325 SQ.FT. (30.2 SQ.M.)

Contact

To arrange a viewing call our office on the number below or visit our website.



Energy Rating: E. We aim to make our particulars both accurate and reliable. However they are not guaranteed; nor do they form part of an offer or contract. If you require clarification on any points then please contact us, especially if you're traveling some distance to view. Please note that appliances and heating systems have not been tested and therefore no warranties can be given as to their good working order.