

# Pepys Close

Ickenham • Middlesex • UB10 8NX

PCM: £1,400 PCM



coopers  
est 1986





This one bedroom ground floor flat offers GREAT SPACE and is set in a very POPULAR location in Ickenham with its quiet surroundings and distance to the Piccadilly/Metropolitan train lines. There is also easy access to the A40,M25 and M40 road links and Uxbridge Town Centre is close by with its variety of shops, bars, restaurants. An ideal home for tenants looking for a relaxed lifestyle whilst close enough to make access into Central London accessible. Accessed via a well maintained communal entrance, the property offers a spacious living room, a separate contemporary fitted kitchen, one double bedroom and a modern bathroom.

One bedroom flat

Ground floor

Sizeable lounge

Fantastic communal gardens

Modern fitted kitchen

Contemporary bathroom

Walking distance to transport links

Allocated parking space

Peaceful location

**Available Date**

7th April 2026



GROUND FLOOR  
564 sq.ft. (52.4 sq.m.) approx.

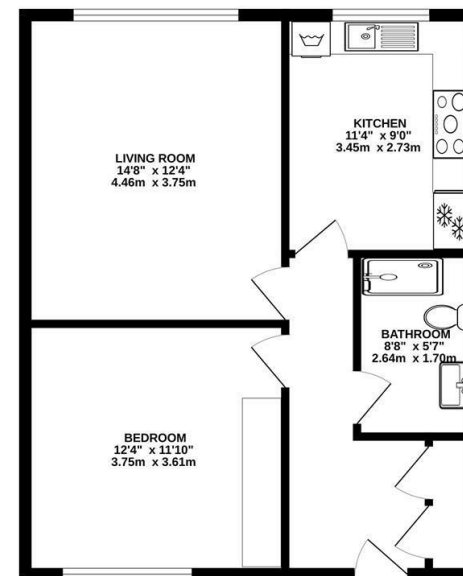

TOTAL FLOOR AREA: 564 sq.ft. (52.4 sq.m.) approx.  
Whilst every attempt has been made to ensure the accuracy of the floorplan contained here, measurements of doors, windows, rooms and any other items are approximate and no responsibility is taken for any error, omission or mis-statement. This plan is for illustrative purposes only and should be used as such by any prospective purchaser. The services, systems and appliances shown have not been tested and no guarantee, as to their operation or efficiency can be given.  
Made with Metropac C2024

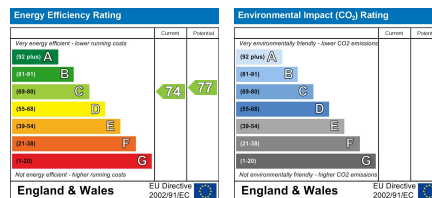

Important Notice: These particulars, whilst believed to be accurate are set out as a general outline only for guidance and do not constitute any part of an offer or contract. Intending purchasers should not rely on them as statements or representation of fact, but must satisfy themselves by inspection or otherwise has the authority to make or give any representation or warranty in respect of the property.

**coopers**  
est 1986

**01895 625 625**

126-128 High Street, Ruislip,  
Middlesex, HA4 8LL  
rl@coopersresidential.co.uk

**CoopersResidential.co.uk**