



Eton Place, Eton College Road NW3

£2,700 PCM

2 1 1 C

Floor Plan

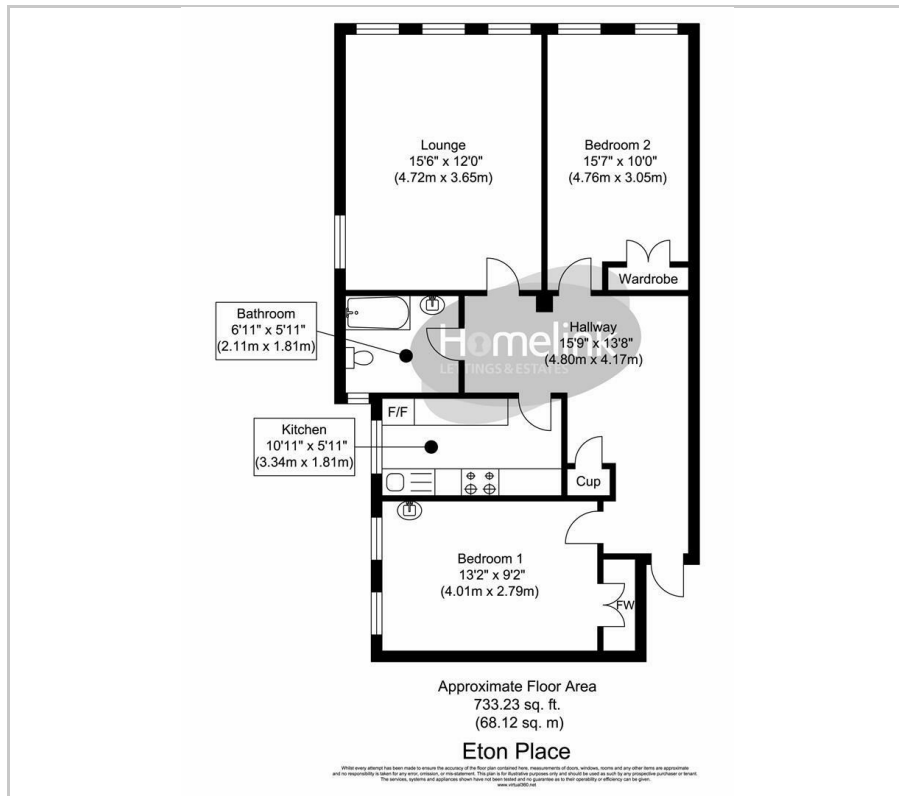

Area Map

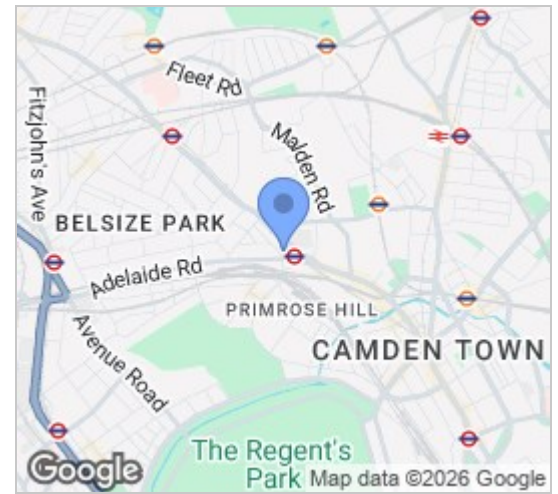

Energy Efficiency Graph

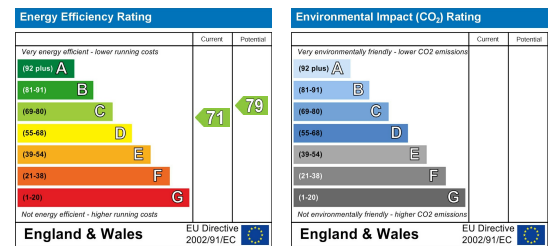

Viewing

Please contact our Homelink Lettings & Estates Office on 0208 882 2112 if you wish to arrange a viewing appointment for this property or require further information.

- 2 bedroom
- Near local park
- Camden council Tax Band D
- Furnished
- Concierge
- Good transport links
- 2026/27 C/tax -£2,207.12
- Available now



Welcome to this charming flat located at Eton Place, nestled on Eton College Road in the heart of London. This delightful property boasts two well-proportioned bedrooms.

Upon entering, you will find a spacious reception room that serves as the perfect setting for relaxation or entertaining guests. The flat is thoughtfully furnished, ensuring that you can move in with ease and start enjoying your new home right away. The modern bathroom is designed for both functionality and comfort, catering to your daily needs.

One of the standout features of this property is its excellent transport links, providing easy access to various parts of London. Whether you are commuting to work or exploring the city's many attractions, you will find that getting around is both convenient and efficient.

In addition to its prime location, residents can take advantage of nearby local parks, offering a serene escape from the hustle and bustle of city life. The presence of a concierge adds an extra layer of convenience and security, making this flat not only a lovely place to live but also a safe one.

In summary, this two-bedroom flat at Eton Place is a wonderful opportunity for those looking to enjoy the best of London living. With its excellent amenities, great transport links, and proximity to green spaces, it is a property



These particulars, whilst believed to be accurate are set out as a general outline only for guidance and do not constitute any part of an offer or contract. Intending purchasers should not rely on them as statements of representation of fact, but must satisfy themselves by inspection or otherwise as to their accuracy. No person in this firm's employment has the authority to make or give any representation or warranty in respect of the property.

Homelink Lettings and Estates
62 Chase Side, London N14 5PA
0208 882 2112 homelink.co.uk

