

*To arrange a viewing contact us
today on 01268 777400*



Zider Pass, Canvey Island £440,000

Aspire Presents... An Exceptional Family Home in the Heart of Canvey Point

Discover the perfect blend of space, style, and coastal living with this impressive four-bedroom detached residence, beautifully positioned in the highly sought-after Canvey Point location. Ideally suited for families, this home offers convenience and comfort just moments from local schools, bus routes, and only a stone's throw from Canvey seafront – the perfect spot for weekend strolls and summer days out.

From the moment you arrive, this home impresses with its generous proportions and thoughtful layout. The ground floor features a beautifully designed kitchen/diner, seamlessly leading into a bright conservatory, perfect for relaxed family dining or entertaining guests. A modern ground-floor shower room adds convenience, while the two garages offer ample storage and exciting potential for conversion—perhaps a home office, gym, or additional living space.

Upstairs, you'll find a family bathroom and four well-sized bedrooms, including three doubles, a large single, and an exceptionally spacious master bedroom - a true retreat for parents.

Step outside and discover your own private oasis. The rear garden boasts a charming sun room, ideal for unwinding whatever the weather, and even a sauna for the ultimate touch of luxury and relaxation.

This property is more than just a house, it's a lifestyle opportunity. Whether you're growing your family, seeking more space, or simply looking to settle in a prime location close to the sea, this home has it all.

Room Measurements

Lounge

5.11m x 3.12m (16'9" x 10'3")

Kitchen / Diner

4.78m x 3.05m (15'8" x 10'0")

Sun Room

5.05m x 1.85m (16'7" x 6'1")

Bedroom One

4.34m x 2.97m (14'3" x 9'9")

Bedroom Two

5.36m x 2.44m (17'7" x 8'0")

Bedroom Three

3.58m x 2.13m (11'9" x 7'0")

Bedroom Four

2.79m x 1.98m (9'2" x 6'6")

Garden Room

3.81m x 2.34m (12'6" x 7'8")

Sauna

2.79m x 1.27m (9'2" x 4'2")

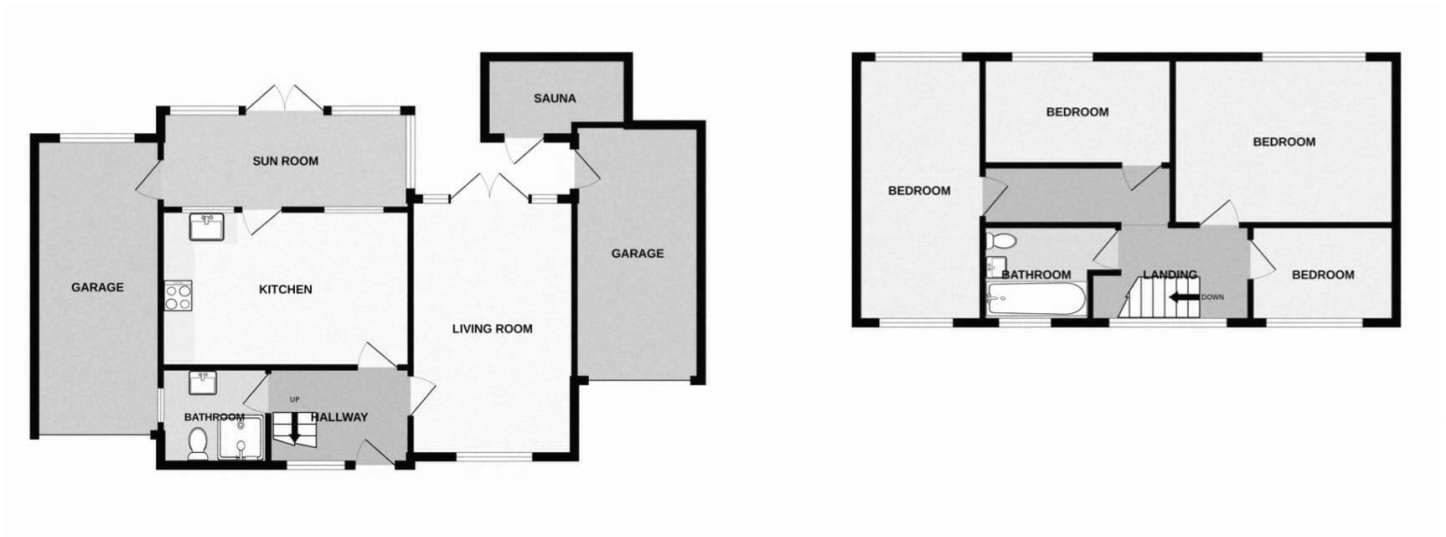

Energy Efficiency Rating	
Very energy efficient - lower running costs	Current Potential
(92 plus) A	84
(81-91) B	70
(69-80) C	
(55-68) D	
(39-54) E	
(21-38) F	
(1-20) G	
Not energy efficient - higher running costs	
England & Wales EU Directive 2002/91/EC	
Environmental Impact (CO ₂) Rating	
Very environmentally friendly - lower CO ₂ emissions	Current Potential
(92 plus) A	
(81-91) B	
(69-80) C	
(55-68) D	
(39-54) E	
(21-38) F	
(1-20) G	
Not environmentally friendly - higher CO ₂ emissions	
England & Wales EU Directive 2002/91/EC	

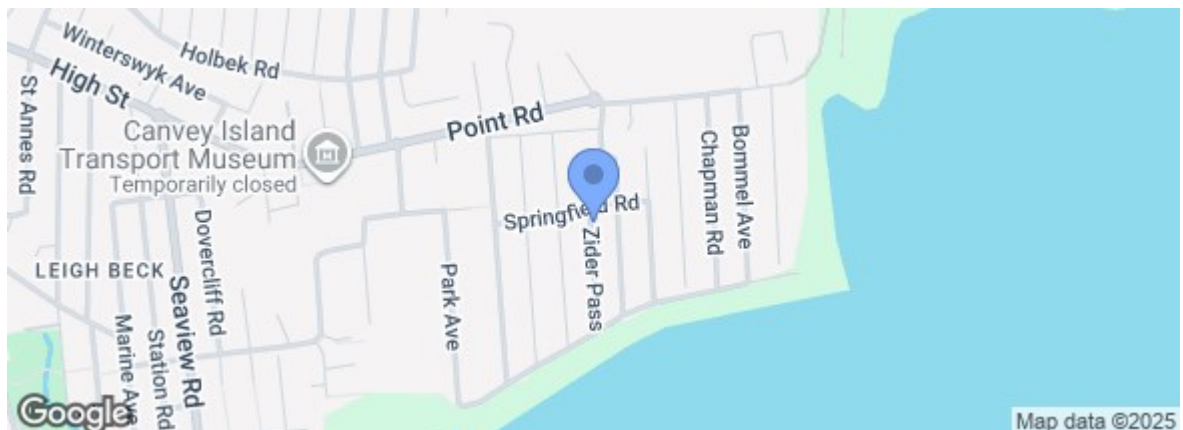

Under the Property Misdescriptions Act 1991 we make every effort to ensure our sales details are accurate but they are a general outline and do not constitute any part of an offer or contract. Any services, equipment and fittings have not been tested and no warranty can be given as to their condition. We strongly recommend that all the information provided be verified by your advisors and in particular, measurements required for a specific purpose such as fitted furniture or carpets. Please tell us if you have any problems and members of our branches will help either over the phone or in person. A copy of our complaints procedure is available on request. The details are issued on the strict understanding that any negotiations in respect of the property named herein are conducted through Aspire Estate Agents.