



**St. Michaels Road, YEOVIL, BA21 5AH**

**welcome to**

**St. Michaels Road, YEOVIL**

A two bedroom end of terrace home, situated within a popular residential area of Yeovil and close to many local amenities. The accommodation is presented in excellent decorative order boasting a wealth of space & natural light throughout. Externally boasting allocated parking & enclosed rear garden.



## Entrance

Double glazed door to the front, opening into:

## Entrance Hall

Tiled flooring. Opening into:

## Fitted Kitchen

8' 10" x 7' 1" ( 2.69m x 2.16m )

Double glazed window to the front. A range of fitted wall, base and drawer units with work surface over and complementary tiled surround. Single bowl stainless steel sink and drainer with mixer tap. Integrated induction hob with cooker hood over and electric oven below. Plumbing for washing machine and tumble dryer. Space for fridge freezer. Wall mounted boiler. Tiled flooring.

## Lounge/ Diner

14' 6" x 12' 10" ( 4.42m x 3.91m )

A lovely light room with double glazed window to the rear. Stairs rising to the first floor. Contemporary wall mounted electric fire. Space for dining table and chairs. Wall light points. Radiator. Double glazed patio doors to the rear, opening to the garden.

## First Floor Landing

Airing cupboard. Access to the loft space.

## Bedroom One

9' 6" x 8' 9" ( 2.90m x 2.67m )

Double glazed window to the rear, overlooking the garden. Built in wardrobe. Space for free standing furniture. Radiator.

## Bedroom Two

10' 6" x 7' 1" ( 3.20m x 2.16m )

Double glazed window to the front. Built in wardrobe. Space for free standing wardrobe. Radiator.

## Bathroom

Double glazed window to the front. Suite comprising enclosed bath with mixer tap and shower over, wash hand basin and WC. Extractor fan. Tiled flooring. Chrome towel radiator.

## Parking

There is one allocated parking space.

## Rear Garden

A fully enclosed rear garden, laid mainly to paving and shingle, for low maintenance, providing an ideal seating/entertaining area to enjoy the summer sunshine and alfresco dining. Two garden sheds. Gated side access leading to the parking area.

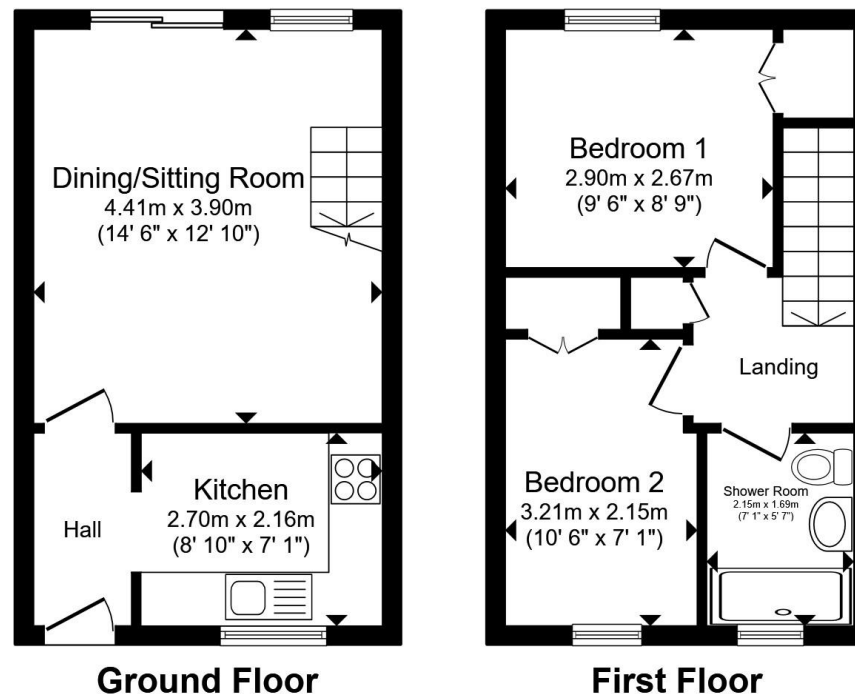

Total floor area 52.0 m<sup>2</sup> (560 sq.ft.) approx

This floor plan is for illustrative purposes only. It is not drawn to scale. Any measurements, floor areas (including any total floor area), openings and orientation are approximate. No details are guaranteed, they cannot be relied upon for any purpose and they do not form part of any agreement. No liability is taken for any error, omission or misstatement. A party must rely upon its own inspection(s). Powered by [www.propertybox.io](http://www.propertybox.io)

  
fox & sons



**view this property online** [fox-and-sons.co.uk/Property/YEO109109](http://fox-and-sons.co.uk/Property/YEO109109)



welcome to

## St. Michaels Road, YEOVIL

- End of Terrace Home
- Two Double Bedrooms with Built in Wardrobes
- Excellent Decorative Order
- Allocated Parking Space
- Enclosed Low Maintenance Rear Garden

Tenure: Freehold EPC Rating: C

Council Tax Band: A

# £200,000



Please note the marker reflects the postcode not the actual property

**view this property online** [fox-and-sons.co.uk/Property/YEO109109](https://fox-and-sons.co.uk/Property/YEO109109)



Property Ref:  
YEO109109 - 0003

1. MONEY LAUNDERING REGULATIONS Intending purchasers will be asked to produce identification documentation at a later stage and we would ask for your co-operation in order that there is no delay in agreeing the sale. 2. These particulars do not constitute part or all of an offer or contract. 3. The measurements indicated are supplied for guidance only and as such must be considered incorrect. Potential buyers are advised to recheck measurements before committing to any expense. 4. We have not tested any apparatus, equipment, fixtures or services and it is in the buyers interest to check the working condition of any appliances. 5. Where an EPC, or a Home Report (Scotland only) is held for this property, it is available for inspection at the branch by appointment. If you require a printed version of a Home Report, you will need to pay a reasonable production charge reflecting printing and other costs. 6. We are not able to offer an opinion either written or verbal on the content of these reports and this must be obtained from your legal representative. 7. Whilst we take care in preparing these reports, a buyer should ensure that his/her legal representative confirms as soon as possible all matters relating to title including the extent and boundaries of the property and other important matters before exchange of contracts.

  
fox & sons



**01935 412100**



Yeovil@fox-and-sons.co.uk



14 Princes Street, YEOVIL, Somerset, BA20 1EW



**fox-and-sons.co.uk**