



Hornsey Lane Gardens, Highgate, N6

£2,850 PCM

3 2 1 D

Floor Plan

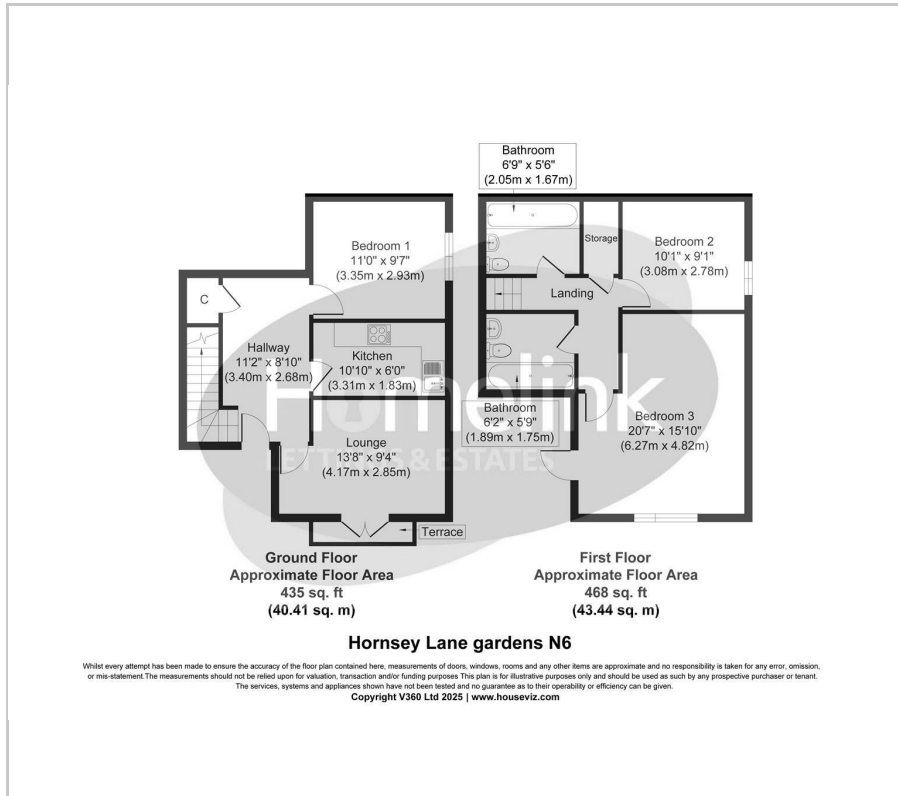

Area Map

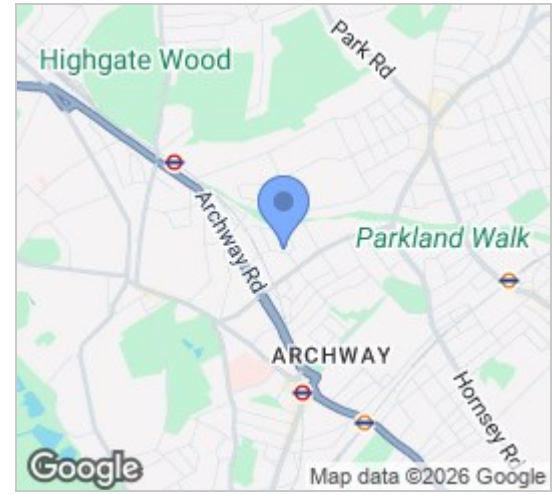

Energy Efficiency Graph

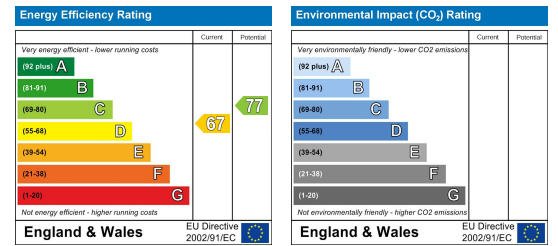

Viewing

Please contact our Homelink Lettings & Estates Office on 0208 882 2112 if you wish to arrange a viewing appointment for this property or require further information.

- Three Double Bedrooms
- Fitted Kitchen
- Private Courtyard Patio
- Ideal for Sharers
- Good Transport Links
- Separate Lounge
- Two Tiled Bathrooms
- Part Furnished
- Close to Local Amenities
- Available from 28th March

****OWN GARDEN + OWN PRIVATE ENTRANCE**** Homelink are pleased to offer for rent this split level 3 double bedroom flat situated on the borders of Highgate & Crouch End which comes with own private garden.

This elegant turreted Victorian built house offers a fitted kitchen with dishwasher, separate lounge, three great sized bedrooms, 2 tiled bathrooms and a small utility cupboard with W/M+Dryer. Other benefits include wood effect flooring and gas central heating. This property makes the ideal home for sharers.

This property is ideally located in the heart of Highgate, and is within walking distance to both Archway and Highgate tube stations. To arrange a viewing, call and and speak to one of our friendly lettings team.

Haringey C/Tax Band - E
2025/26 C/Tax - £2,698.59



These particulars, whilst believed to be accurate are set out as a general outline only for guidance and do not constitute any part of an offer or contract. Intending purchasers should not rely on them as statements of representation of fact, but must satisfy themselves by inspection or otherwise as to their accuracy. No person in this firm's employment has the authority to make or give any representation or warranty in respect of the property.

Homelink Lettings and Estates
62 Chase Side, London N14 5PA
0208 882 2112 homelink.co.uk

