



Wells Crescent, Viaduct Road, Chelmsford CM1 1GR

welcome to

Wells Crescent Viaduct Road, Chelmsford

33% Shared Ownership Located in the heart of Chelmsford City Centre, this well-presented two-bedroom apartment is offered with no onward chain. The property features spacious open-plan living and benefits from allocated parking. Early viewing is highly recommended.

Agents Note:

Lease: 99 years from 1 November 2007

Lease: 83 years remaining (vendors renewing lease to 99 years upon completion)

Current Ground Rent: NIL

Service Charge - £177.40 PCM

Reserve fund - £64.07 PCM

Management Fee - £23 PCM

Rent (applicable to share): £364.94 PCM

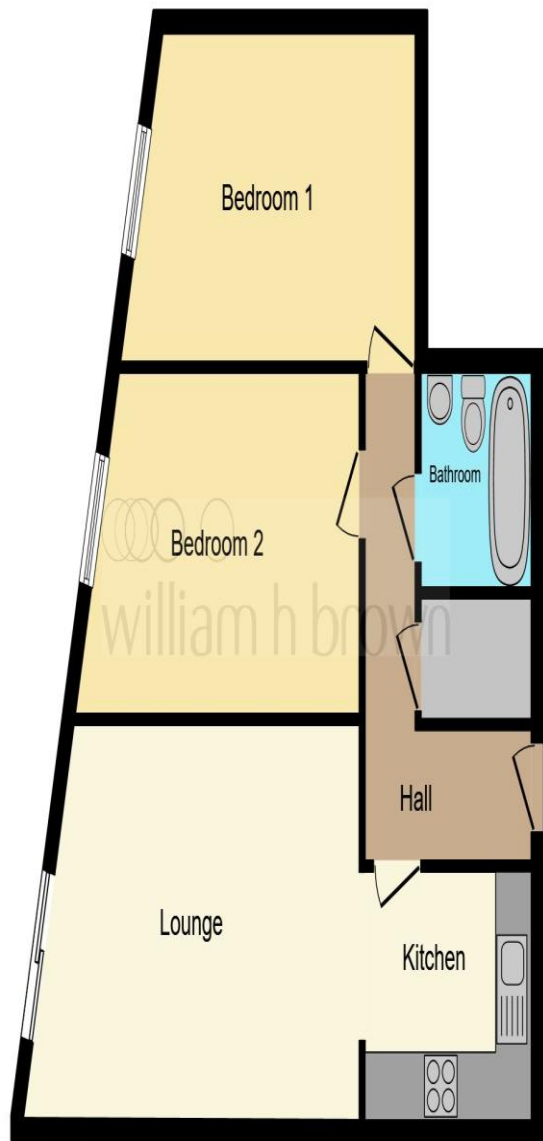

This floorplan is for illustrative purposes only and is not drawn to scale. Measurements, floor-areas, openings and orientations are approximate. They should not be relied upon for any purpose and do not form any part of an agreement. No liability is taken for any error or mis-statement. All parties must rely on their own inspections.



welcome to
Wells Crescent Viaduct Road,
Chelmsford

- Two bedrooms
- Allocated underground parking
- NO ONWARD CHAIN
- 33% Shared ownership
- City centre

Tenure: Leasehold EPC Rating: B
Council Tax Band: D Service Charge: 2128.80
Ground Rent: Ask Agent

This is a Leasehold property with details as follows; Term of Lease 99 years from 01 Nov 2007.
Should you require further information please contact the branch. Please Note additional fees could be incurred for items such as Leasehold packs.

shared ownership

£80,000



view this property online williamhbrown.co.uk/Property/CHE116129



Property Ref:
CHE116129 - 0003

1. MONEY LAUNDERING REGULATIONS Intending purchasers will be asked to produce identification documentation at a later stage and we would ask for your co-operation in order that there is no delay in agreeing the sale. 2. These particulars do not constitute part or all of an offer or contract. 3. The measurements indicated are supplied for guidance only and as such must be considered incorrect. Potential buyers are advised to recheck measurements before committing to any expense. 4. We have not tested any apparatus, equipment, fixtures or services and it is in the buyers interest to check the working condition of any appliances. 5. Where an EPC, or a Home Report (Scotland only) is held for this property, it is available for inspection at the branch by appointment. If you require a printed version of a Home Report, you will need to pay a reasonable production charge reflecting printing and other costs. 6. We are not able to offer an opinion either written or verbal on the content of these reports and this must be obtained from your legal representative. 7. Whilst we take care in preparing these reports, a buyer should ensure that his/her legal representative confirms as soon as possible all matters relating to title including the extent and boundaries of the property and other important matters before exchange of contracts.

William H Brown is a trading name of Sequence (UK) Limited which is registered in England and Wales under company number 4268443, Registered Office is Cumbria House, 16-20 Hockliffe Street, Leighton Buzzard, Bedfordshire, LU7 1GN. VAT Registration Number is 500 2481 05.



william h brown



01245 262266



Chelmsford@williamhbrown.co.uk



12 Duke Street, CHELMSFORD, Essex, CM1 1HL



williamhbrown.co.uk