

Willowherb Road

LYDE GREEN

APPROXIMATE FLOOR AREA
73.1 SQM / 787 SQFT



GARAGE (NOT IN SITU)
0 sq.ft. (0.0 sq.m.) approx.

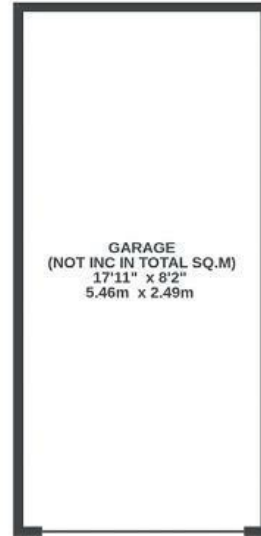

GROUND FLOOR
400 sq.ft. (37.2 sq.m.) approx.

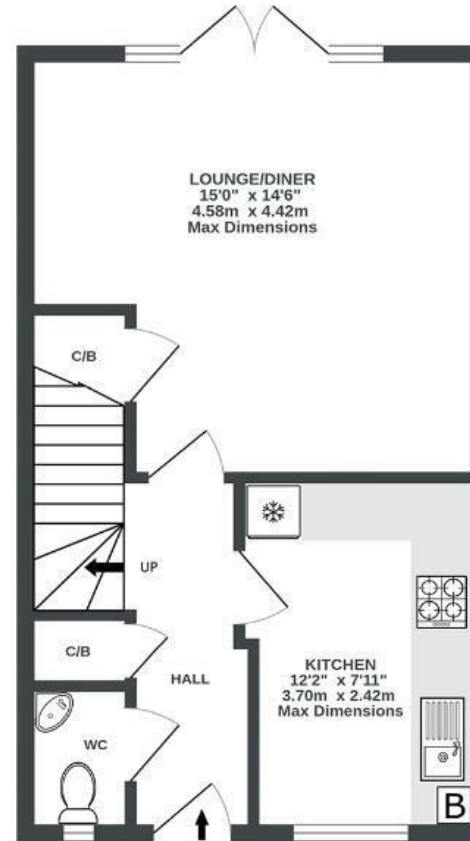

1ST FLOOR
387 sq.ft. (35.9 sq.m.) approx.



TOTAL FLOOR AREA : 787 sq.ft. (73.1 sq.m.) approx.

Whilst every attempt has been made to ensure the accuracy of the floorplan contained here, measurements of doors, windows, rooms and any other items are approximate and no responsibility is taken for any error, omission or mis-statement. This plan is for illustrative purposes only and should be used as such by any prospective purchaser. The services, systems and appliances shown have not been tested and no guarantee as to their operability or efficiency can be given.

Made with Metropix ©2026

Illustrations are for reference purposes only, measurements are approximate, not to scale.

Boardwalk

Willowherb

LYDE GREEN, BRISTOL



£350,000



3 Bedrooms



BS16 7FP



2 Bathrooms

"We love spending sunny days enjoying a BBQ in the garden and eating 'al fresco' watching the sunset. At the weekend we take walks along the cycle path which is on our doorstep. We're a short walk away from a nice new Italian restaurant in Lyde, and at the weekend we love having brunch at Avenue Cafe. There's lots of choice of parks in walking distance from us which is fab for our young son."

