



Connells

Hobart Road
Tipton



Property Description

Connells Estate Agents in Wednesbury are delighted to present this well-appointed three bedroom semi detached home, ideally situated on a modern development in Tipton, Beautifully maintained and ready to move in to, this property is perfectly suited to first time buyers and investors alike.

The ground floor offers a spacious and inviting lounge, along with a contemporary fully fitted kitchen featuring a breakfast bar, plumbing for utilities, and French doors opening onto the rear garden - creating an ideal space for both everyday living and entertaining. A convenient downstairs WC completes the ground floor.

Upstairs, the property comprises three well proportioned bedrooms and a stylish, modern family bathroom.

Externally, the home benefits from off road parking and a well maintained rear garden, complete with patio area, lawn and useful side access,

Entrance Hallway

Having a double glazed entrance door to the front aspect, laminate flooring, ceiling light point, radiator, stairs to the first floor and doors to the understairs storage cupboard, kitchen and lounge.

Lounge

11' 6" x 11' 3" (3.51m x 3.43m)
Having a double glazed window to the front aspect, carpeted flooring, ceiling light point and a radiator.

Kitchen

16' x 8' (4.88m x 2.44m)
Being a fully fitted kitchen with a range of wall, base and drawer units with laminate worktops over. Having a double glazed window to the rear aspect, laminate flooring, tiled splash backs, radiator, two ceiling light point, electric oven and hob with cooker hood over, plumbing for a washing machine, a breakfast bar, door to the WC and double glazed French doors leading to the rear garden.

Wc

Having a double glazed window to the rear aspect, WC, wash hand basin, vinyl flooring, ceiling light point and a radiator.

First Floor

Landing

Having carpeted flooring, ceiling light point and doors leading to the bedrooms and bathroom.

Bedroom One

14' 1" x 8' 2" (4.29m x 2.49m)
Having a double glazed window to the front aspect, carpeted flooring, ceiling light point, radiator and a storage cupboard.

Bedroom Two

11' 1" x 6' 7" (3.38m x 2.01m)
Having a double glazed window to the rear aspect, carpeted flooring, ceiling light point and a radiator.

Bedroom Three

Having a double glazed window to the rear aspect, carpeted flooring, ceiling light point and a radiator.

Bathroom

Having a double glazed window to the rear aspect, a bath with shower over, wash hand basin, WC, vinyl flooring, ceiling light point and a radiator.



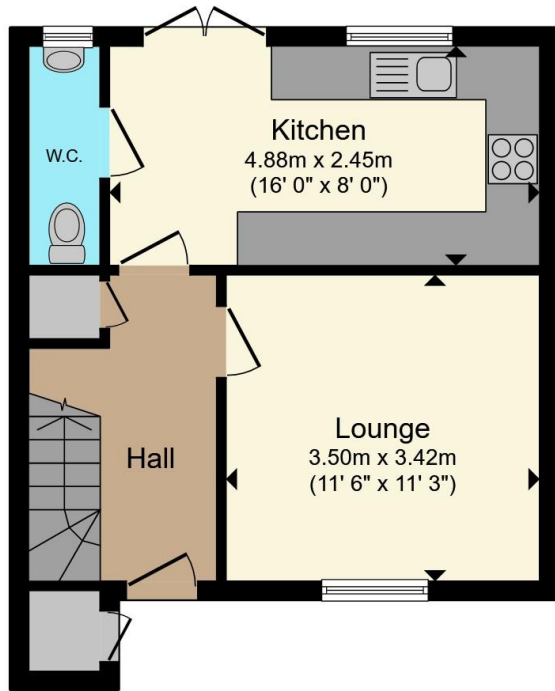

Ground Floor

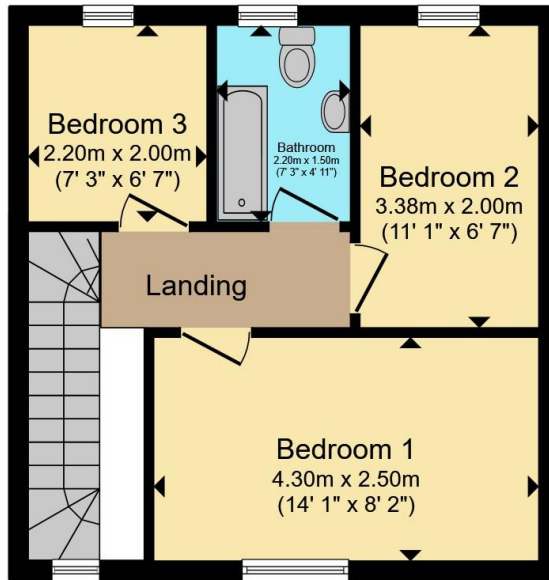

First Floor

Total floor area 68.9 m² (742 sq.ft.) approx

This floor plan is for illustrative purposes only. It is not drawn to scale. Any measurements, floor areas (including any total floor area), openings and orientation are approximate. No details are guaranteed, they cannot be relied upon for any purpose and they do not form part of any agreement. No liability is taken for any error, omission or misstatement. A party must rely upon its own inspection(s). Powered by www.propertybox.io



To view this property please contact Connells on

T 0121 556 2338
E wednesbury@connells.co.uk

22 Spring Head
 WEDNESBURY WS10 9AD

EPC Rating: C Council Tax
 Band: D

view this property online connells.co.uk/Property/WED312318

Tenure: Freehold



1. MONEY LAUNDERING REGULATIONS Intending purchasers will be asked to produce identification documentation at a later stage and we would ask for your co-operation in order that there will be no delay in agreeing the sale. 2. These particulars do not constitute part or all of an offer or contract. 3. The measurements indicated are supplied for guidance only and as such must be considered incorrect. Potential buyers are advised to recheck measurements before committing to any expense. 4. We have not tested any apparatus, equipment, fixtures, fittings or services and it is in the buyers interest to check the working condition of any appliances.

Connells Residential is registered in England and Wales under company number 1489613, Registered Office is Cumbria House, 16-20 Hockliffe Street, Leighton Buzzard, Bedfordshire, LU7 1GN. VAT Registration Number is 500 2481 05.

See all our properties at www.connells.co.uk | www.rightmove.co.uk | www.zoopla.co.uk

Property Ref: WED312318 - 0002