

FREEHOLD



House - Semi-Detached

THREE DOUBLE BEDROOMS | HOME OFFICE | LARGE GARDEN | GARAGE &

Offers In Excess Of

£625,000

FEATURES

- Three Double Bedrooms
- Two Bathrooms (One En-Suite)
- Spacious Living/Dining Room
- Large Rear Garden
- Semi-Detached Family Home
- Downstairs W.C.
- Home Office
- Potential to Extend S.T.P.P.



SPACE
RESIDENTIAL

3 Bedroom House - Semi-Detached located in Edgware

Space Residential are delighted to present this spacious three double bedroom semi-detached family home, ideally located within easy reach of Edgware Town Centre, local schools and excellent transport links.

The property offers well-balanced accommodation throughout, comprising a bright and spacious living/dining room, a well-appointed kitchen and a versatile home office, perfect for those working remotely. A convenient guest W.C. completes the ground floor.

Upstairs, the property boasts three double bedrooms, with the principal bedroom benefiting from an en-suite bathroom. A modern family bathroom serves the remaining bedrooms, making the home ideally suited to growing families.

Externally, the property enjoys a generous rear garden, ideal for entertaining and family life, together with a garage and excellent potential to extend to the rear and into the loft, subject to the necessary planning permissions.

Call us on

0208 906 2222

info@spaceresidential.com

spaceresidential.com

Council Tax Band

E

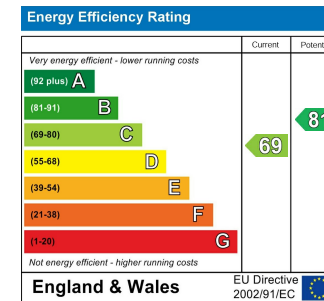
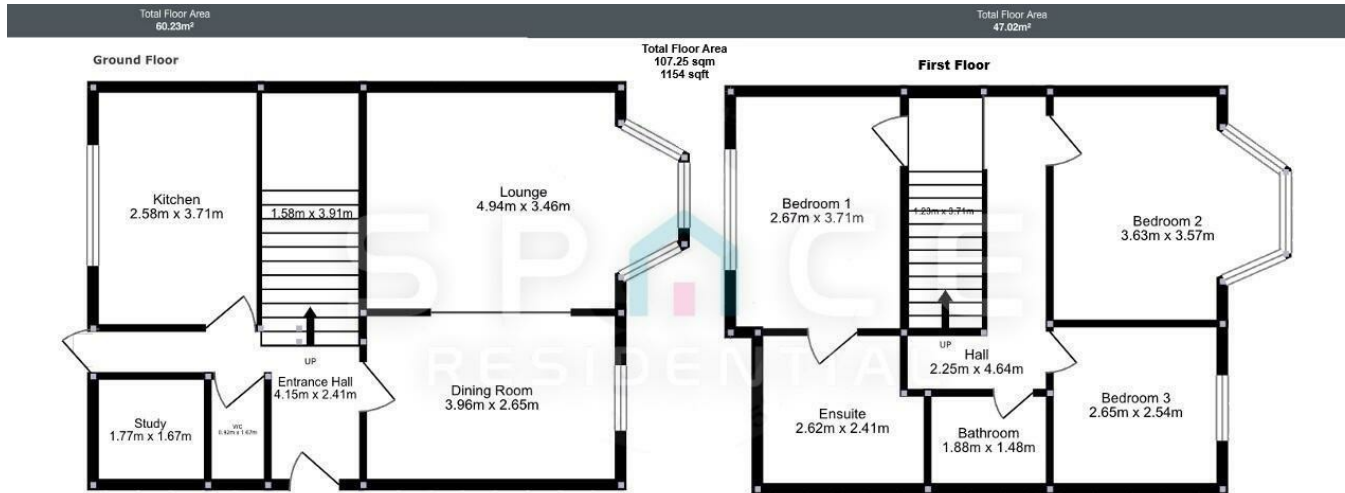

Agents Note: Whilst every care has been taken to prepare these particulars, they are for guidance purposes only. All measurements are approximate and are for general guidance purposes only and whilst every care has been taken to ensure their accuracy, they should not be relied upon and potential buyers are advised to recheck the measurements.

