



Charteris Road, NW6

Leasehold - £375,000

A well-presented two-bedroom First Floor conversion, offering 548 sq ft of living space within a charming Victorian three-storey converted building on the sought-after Charteris Road.

The property boasts a spacious open-plan reception room/kitchen area, enhanced by large windows that flood the space with natural light and two generously sized bedrooms, one benefiting from a private en-suite, alongside a three-piece family bathroom.

Charteris Road is a quiet and secluded residential street just east of Queen's Park. Residents enjoy easy access to the vibrant amenities of Queen's Park and Kensal Rise, as well as the nearby Charteris Sports Centre. Transport links include Queen's Park station (Bakerloo & Overground – Zone 2). Early viewing is highly recommended

- Victorian 2 bedroom conversion flat on First Floor
- 548 sq ft of living space
- Large reception room, modern kitchen and bathroom
- Excellent transport links
- Council: Brent (D)

020 7328 2828

enquiries@cameronsstiff.co.uk

cameronsstiff.co.uk







Charteris Road, London, NW6

Approximate Area = 548 sq ft / 50.9 sq m

For identification only - Not to scale

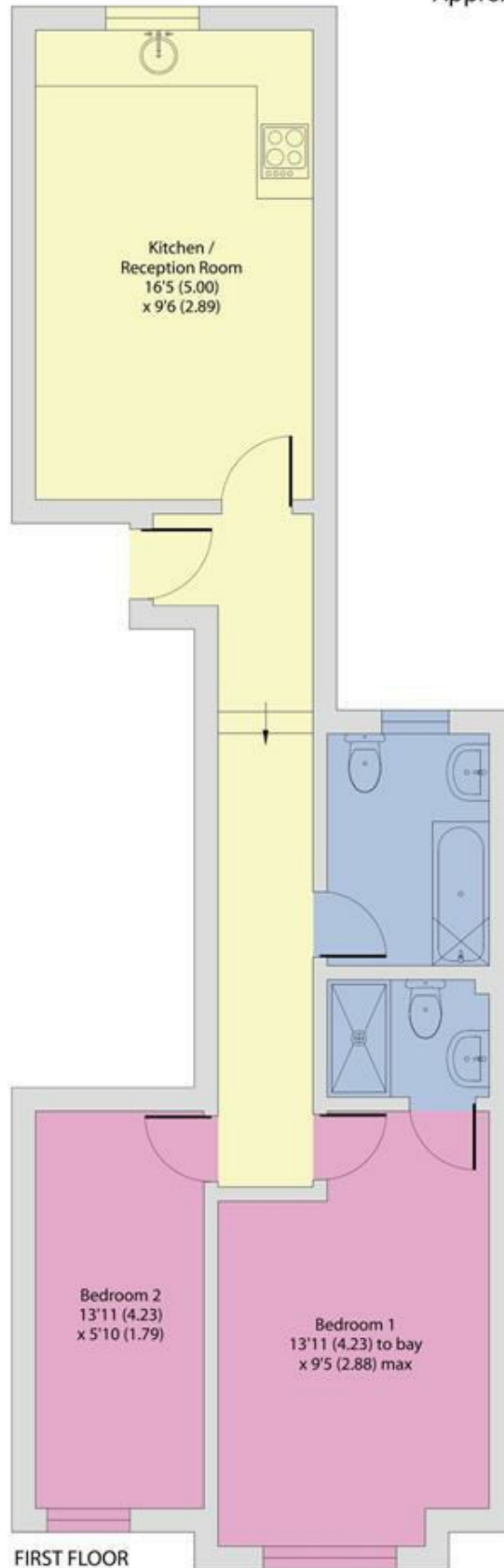

EPC: D

Ref: 19239917



Floor plan produced in accordance with RICS Property Measurement 2nd Edition, Incorporating International Property Measurement Standards (IPMS2 Residential). © nichecom 2025. Produced for Camerons Stiff & Co. REF: 1247777

