



## Millharbour, E14

£325,000

A recently refurbished one bedroom apartment on the seventh floor of this dockside development. This bright apartment has an open plan reception room, wooden flooring and a dock facing balcony.

Millharbour is moments away from the bars and restaurants of South Quay, including the popular Lotus Floating Restaurant.

### Features

- 511.6 Square Feet
- One Bedroom
- Two Bathrooms
- Seventh Floor
- Concierge
- Dock views

# Millharbour, London, E14

## Seventh Floor

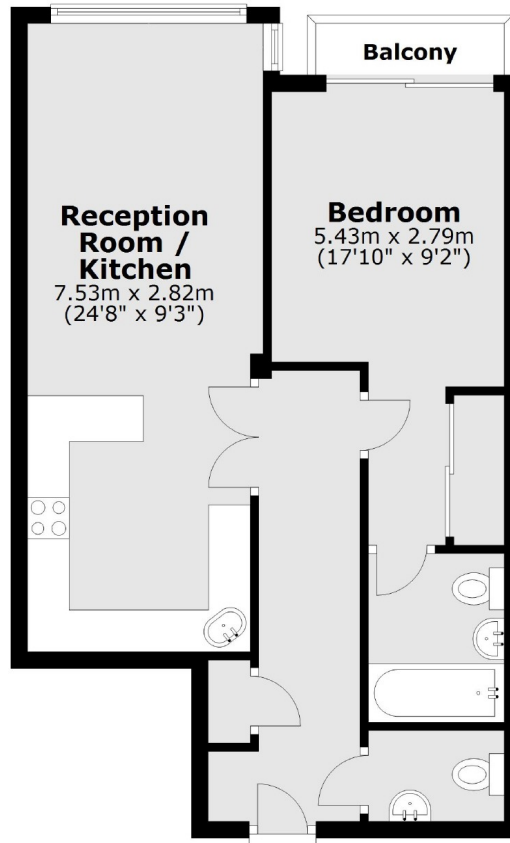

Total area: approx. 47.5 sq. metres (511.6 sq. feet)