

ALLDAY
& MILLER



Trevor Crescent, Ruislip, HA4 6ND
£350,000

2 1 1 C



Trevor Crescent, Ruislip, HA4 6ND

£350,000

- Ground Floor Maisonette
- Close To Ruislip Gardens Train Station
- Direct Access To A Private Rear Garden
- Ideal For First Time Buyers / Investors
- Two Double Bedrooms
- Purpose Built.
- Modern Kitchen Breakfast Room
- Excellent Condition Throughout

Description

This well presented home offers a delightful blend of modern living and comfort. Upon entering, you are greeted by a bright and airy reception room, which serves as an inviting space for relaxation, a sleek fitted kitchen and dining room.

This property boasts two spacious bedrooms, providing ample room for rest and personal space. The modern bathroom is tastefully appointed completing this home.

To the rear enjoys a private rear garden perfect for outdoor entertainment.

Situation

Trevor Crescent is well positioned for amenities of South Ruislip, Ruislip Gardens and Eastcote. Local transport links are available from nearby Ruislip Gardens train station offering the Central lines into London. Ruislip Manor station is a short drive or stroll away and is useful for the Metropolitan/Piccadilly line providing reliable links into the City. For the motorist the A40/M25 is a short drive away whilst for families, there are a number of highly regarded schools that cater for children of all ages within close proximity including St Swithun Wells, Ruislip High, Newnham Primary and Queensmead Secondary school.



Floor Plans

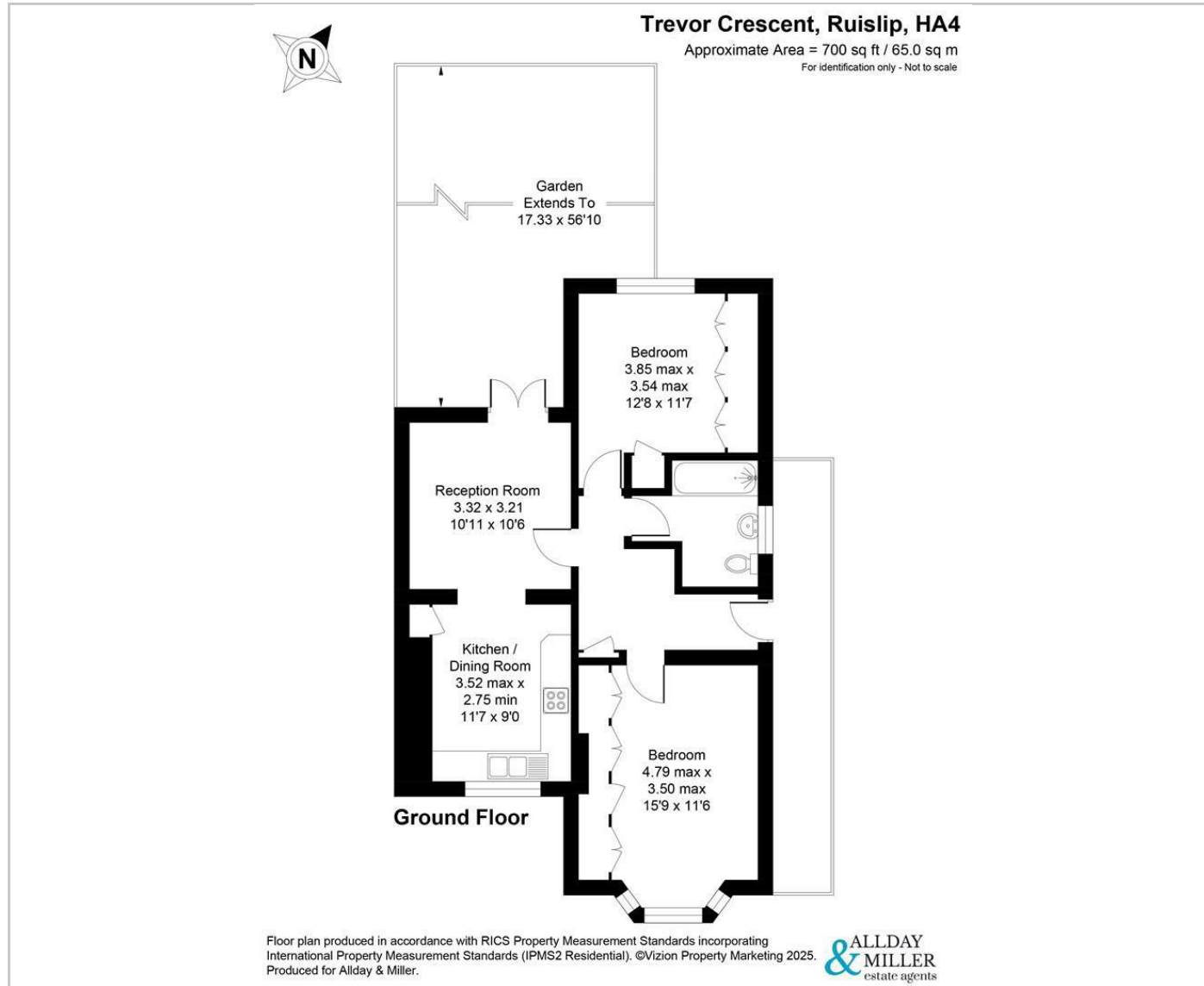

Area Map

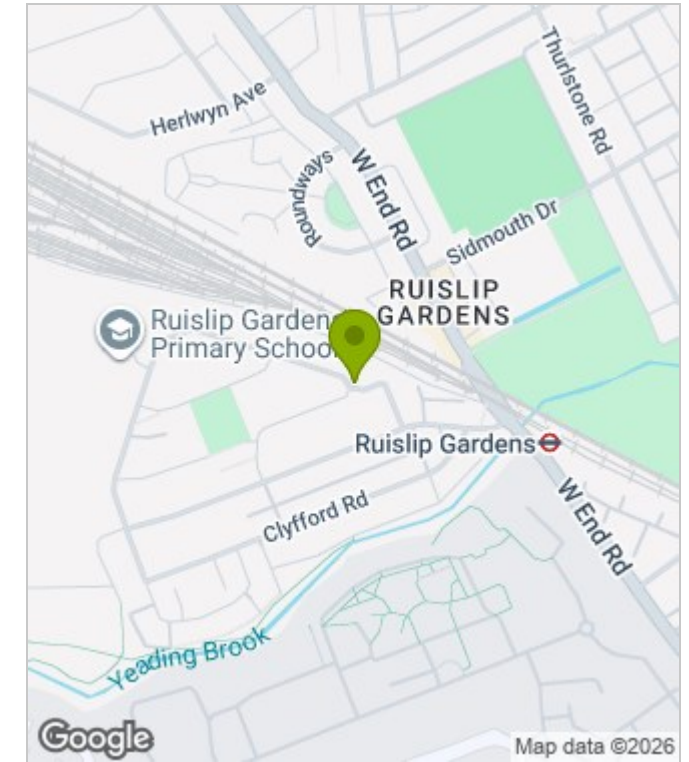

Energy Performance Graph

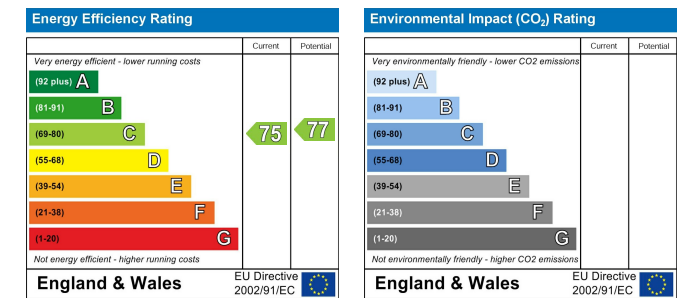

These particulars, whilst believed to be accurate are set out as a general outline only for guidance and do not constitute any part of an offer or contract. Intending purchasers should not rely on them as statements of representation of fact, but must satisfy themselves by inspection or otherwise as to their accuracy. No person in this firm's employment has the authority to make or give any representation or warranty in respect of the property.