



**JAMES  
ANDERSON**







## TO LET

Hayward Gardens, Putney, SW15

**£1,995 Per Month**

Per Month

This welcoming and cheerful home offers two double bedrooms with built in wardrobes, a modern bathroom and smart fitted kitchen. The reception room offers lots of natural light and a balcony that overlooks the leafy Putney Heath. In addition to these great features the apartment also boasts a perfect work from home space making this home a very attractive option for any Tenant. Transport, shopping and schools are all close by.

-  Two Double Bedrooms
-  Modern Bathroom
-  Bright Reception
-  Good Size Kitchen
-  EPC E / Council Tax B / Holding Deposit £460.38
-  Putney Train Station
-  Putney High School
-  Balcony Overlooking Heath
-  Close to Parks
-  Deposit £2301.92



OPEN 7 DAYS A WEEK • Weekdays until 9pm • Weekends until 5pm

**0208 785 4400**

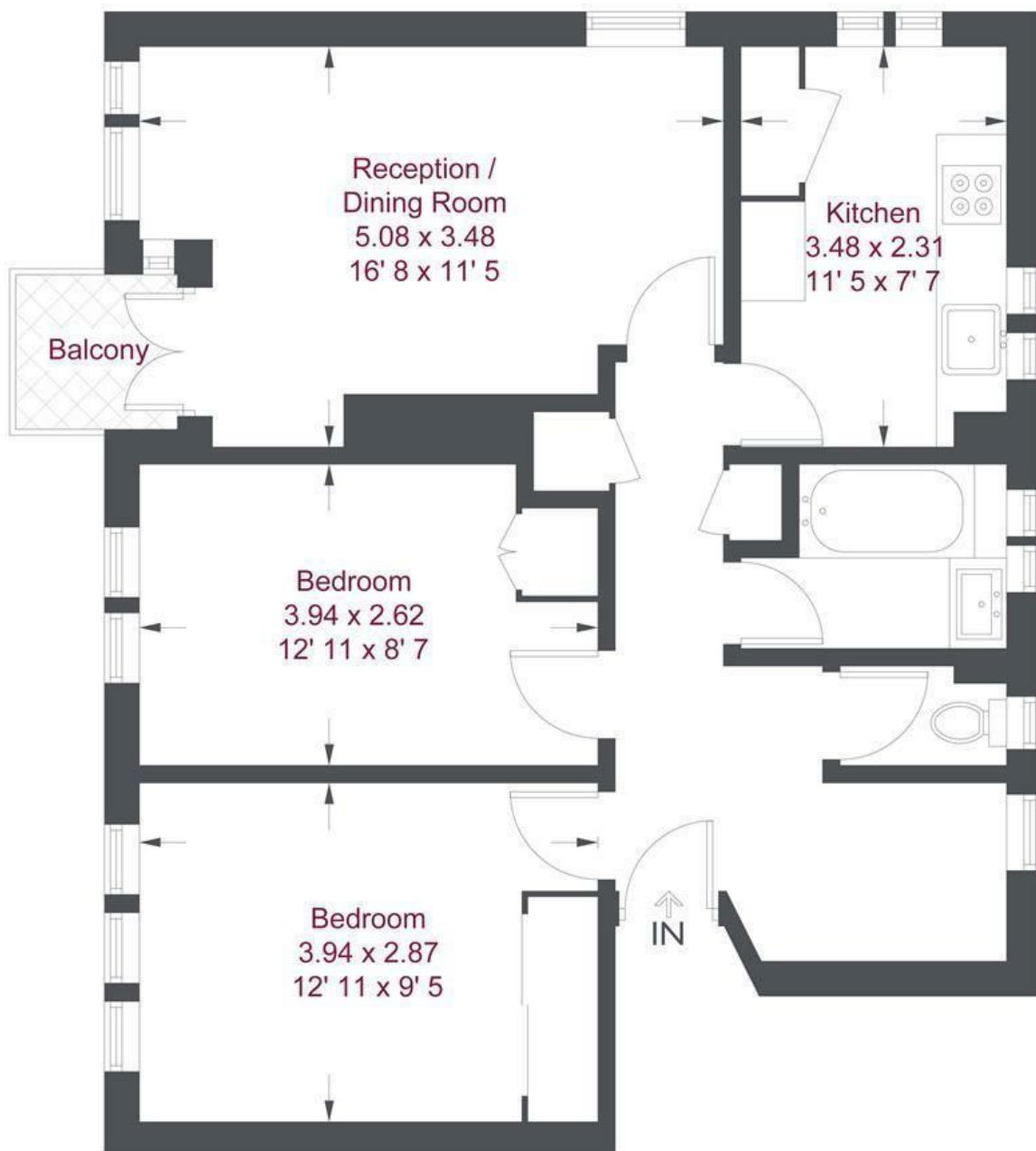

## Second Floor

### Hayward Gardens

Approximate Gross Internal Area = 687 sq ft / 63.8 sq m

Not to scale, for guidance only and must not be relied upon as a statement of fact  
All measurements and areas are approximate only and have been prepared in accordance with the current edition of the RICS Code of Measuring Practice

Energy Efficiency Rating		
	Current	Potential
Very energy efficient - lower running costs		
(92 plus) <b>A</b>		<b>82</b>
(81-91) <b>B</b>		
(69-80) <b>C</b>		
(55-68) <b>D</b>		
(39-54) <b>E</b>	<b>53</b>	
(21-38) <b>F</b>		
(1-20) <b>G</b>		
Not energy efficient - higher running costs		
<b>England &amp; Wales</b>	EU Directive 2002/91/EC	

Environmental Impact (CO <sub>2</sub> ) Rating		
	Current	Potential
Very environmentally friendly - lower CO <sub>2</sub> emissions		
(92 plus) <b>A</b>		
(81-91) <b>B</b>		
(69-80) <b>C</b>		
(55-68) <b>D</b>		
(39-54) <b>E</b>		
(21-38) <b>F</b>		
(1-20) <b>G</b>		
Not environmentally friendly - higher CO <sub>2</sub> emissions		
<b>England &amp; Wales</b>	EU Directive 2002/91/EC	

