



Minehead TA24 8DW

Price £175,000 Leasehold



Wilkie May  
& Tuckwood

# Floorplan

Approx Gross Internal Area  
58 sq m / 626 sq ft

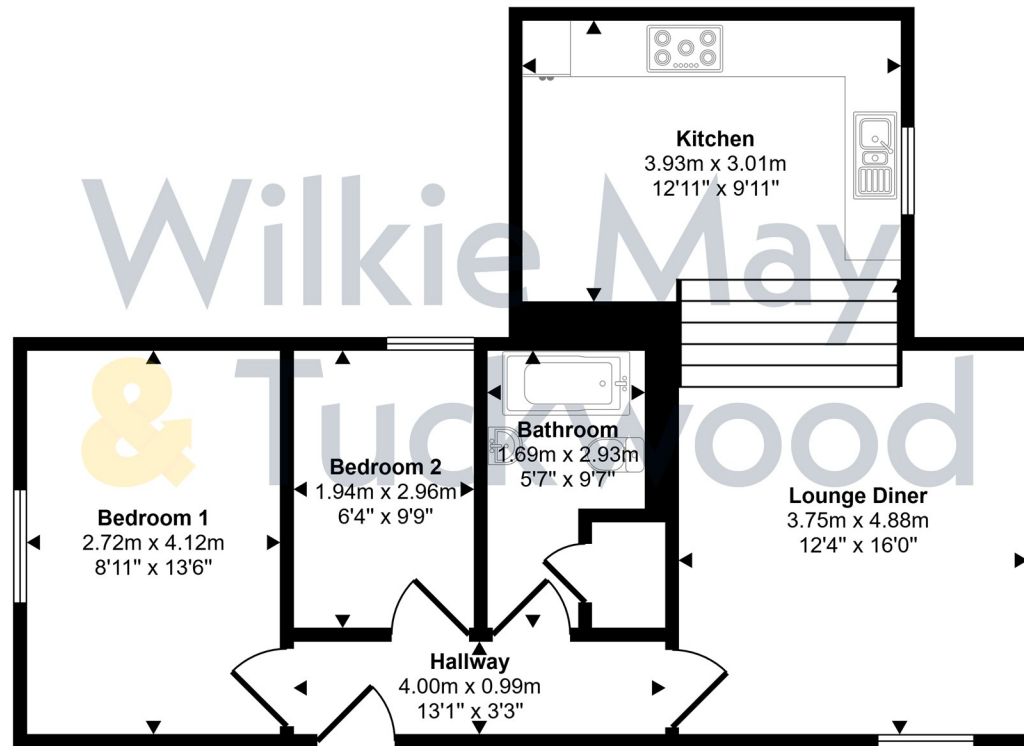

Floorplan

This floorplan is only for illustrative purposes and is not to scale. Measurements of rooms, doors, windows, and any items are approximate and no responsibility is taken for any error, omission or mis-statement. Icons of items such as bathroom suites are representations only and may not look like the real items. Made with Made Snappy 360.



# Description

**FORMING PART OF A STUNNING GRADE II LISTED PROPERTY – a very attractive two-bedroom ground floor apartment with allocated parking space.**

**This beautiful Grade II listed property has been lovingly converted by local developer Ware to provide fourteen one, two and three-bedroom apartments and one, two-bedroom coach house, the majority of which retain the original stone mullion windows and two of which retain original fireplaces.**

- Stunning two bedroom apartment
- Forms part of a beautiful Grade II listed building
- Allocated parking space
- Lovely views towards North Hill
- Beautiful communal gardens
- Quality fitted kitchen and bathroom



Wilkie May & Tuckwood are delighted to be able to offer this newly converted two-bedroom apartment. The accommodation comprises in brief: access up impressive flight of stairs on the right hand side of the house through front door into communal hallway with door into the apartment.

From the hallway doors open to the lounge/diner, bedrooms and bathroom. The lounge/diner is a lovely double aspect room which retains one set of mullioned windows and has steps leading down to the kitchen. The kitchen is fitted with a modern range of wall and base units, sink and drainer incorporated into work surface and fitted appliances to include electric oven and hob with extractor hood over, dishwasher and fridge/freezer. There is also space and plumbing for a washer/dryer and a window to the side.

There are also two bedrooms and a bathroom fitted with a modern three piece suite.



Positioned as it is in the building, this property also enjoys lovely views over the communal gardens towards North Hill.

Outside, the communal gardens are to the side and rear and predominantly laid to lawn with seating areas.

The property also has one allocated parking space.

AGENTS NOTE: The property is leasehold and will be held under the terms of a new 999 year lease. A management company will be set up to deal with the maintenance of the gardens and parking area, the maintenance and cleaning of the common areas of the building and the insurance of the whole building. There will be an initial service charge payable of approximately £100 per month.



## GENERAL REMARKS AND STIPULATIONS:

**Tenure:** Leasehold

**Services:** Mains electricity and drainage

**Local Authority:**

**Property Location:** [///samples.diggers.socialite](https://samples.diggers.socialite) **Council Tax Band:** New Build

**Broadband and mobile coverage:** Download: 1800 Mbps Upload: 220 Mbps. There is good mobile coverage.

**Flood Risk:** Surface Water: Very low **Rivers and sea:** Very low **Groundwater:** Location is outside of a groundwater flood alert area **Reservoirs:** Unlikely  
**Planning:** We recommend you check the local planning authority website <https://www.somerset.gov.uk/planning-buildings-and-land/view-and-comment-on->

IMPORTANT NOTICE Wilkie May & Tuckwood for themselves and for the vendors of the property, whose agents they are, give notice that: 1. the particulars are intended to give a fair and substantially correct overall description for the guidance of intending purchaser and do not constitute part of an offer or contract. Prospective purchasers and lessees ought to seek their own professional advice. 2. All descriptions, dimensions, areas, reference to condition and necessary permissions for use and occupation and other details are given in good faith, and are believed to be correct, but any intending purchasers should not rely on them as statements or representations of fact, but must satisfy themselves by inspection or otherwise as to the correctness of each of them. 3. No person in the employment of Wilkie May & Tuckwood has any authority to make or give any representations or warranty whatever in relation to this property on behalf of Wilkie May & Tuckwood, nor enter into any contract on behalf of the vendor. 4. No responsibility can be accepted for any expenses incurred by intending purchasers in inspecting properties which have been sold, let or withdrawn. Photographs taken and details prepared 8th January 2026.  
MEASUREMENTS AND OTHER INFORMATION All measurements are approximate. While we endeavour to make our sales particular accurate and reliable, if there is any point which is of particular importance to you, please contact the office and we will be pleased to check the information with you.

Code of Practice for Residential Estate Agents: Effective from 1 August 2011:

'8. Financial Evaluation 8a At the time that an offer has been made and is being considered by the seller, you must take reasonable steps to find out from the prospective buyer the source and availability of his funds for buying the property and pass this information to the seller. Such information will include whether the prospective buyer needs to sell a property, requires a mortgage, claims to be a cash buyer or any combination of these. Such relevant information that is available should be included in the Memorandum of Sale having regard to the provisions of the Data Protection Act.8b These reasonable steps must continue after acceptance of the offer until exchange of contracts (in Scotland, conclusion of missives) and must include regular monitoring of the prospective buyer's progress in achieving the funds required, and reporting such progress to the seller.

The agent has not tested any apparatus, equipment, fixtures and fittings or services and so cannot verify that they are in working order or fit for their purpose. A Buyer is advised to obtain verification from their solicitor or surveyor. References to the Tenure of the Property are based on information supplied by the Seller. The agent has not had sight of the title documents. A Buyer is advised to obtain verification from their Solicitor.



**Tel: 01643 704400**

Wilkie May & Tuckwood 6 Wellington Square, Minehead, Somerset,

TA24 6NH

