



Bavent Road | London | SE5

Share of Freehold

£470,000

- Top floor apartment
- Two bedrooms
- Very well presented
- Period features
- Private balcony
- Ruskin Park
- Brixton Tube
- Loughborough Junction
- Chain free
- Share of freehold



Set on the top floor of a well maintained building on sought after Barent Road, this bright and beautifully presented apartment offers an abundance of natural light throughout. Spacious reception room with high ceilings, a private balcony which is a real suntrap and the perfect spot for morning coffee. The property features two generous double bedrooms, a fitted kitchen which is well laid out with ample storage and workspace, while the modern bathroom includes a full-sized bath with shower over. Ideally positioned in the heart of SE5, the apartment enjoys excellent connectivity and access to some of South London's most popular amenities. King's College Hospital and Denmark Hill railway station are both within easy reach, alongside the green open spaces of Ruskin Park. Loughborough Junction

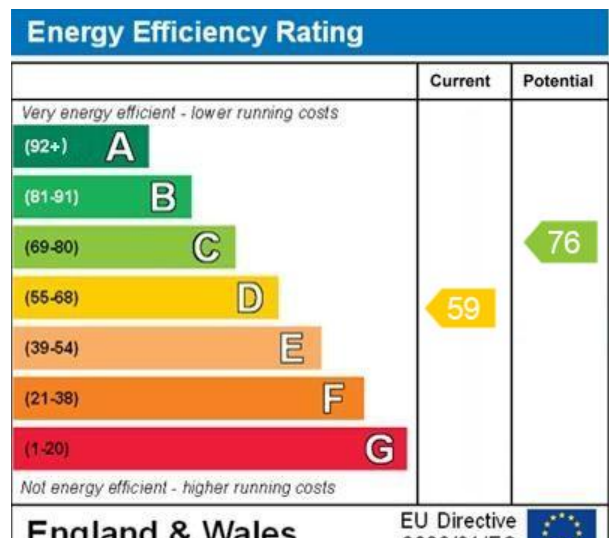

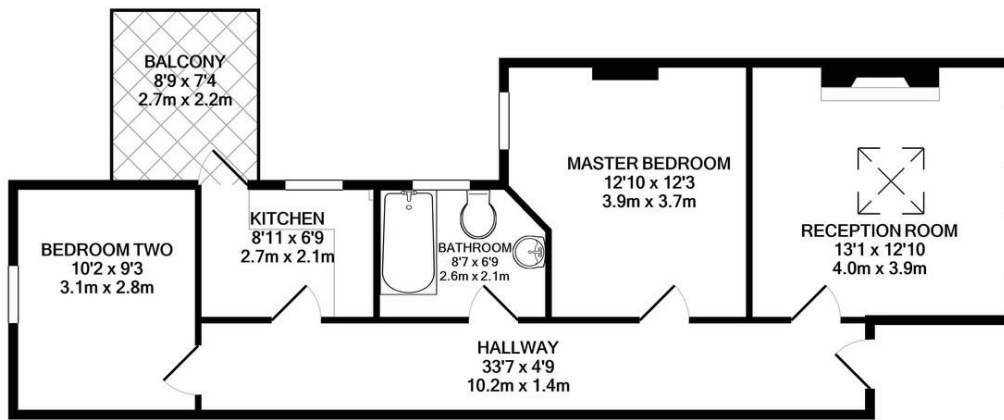

TOTAL APPROX. FLOOR AREA 692 SQ.FT. (64.3 SQ.M.)

Whilst every attempt has been made to ensure the accuracy of the floor plan contained here, measurements of doors, windows, rooms and any other items are approximate and no responsibility is taken for any error, omission, or mis-statement. This plan is for illustrative purposes only and should be used as such by any prospective purchaser. The services, systems and appliances shown have not been tested and no guarantee as to their operability or efficiency can be given
 Made with Metropix ©2021

Viewing Arrangements

Strictly by appointment

Contact Details

121 Denmark Hill

London

SE5 8EN

www.urbanvillagehomes.co.uk

sales@urbanvillagehomes.com

020 3519 9121

Agents Note: Whilst every care has been taken to prepare these sales particulars, they are for guidance purposes only. All measurements are approximate and are for general guidance purposes only and whilst every care has been taken to ensure their accuracy, they should not be relied upon and potential buyers are advised to recheck the measurements