



West Hill, SW15

£425,000

A stunning one bedroom flat, offering its own private entrance and huge terrace. The property is in excellent condition and offers a large and open plan kitchen/ reception room with floor to ceiling windows and direct access to the terrace. The double bedroom has fitted wardrobes with large windows with a view over the gardens.

The flat also comes with a private off street parking space.

Forest Lodge is set within the prestigious Sir Giles Gilbert Scott development, well-located for both East Putney and Southfields Underground Stations (District Line) as well as the A3 for an easy escape out of London.

Sir Giles Gilbert Scott is most famous for his design of the iconic red telephone box as well as other landmark buildings such as the Tate Modern and Battersea Power Station.

Features

- One Bedroom
- Private Terrace
- Private Parking Space
- Chain Free
- Access to residents gym and library
- Share of Freehold

West Hill, London, SW15

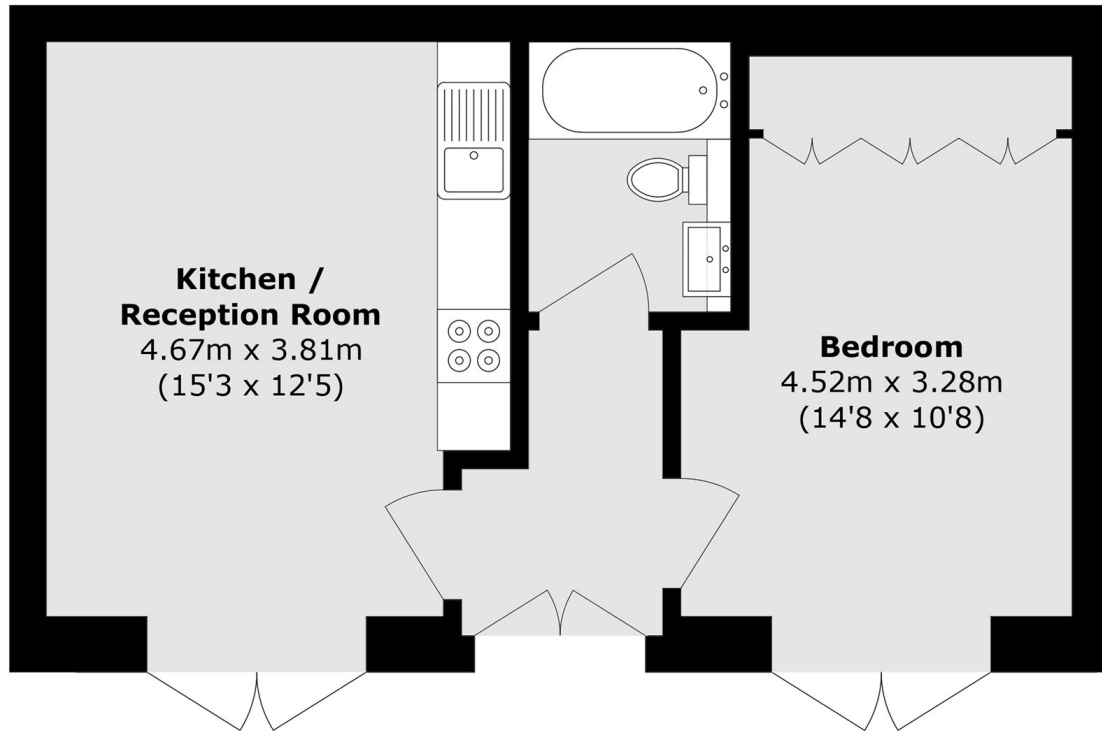

Total area (approx.): 40.6 sq. m (437.0 sq. ft)