



RE/MAX

PROPERTY HUB



2 Moreton Terrace, Exeter, EX6 7JG

Asking price £290,000

RE/MAX are delighted to bring to the market, this stunning 3 bedroom terraced house in the sought after area of Moreton Terrace, Bridford. The property has been vastly modernised and extended throughout.

Upon entering the property you are greeted with a large entrance porch and hallway, with a downstairs W/C. On the ground floor is a cosy living room with a large front aspect windows allowing an abundance of natural light. At the back of the property is an extended and modernised open plan kitchen/diner and utility room, with steps down to the rear garden.

Upstairs, all 3 bedrooms are a good size with a modern family bathroom. To the rear of the property is lovely countryside views.

There is also ample driveway parking and a garage in a block.

This lovely property is located in the popular Teign Valley village of Bridford on the edge of Dartmoor. It's set in an area of outstanding natural beauty, but also has great access to main transport links.

Floor Plan

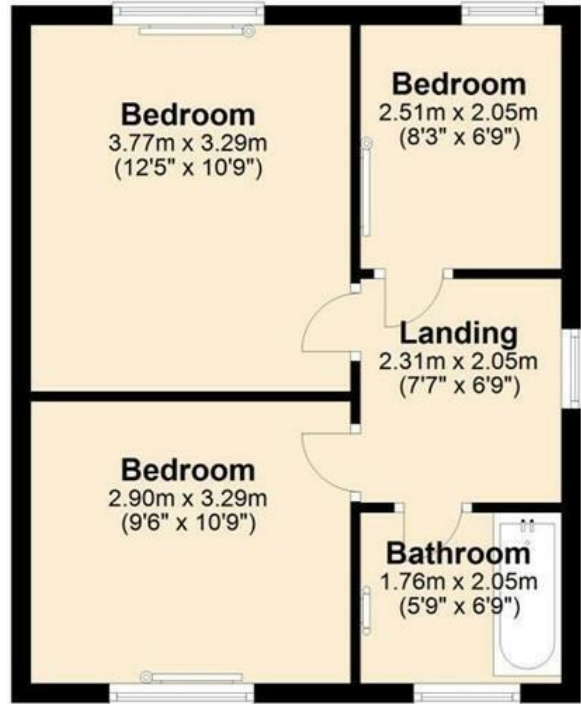
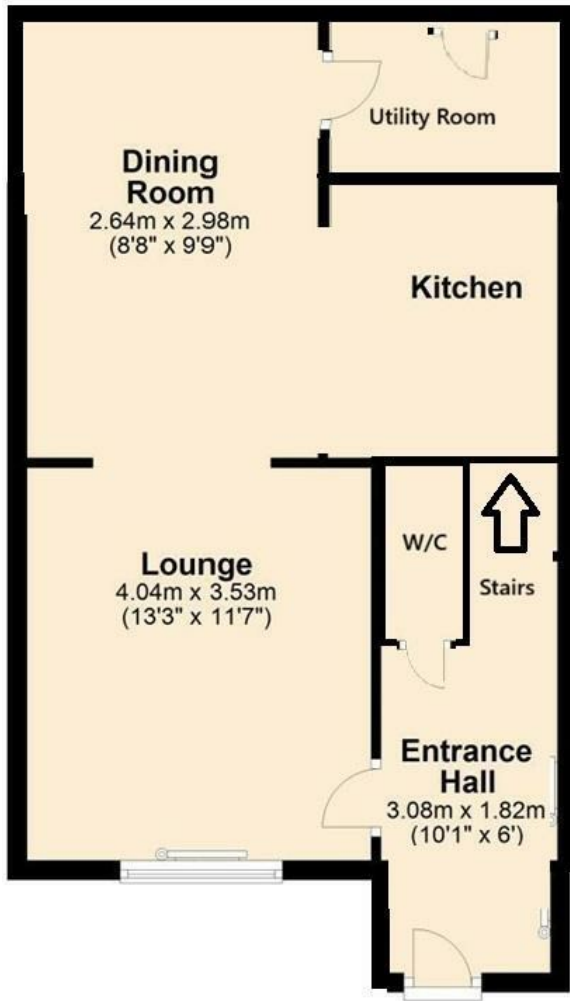

Area Map



Energy Efficiency Graph

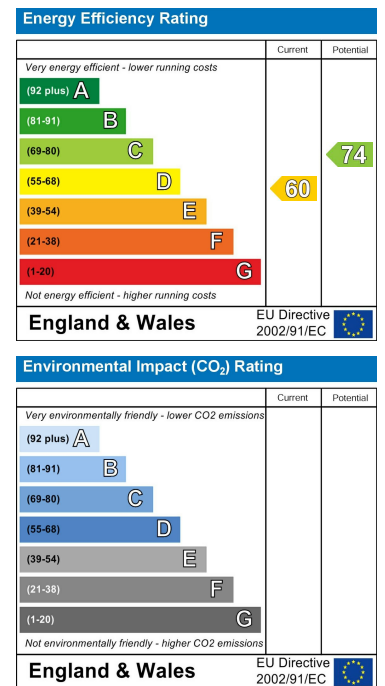

These particulars, whilst believed to be accurate are set out as a general outline only for guidance and do not constitute any part of an offer or contract. Intending purchasers should not rely on them as statements of representation of fact, but must satisfy themselves by inspection or otherwise as to their accuracy. No person in this firm's employment has the authority to make or give any representation or warranty in respect of the property.

2 Reynell Road, Newton Abbot, Devon, TQ12 6YA

Tel: 07850 038794 Email: ryan.flory@remax.uk <https://remax.uk/associates/Ryan%20Flory>