



STRAND, WC2R

£500,000

A Manhattan apartment in Marconi House spread over 392 square foot. The apartment consists of a modern spec throughout with well designed separated living and sleeping areas, modern bathroom and kitchen.

- Manhattan Studio
- Modern Design
- Prime Central London
- Temple and Holborn Stations
- 24-Hour Concierge
- Video Entry Phone



ABOUT THE HOME

Perfectly positioned near the shops, bars, and restaurants of Covent Garden, Leicester Square, and Oxford Street, the apartment offers a prime central London location with access to the city.





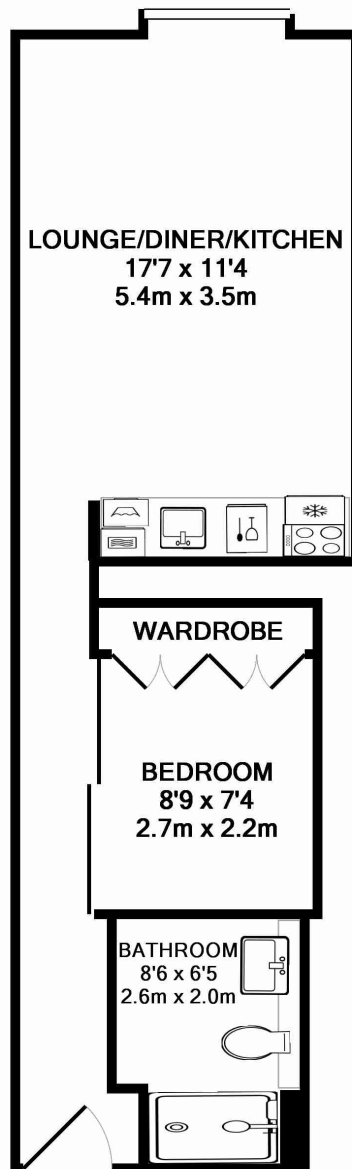

TOTAL APPROX. FLOOR AREA 392 SQ.FT. (36.4 SQ.M.)

Whilst every attempt has been made to ensure the accuracy of the floor plan contained here, measurements of doors, windows, rooms and any other items are approximate and no responsibility is taken for any error, omission, or mis-statement. This plan is for illustrative purposes only and should be used as such by any prospective purchaser. The services, systems and appliances shown have not been tested and no guarantee as to their operability or efficiency can be given
Made with Metropix ©2013

LiFE RESIDENTIAL

11 Flagstaff House, London,
SW8 2LZ

Sales: 020 7476 1408

Lettings: 020 7582 7989

Energy Rating: C. We aim to make our particulars both accurate and reliable. However they are not guaranteed; nor do they form part of an offer or contract. If you require clarification on any points then please contact us, especially if you're traveling some distance to view. Please note that appliances and heating systems have not been tested and therefore no warranties can be given as to their good working order.