



# 111 Imperial Apts South Western House, Southampton

In Excess of £120,000





## 111 Imperial Apartments South Western House Southampton, Southampton

### Description

Nested is pleased to offer this one-bedroom, first-floor apartment in the **HISTORIC** South Western House in Southampton City Centre. This Grade II listed building, dating back to 1865, presents a rare opportunity to own a stunning apartment in a beautiful and architecturally significant setting. The property boasts a concierge service, high ceilings, elegant period details, and modern comforts, creating a unique living experience. The spacious bedroom is complemented by a stylish living area and a well-appointed kitchen complete with a built-in slimline dishwasher, electric oven and hob, and space for a fridge/freezer and washing machine. Additionally, the apartment features a contemporary shower room with a double shower, WC, and sink. The apartment also comes with a gated and secure allocated parking space. With excellent transport links and the city's amenities right at your doorstep, this is a fantastic chance to own a piece of Southampton's rich history. Don't miss out—schedule a viewing today!

Anti-Money Laundering (AML) Compliance



## 111 Imperial Apartments South Western House Southampton, Southampton

In accordance with UK Anti-Money Laundering regulations, all successful buyers must complete identity and source-of-funds checks. A fee of £60 including VAT per purchase will apply. To meet these requirements, your details will be shared with a third-party AML provider, who will contact you directly to carry out the verification process. This is a legal obligation for estate agents and helps protect everyone involved in the transaction.



## 111 Imperial Apartments South Western House Southampton, Southampton

### Key Features

- Centre of Southampton
- Grade II Listed
- One Bedroom Apartment
- Concierge Service
- Ideal First Purchase or Investment Opportunity
- Shower Room
- Gated & Secure Allocated Parking

### Property Information

#### Tenure

Leasehold

#### Lease Length

98 Years Remaining

#### Ground Rent

£50 per annum

#### Annual Service Charge

£4,000 per annum

#### Council Tax

Band C



## 111 Imperial Apartments South Western House Southampton, Southampton

### **Parking**

Off-Street Parking / Secure Allocated Parking

### **Rights & Restrictions**

Private Rights of Way – No

Public Rights of Way – No

Listed Property – No

Restrictions – No

### **Flood Risk**

Property has not flooded in the last 5 years

No flood defences in place

SOUTH WESTERN HOUSE



THIS PROPERTY IS MANAGED BY  
The South Western House  
100 South Western House  
London SW10 0AA



THIS PROPERTY IS MANAGED BY  
The South Western House  
100 South Western House  
London SW10 0AA



## Energy Efficiency Rating

	Current	Potential
<i>Very energy efficient - lower running costs</i>		
(92+) <b>A</b>		
(81-91) <b>B</b>		
(69-80) <b>C</b>	<b>73</b>	<b>74</b>
(55-68) <b>D</b>		
(39-54) <b>E</b>		
(21-38) <b>F</b>		
(1-20) <b>G</b>		
<i>Not energy efficient - higher running costs</i>		

England, Scotland & Wales

EU Directive  
2002/91/EC



## Environmental Impact (CO<sub>2</sub>) Rating

	Current	Potential
<i>Very environmentally friendly - lower CO<sub>2</sub> emissions</i>		
(92+) <b>A</b>		
(81-91) <b>B</b>		
(69-80) <b>C</b>		
(55-68) <b>D</b>	<b>62</b>	<b>64</b>
(39-54) <b>E</b>		
(21-38) <b>F</b>		
(1-20) <b>G</b>		
<i>Not environmentally friendly - higher CO<sub>2</sub> emissions</i>		

England, Scotland & Wales

EU Directive  
2002/91/EC



# Imperial Apartments, South Western House, Southampton, SO14

Approximate Area = 544 sq ft / 50.5 sq m

For identification only - Not to scale

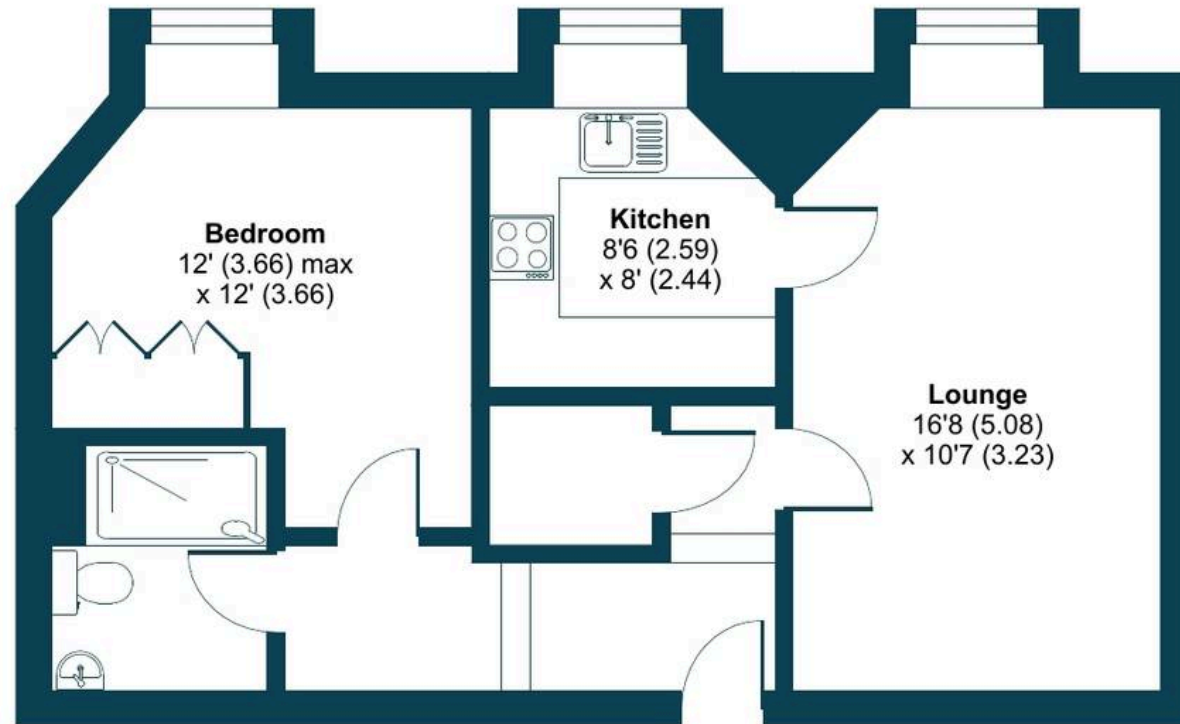

**FIRST FLOOR**



Floor plan produced in accordance with RICS Property Measurement 2nd Edition, Incorporating International Property Measurement Standards (IPMS2 Residential). © nichecom 2025. Produced for Nested. REF: 1247906





## Nested Southampton

Fora, 9 Dallington Street, London - EC1V 0LN

023 8232 0961 • [chris.schutrups@nested.com](mailto:chris.schutrups@nested.com) • [nested.com/southampton](https://nested.com/southampton)

