

Eyam Close
Desborough
Kettering
NN14 2FF

£290,000



OSCAR JAMES

...expect excellence

FLOOR PLANS

GROUND FLOOR
498 sq.ft. (46.2 sq.m.) approx.

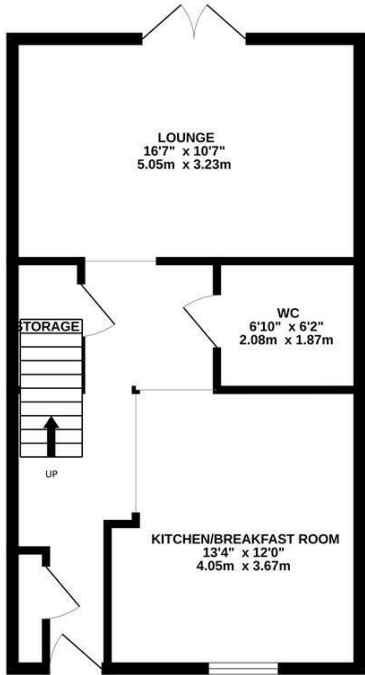

1ST FLOOR
498 sq.ft. (46.2 sq.m.) approx.

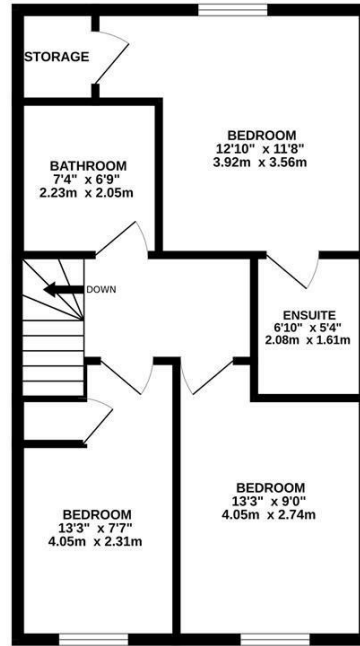

TOTAL FLOOR AREA : 995 sq.ft. (92.4 sq.m.) approx.

Whilst every attempt has been made to ensure the accuracy of the floorplan contained here, measurements of doors, windows, rooms and any other items are approximate and no responsibility is taken for any error, omission or mis-statement. This plan is for illustrative purposes only and should be used as such by any prospective purchaser. The services, systems and appliances shown have not been tested and no guarantee as to their operability or efficiency can be given.

Made with Metropix ©2026



AT A GLANCE...



custom text 1



custom text 4



custom text 2



custom text 5



custom text 3



custom text 6



WHAT'S GREAT?

A brand new development Viridian Meadows situated along a quiet road in an established residential area edge of the popular town of Desborough.

These stunning homes are built to a superb standard and offer well appointed and spacious accommodation over two floors. Promising a quality, high-end finish throughout.

This particular home is a Three bedroom detached property with superb space both downstairs and up, consisting of an welcoming and generous hallway with cloakroom, an open plan kitchen with a lovely lounge to the rear of the property.

To the first floor there are three very generous bedrooms, the master of which enjoys ensuite shower facilities and a beautifully appointed family bathroom services the remaining bedrooms.

Please Call Oscar James to arrange a viewing on the lovely BRAND NEW family home.

these photos are for illustration purposes only

...expect excellence



SELLER'S SECRET



Why we like it....

OSCAR JAMES

1 Newland Street | Kettering | NN16 8JH
01536 415777
www.oscar-james.com

To buy or not to buy....
