



Adelina Grove, E1

£350,000

Large one bedroom apartment set within a sought after location. The apartment has a spacious, bright living room and separate modernised, dine in kitchen. The property has a large double bedroom with plenty of room for storage, there is also plenty of additional storage in the hallway. The family bathroom is of a good size and leads out to the properties private balcony overlooking the development courtyard

Located a short distance from Whitechapel station (Elizabeth line, Windrush line, Hammersmith&City line), this property offers a multitude of transport links throughout the City and further afield. The green spaces of Stepney City Farm and Weavers Fields are both nearby, as well as a selection of cafés, restaurants and bars.

Features

- One bedroom
- City of London development
- Private balcony
- Large living room
- Separate kitchen
- Sought after location

Adelina Grove, London, E1

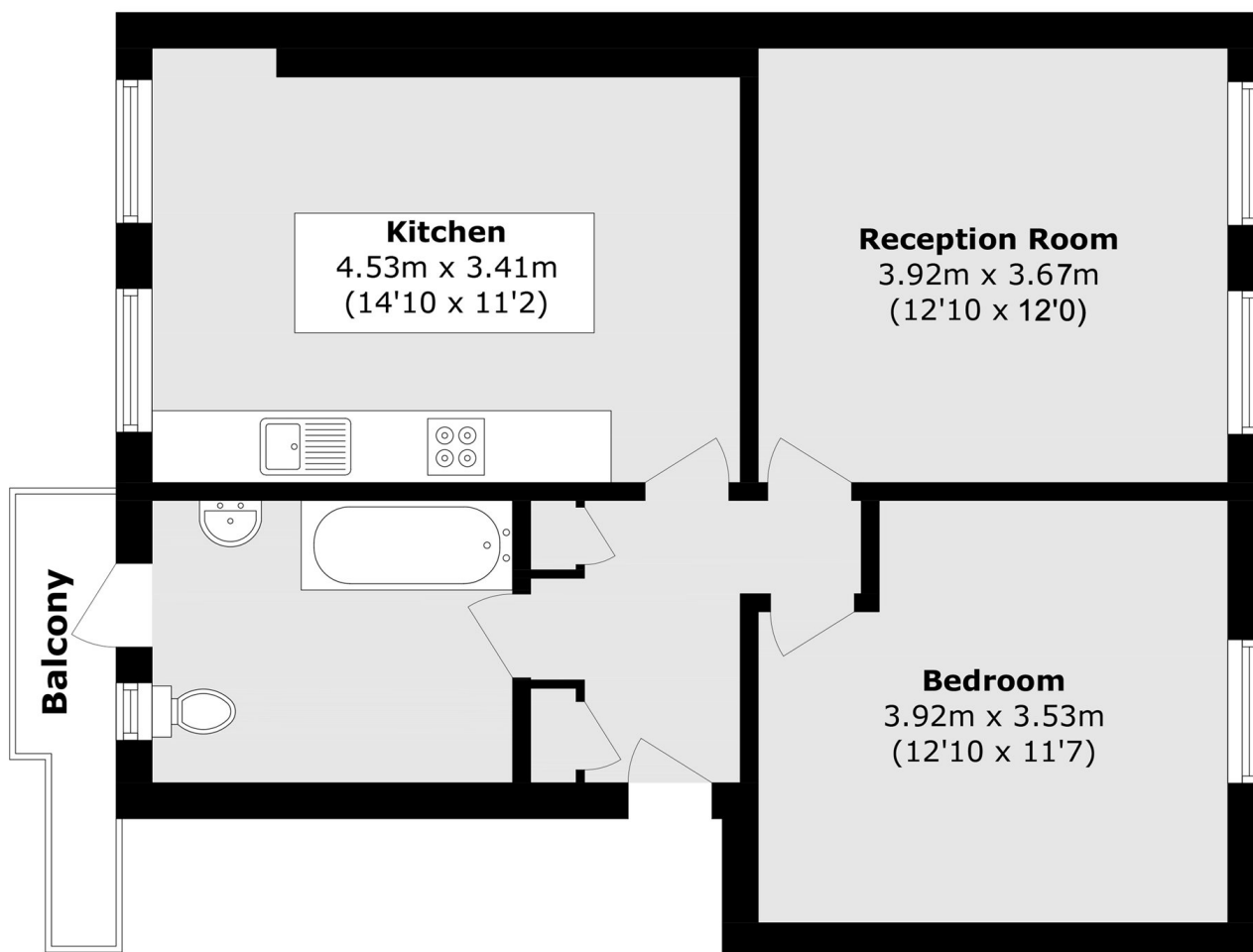

Total area (approx.): 59.7 sq. m (642.6 sq. ft)
Balcony total (approx.): 2.6 sq. m (27.9 sq. ft)