

# Stafford Road

## ST WERBURGHS

APPROXIMATE FLOOR AREA  
82 SQM / 883 SQFT



GROUND FLOOR

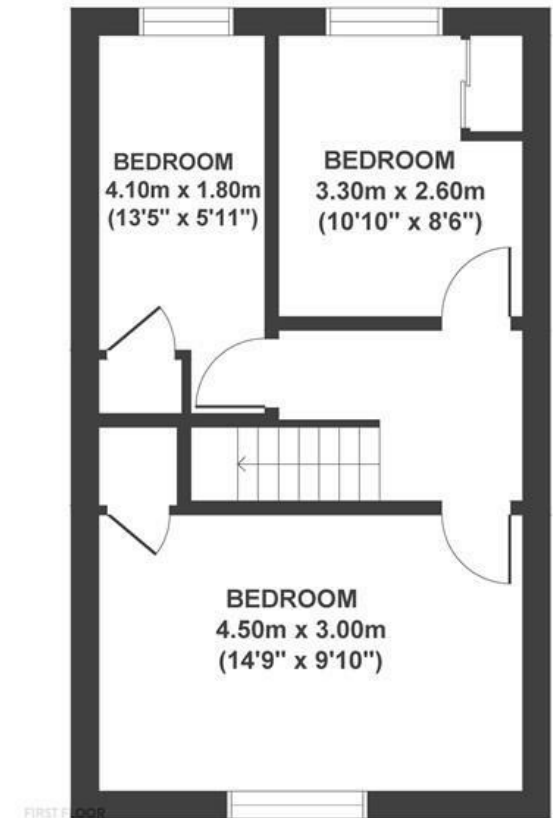

FIRST FLOOR

Boardwalk

# Stafford Road

ST WERBURGH, BRISTOL



£375,000



3 Bedrooms



BS2 9UN



1 Bathrooms

*"We've loved living here on Stafford Road - right in the heart of St Werburghs, surrounded by colourful houses and community spirit, and just a short stroll to the shops on Mina Road and the city farm. This home has offered us a calm and comforting space, the perfect spot to enjoy everything this unique area has to offer."*

