



Jordan fishwick

Brookbottom Road High Peak New Mills



Brookbottom Road High Peak New Mills SK22 3DY

£600,000



The Property

Noon Sun Coach House is an exceptional three-bedroom detached bungalow set within private manageable grounds and enjoying far-reaching countryside views. Offering versatile accommodation throughout, this beautifully presented home combines peaceful rural living with modern open-plan design. At the heart of the property is a bright and welcoming open-plan kitchen and dining area, thoughtfully designed for both everyday living and entertaining. French doors open directly onto the patio, creating a seamless connection to the outdoor space and allowing natural light to flood the interior while framing the stunning surrounding views. The master bedroom benefits from a private en-suite shower room, while two further well-proportioned bedrooms provide flexible accommodation for family, guests, or home working. A contemporary family bathroom serves the remaining bedrooms. Externally, Noon Sun Coach House is approached through private gates offering a sense of seclusion and tranquillity. The patio area provides the perfect setting for outdoor dining and relaxation, all while enjoying the elevated outlook across the surrounding landscape. A rare opportunity to acquire a charming bungalow in an idyllic setting, Noon Sun Coach House offers privacy, comfort, and picturesque living in equal measure.

Additionally, there are Four and a half acres of grazing land available by separate negotiation.



- Beautifully Finished Detached Bungalow
- Spectacular Scenic Views over New Mills and Disley
- Three Generous Bedrooms
- Open Plan Living Dining Kitchen
- Two Bathrooms
- Multi-Fuel Burner
- Semi Rural Location
- Off Road Parking
- 4.89 Acres available by Separate Negotiation
- Convenient For New Mills Amenities

Postcode SK22 3DY

EPC Rating E

Local Authority High Peak

Council Tax E

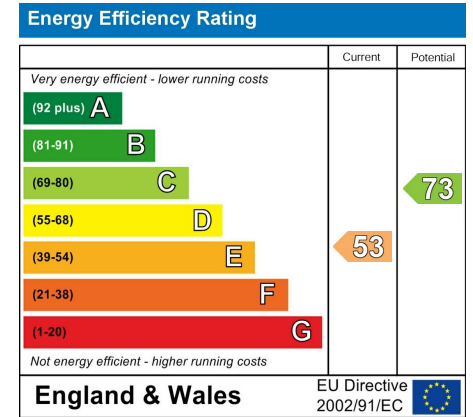

GROUND FLOOR

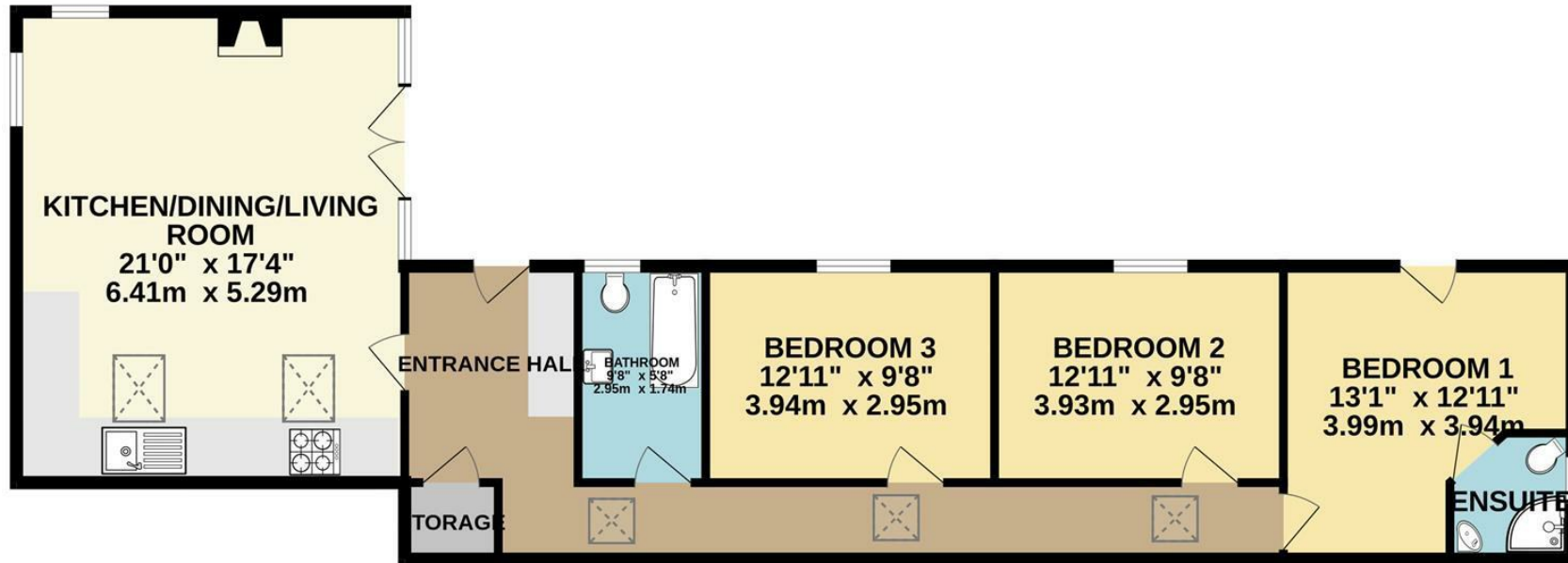

Whilst every attempt has been made to ensure the accuracy of the floorplan contained here, measurements of doors, windows, rooms and any other items are approximate and no responsibility is taken for any error, omission or mis-statement. This plan is for illustrative purposes only and should be used as such by any prospective purchaser. The services, systems and appliances shown have not been tested and no guarantee as to their operability or efficiency can be given.
Made with Metropix ©2026



These particulars are believed to be accurate but they are not guaranteed and do not form a contract. Neither Jordan Fishwick nor the vendor or lessor accept any responsibility in respect of these particulars, which are not intended to be statements or representations of fact and any intending purchaser or lessee must satisfy himself by inspection or otherwise as to the correctness of each of the statements contained in these particulars. Any floorplans on this brochure are for illustrative purposes only and are not necessarily to scale.

Offices at: Chorlton, Didsbury, Disley, Hale, Glossop, Macclesfield, Manchester Deansgate, Manchester Whitworth Street, New Mills, Sale, Wilmslow and Withington

14 Market St, Disley, Cheshire, Stockport SK12 2AA

01663 767878

disley@jordanfishwick.co.uk

www.jordanfishwick.co.uk