

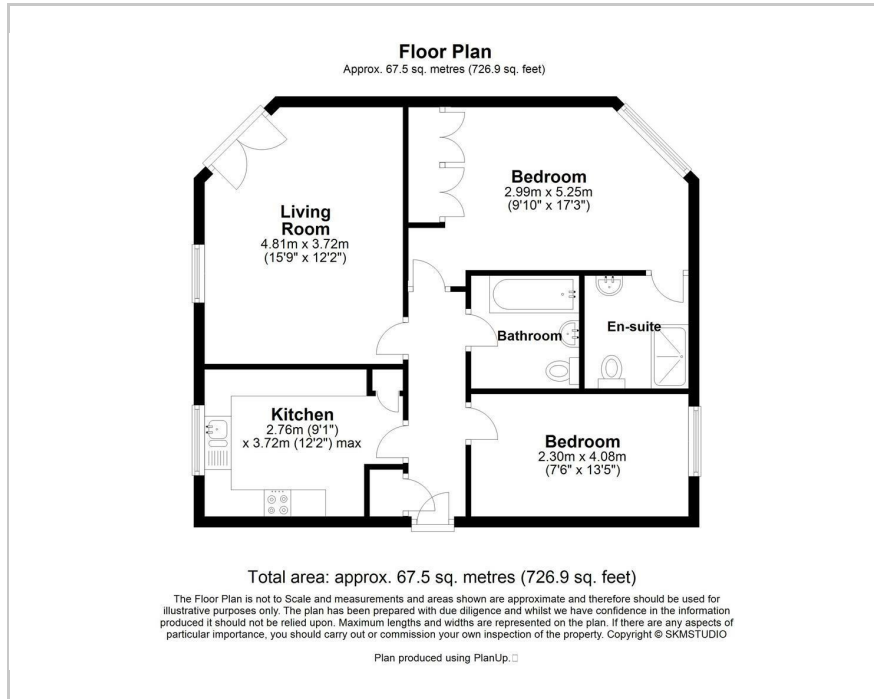

Revels Court 40A Grove Crescent, Croxley Green, WD3 3FR  
Price Guide £375,000



## Floor Plan



## Area Map

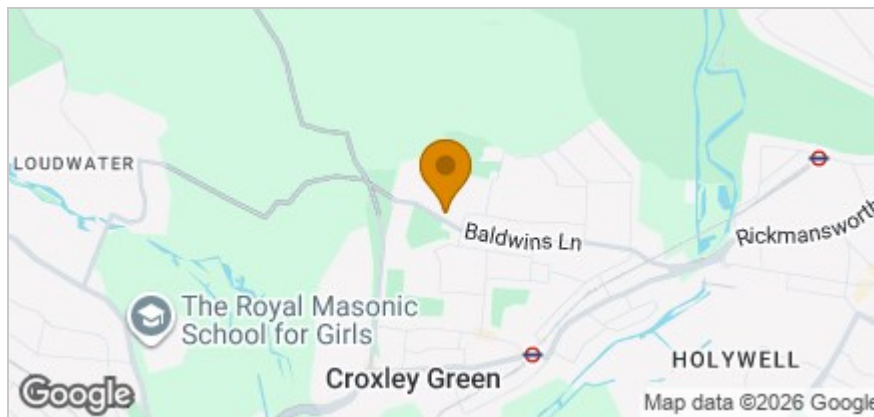

## Accommodation

- Purpose built lease hold ground floor maisonette
- 2 Beds master with en-suite
- Good size lounge with patio doors leading to small patio area
- Modern kitchen and bathroom
- Very quiet location with off street parking
- Walking distance to Met Line Station
- NO UPPER CHAIN 110 Years remaining on lease

## Viewing

Please contact our Grosvenor Estate Agents Ltd Office on 01923 711651 if you wish to arrange a viewing appointment for this property or require further information.

## Energy Efficiency Graph

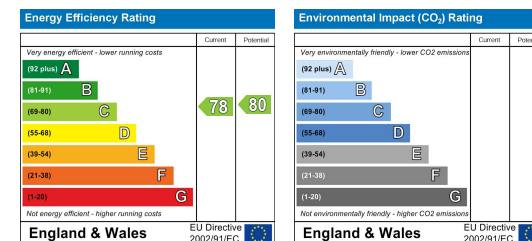

These particulars, whilst believed to be accurate are set out as a general outline only for guidance and do not constitute any part of an offer or contract. Intending purchasers should not rely on them as statements of representation of fact, but must satisfy themselves by inspection or otherwise as to their accuracy. No person in this firm's employment has the authority to make or give any representation or warranty in respect of the property.