

bear

Estate Agents



Three bedroom terraced family home to let offering spacious living accommodation and a generous rear garden that boasts an outbuilding. Well-appointed close to excellent amenities and convenient travel links.

- Terraced Family Home
- Open Plan Kitchen/Diner
- Ground Floor WC
- Three Piece Bathroom
- Double Glazing
- Spacious Lounge
- Utility Room
- Three Bedrooms
- Generous Garden with a Summerhouse
- Gas Central Heating

Oban Road

Southend-on-Sea

£1,550 Per Month



Oban Road



Bear Lettings are proud to market this three bedroom terraced home to let in Southend-on-Sea. The property is situated within minutes of ideal amenities, with the popular seafront being close to hand. There are convenient bus connections within walking distance, whilst Southend East Train Station provides direct access to London on the C2C line. Also within the area, you will find well-regarded schools and excellent grammar schools.

This family home offers a good sized lounge, an open plan kitchen/diner, a utility room and a WC on the ground floor. Upstairs, you will find three well-proportioned bedrooms and a three piece bathroom. To the rear, there is a good-sized garden that houses a large summerhouse.

Frontage

Entrance Hall

Lounge
14'2 x 11'0

Kitchen/Dining Room
16'6 x 10'11

Utility Room
5'6 x 4'6

W/C

First Floor Landing

Bedroom One
10'10 x 10'9

Bedroom Two
11'7 x 8'5

Bedroom Two
7'10 x 7'8

Bathroom
6'2 x 5'8

Garden

Outbuilding



Floor Plan

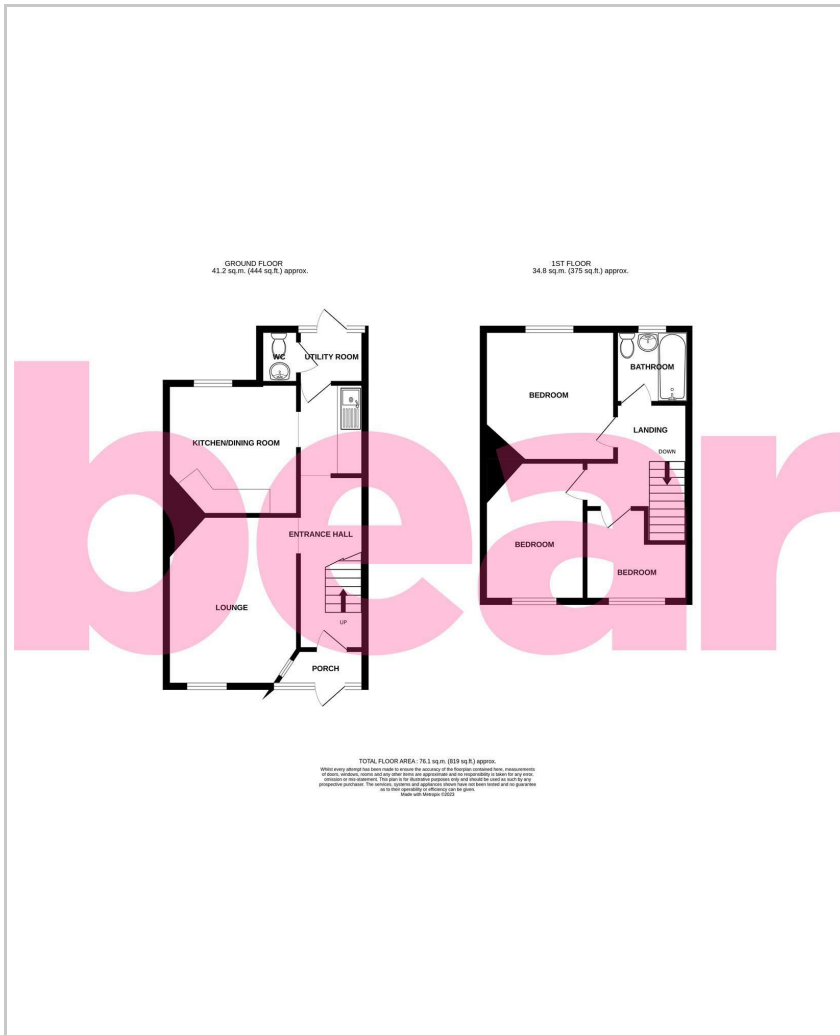

Area Map

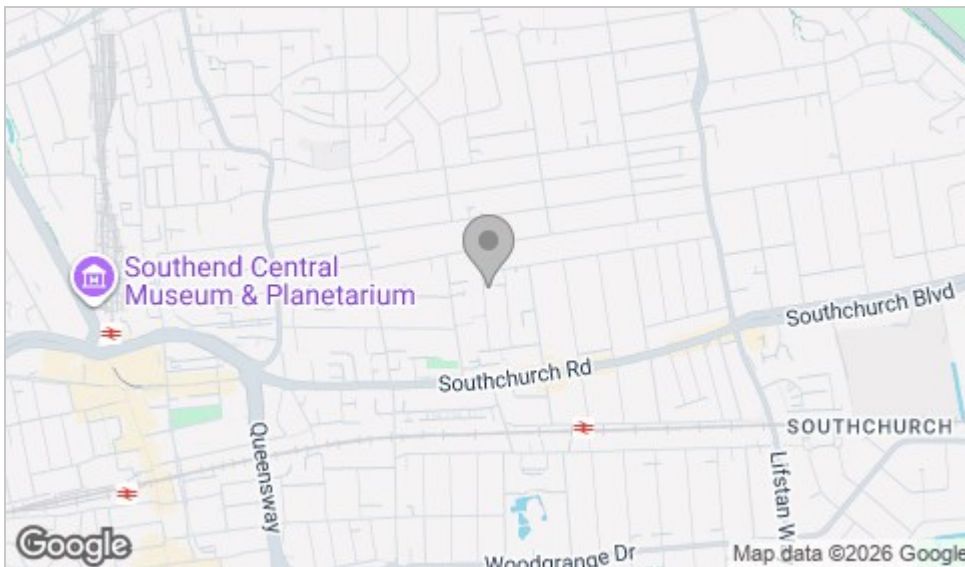

Viewing

Please contact our Westcliff-on-Sea Office on 01702 899 780 if you wish to arrange a viewing appointment for this property or require further information.

These particulars, whilst believed to be accurate are set out as a general outline only for guidance and do not constitute any part of an offer or contract. Intending purchasers should not rely on them as statements of representation of fact, but must satisfy themselves by inspection or otherwise as to their accuracy. No person in this firm's employment has the authority to make or give any representation or warranty in respect of the property.

797 London Road, Westcliff-on-Sea, Essex, SS0 9SY

Office: 01702 899 780 info@bearlettings.co.uk

Energy Efficiency Graph

