



£1,800 pcm  
Royal Engineers Way, Mill Hill



1

Bedroom



1

Bathroom

211 Edgware Rd, London, NW9 6LP |  
[colindale@warrenbradleyestates.co.uk](mailto:colindale@warrenbradleyestates.co.uk)

020 8200 7007





£1,800 pcm  
Royal Engineers Way, Mill Hill



We are pleased to offer for rent this spacious 1 bedroom apartment situated on the raised ground floor within the popular Millbrook Park Development. The property benefits from a large lounge with a Juliette balcony, open plan high specification kitchen with integrated appliances. A spacious bedroom with fitted wardrobes, a fully tiled bathroom, real wood flooring and underfloor heating.

This apartment also comes with the added benefit of an allocated parking space within the secure car park.

Residents of the Millbrook Park Development benefit from being ideally located close to Mill Hill East underground station (Northern Line) as well as the various shops and supermarkets including Waitrose. There is also a gym close by and many parks and green spaces.

Offered fully furnished the property is available now.



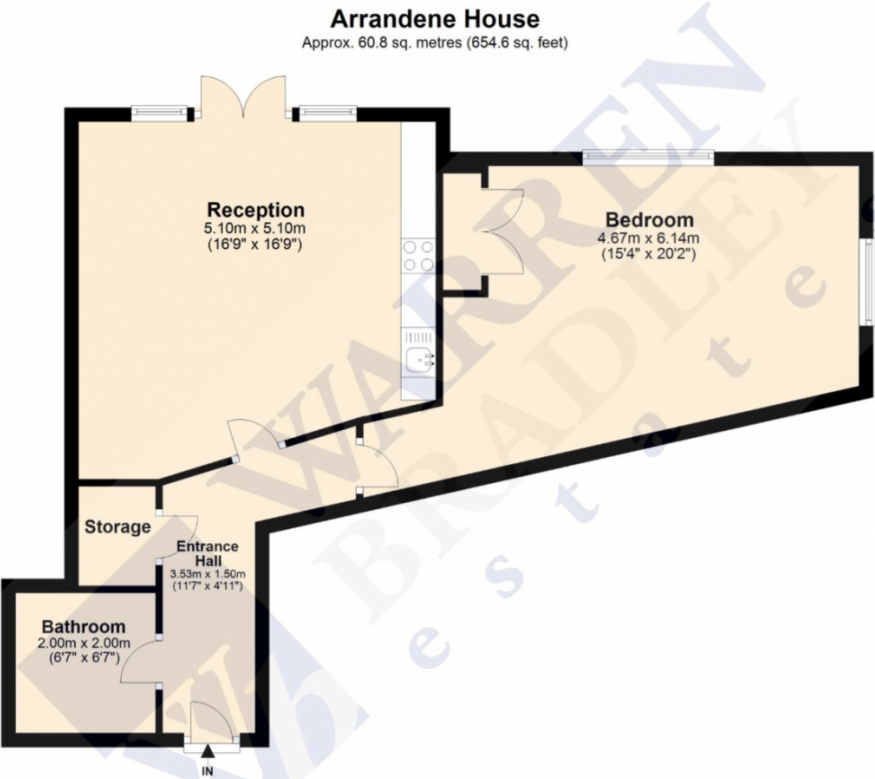

Total area: approx. 60.8 sq. metres (654.6 sq. feet)

Disclaimer: Please note this floor plan is for marketing purposes and is to be used as a guide only.  
Plan produced using PlanUp.

Score	Energy rating	Current	Potential
92+	A		
81-91	B	85   B	85   B
69-80	C		
55-68	D		
39-54	E		
21-38	F		
1-20	G		

The graph shows this property's current and potential energy efficiency.

Properties are given a rating from A (most efficient) to G (least efficient).

Properties are also given a score. The higher the number the lower your fuel bills are likely to be.

