



 paulwallace

King Arthur Court, Cheshunt, EN8 8EH |
£199,995 | Leasehold

King Arthur Court, Cheshunt, EN8 8EH

SITUATED WITHIN WALKING DISTANCE OF THE TRAIN STATION & TOWN CENTRE WITH VIEWS OVER GRUNDY PARK FIRST FLOOR one bedroom flat, ATTRACTIVE KITCHEN AND BATHROOM both with windows, security system, BRIGHT RECEPTION ROOM, electric storage heating and 90 YEAR LEASE.

Key features

- One Bedroom
- Close To Train Station
- Attractive Kitchen
- Attractive Bathroom
- Lounge
- Views Over Grundy Park
- No Chain
- First Floor Flat

Property Information

Tenure

Leasehold

Council Tax

C

EPC Rating

C

Local Authority

Broxbourne Borough Council

Lease Length

90 years

Service Charge & Ground Rent

£907 per year - £285 per year



Paul Wallace Estate Agents
Brookfield Centre
Cheshunt
Hertfordshire
EN8 0NN

01992 781100

cheshunt@paulwallace.co.uk

www.paulwallace.co.uk

Opening Times

Mon - Fri	9 am to 6:30 pm
Sat	9 am to 5:30 pm
Sun	Closed
Bank Hols	Closed

paulwallace
estate agents

Cheshunts leading estate agent.
Please get in touch for your free
property valuation.







FIRST FLOOR
493 sq.ft. (45.8 sq.m.) approx.

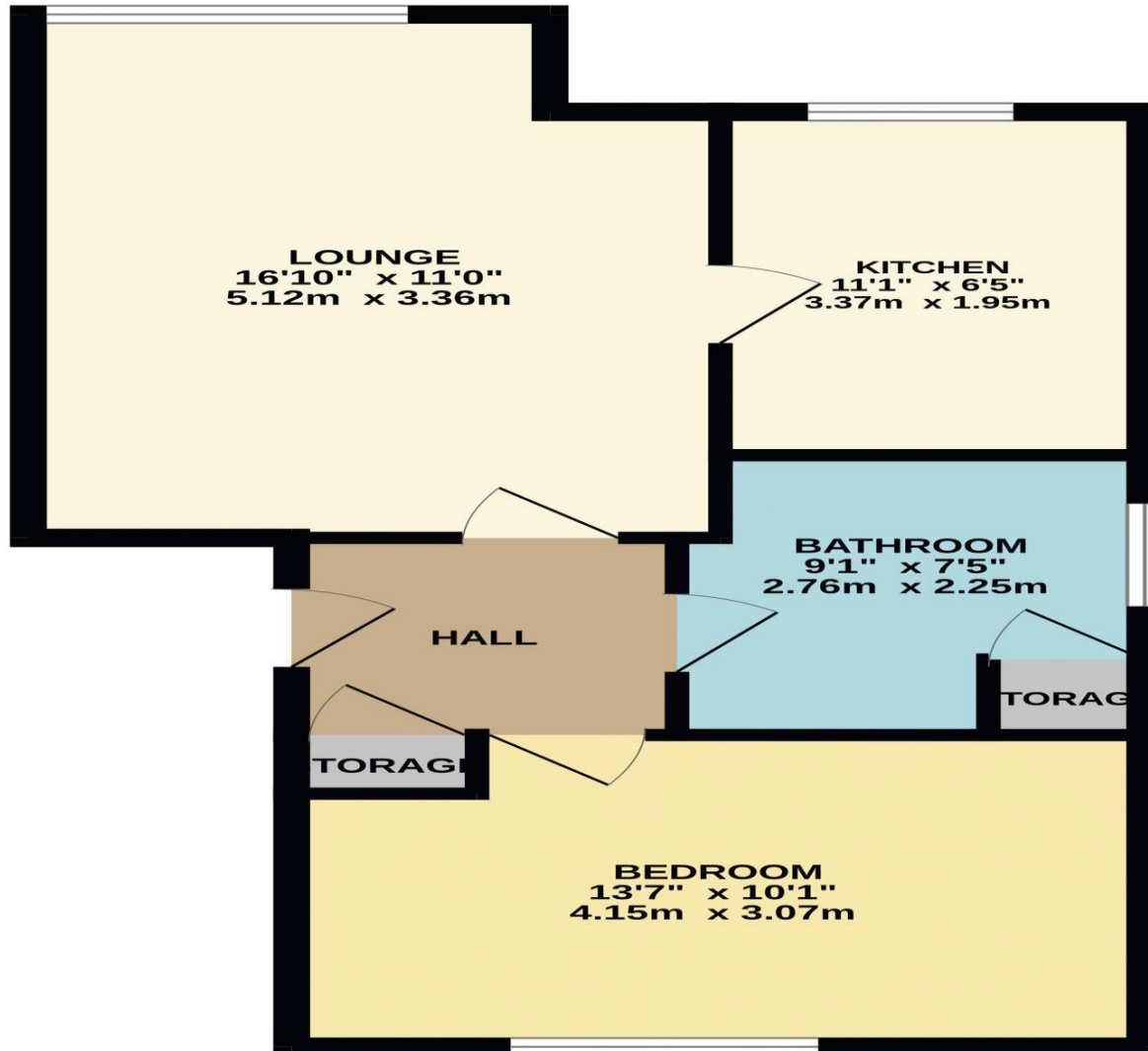

TOTAL FLOOR AREA : 493 sq.ft. (45.8 sq.m.) approx.

Whilst every attempt has been made to ensure the accuracy of the floorplan contained here, measurements of doors, windows, rooms and any other items are approximate and no responsibility is taken for any error, omission or mis-statement. This plan is for illustrative purposes only and should be used as such by any prospective purchaser. The services, systems and appliances shown have not been tested and no guarantee as to their operability or efficiency can be given.
Made with Metropix ©2026